

THE FAST  
AND THE FURIOUS

ファースト アンド フュリアス

**DRIIFT**

# OPERATORS MANUAL



- Failure to properly operate this machine could result in malfunction or accident, so please read this manual carefully before commencing operation. Be sure to operate the machine as described in this manual.
- Keep this manual available and ready for use when necessary
- If the machine fails to function correctly, immediately turn off the machine and contact contact your local distributor. (60 Day Warranty, from date of purchase.)

The Fast and the Furious Drift - Copyright 2007 - Raw Thrills Inc - All rights reserved

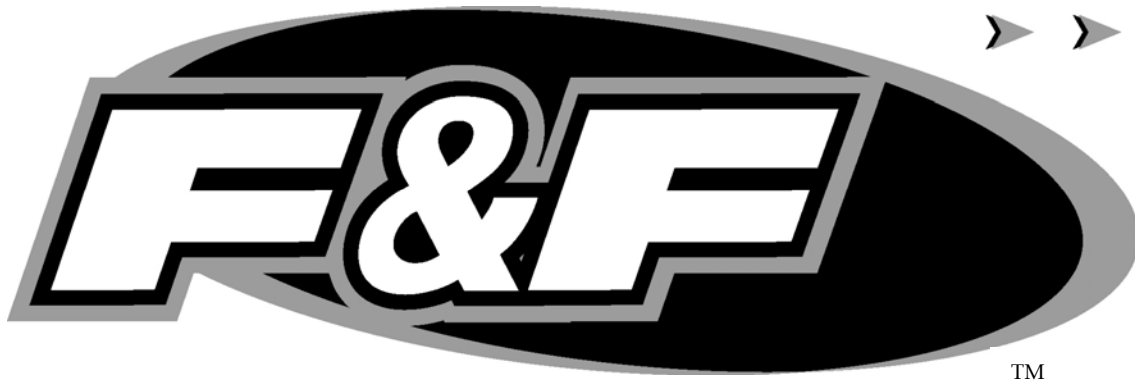

**For Parts or Service contact your local Distributor or:**

**Betson Enterprises  
303 Paterson Plank Road  
Carlstadt, New Jersey**



**Main Phone: (201) 438-1300  
Toll Free Phone: (800) 524-2343  
Part Phone: (800) 828-2048**

**CAUTION:**

- The specifications of this product are subject to change without notice for reasons such as performance.
- The content of this game, its main devices and design are protected under each federal law concerning patent, copyright and other intellectual properties.
- Unauthorized reproduction of this document or any of its contents is strictly forbidden.

## Safety Instructions

Safety instructions apply to operators and service personnel. Read these instructions before preparing the video game machine (VGM) for play. Other safety instructions appear throughout this manual.

### **WARNING: TRANSPORTING THE VIDEO GAME MACHINE (VGM).**

The VGM contains glass and fragile electronic devices. Use appropriate care when transporting . Avoid rough handling when moving the VGM.

### **WARNING: DISCONNECT POWER.**

Always turn the power OFF and unplug the VGM before attempting service or adjustments unless otherwise instructed. Installing or repairing components with the power switched ON can damage the components and void warranty.

### **WARNING: GROUND GAMES.**

Avoid electrical shock! Do not plug in the VGM until you have inspected and properly grounded it. Only plug into a grounded, three-wire outlet. Do not use a "cheater" plug, or cut off the ground pin on the line cord.

### **WARNING: AVOID ELECTRICAL SHOCKS.**

This VGM does not utilize an isolation transformer. Internal cabinet AC is not isolated from the external AC line.

### **WARNING: HANDLE FLOURESCENT TUBE AND CRT WITH CARE.**

If you drop a fluorescent tube or CRT and it breaks, it will implode! Shattered glass can fly eight feet or more from the implosion.

### **WARNING: CHECK POWER SELECTOR, LAMP.**

Set the 115/230 VAC selector switch on the power supply for the correct line voltage on the installation site. Verify that the fluorescent lamps are rated for the proper line voltage.

### **WARNING: USE PROPER FUSE.**

Avoid electrical shock! Replacement fuses must be identically rated to the original fuse!

### **WARNING: ATTACH CONNECTORS PROPERLY.**

Be sure all connectors mate properly. If connectors do not slip in easily, do not force them. Connectors are often keyed and only connect one way. Check for correct orientation.

### **WARNING: USE EXTREME CARE WHEN HANDLING PC.**

The PC contains sensitive components such as a hard drive. Do not handle roughly. Call your distributor before servicing PC internal components. Ask about warranty information as it relates to the PC.

**WARNING: HAZARD TO EPILEPTICS.**

A very small portion of the population has a condition which may cause them to experience epileptic seizures or have momentary loss of consciousness when viewing certain kinds of flashing lights or patterns that are present in our daily environment. These persons may experience seizures while watching some kinds of television pictures or playing certain video games. Peoples who have not had any previous seizures may nonetheless have an undetected epileptic condition.

If you or anyone in your family has experienced symptoms linked to an epileptic condition (e.g., seizures or loss of awareness), immediately consult your physician before using any video games.

We recommend that parents observe their children while they play video games. If you or your child experience the following symptoms: dizziness, altered vision, eye or muscle twitching, involuntary movements, loss of awareness, disorientation, or convulsions, **DISCONTINUE USE IMMEDIATELY** and consult your physician.



# **PRODUCT SPECIFICATIONS**

## **OPERATING REQUIREMENTS**

### **ELECTRICAL POWER**

Domestic 120VAC @ 60 Hz, 5 amps  
Foreign 240VAC @ 50Hz, 2.5 amps

### **TEMPERATURE**

32° F to 100°F  
(0°C to 38°C)

### **HUMIDITY**

Not to exceed 95% relative humidity.

### **27 INCH SITDOWN MODEL MAIN CABINET SHIPPING DIMENSIONS**

Height = 83 ¾ INCHES (212.72 cm)  
Depth = 39 inches ( 99.06 cm )  
Width = 37 inches (93.98 cm)

### **27 INCH SITDOWN MODEL MAIN CABINET SHIPPING WEIGHT**

Weight = 495 lbs. (224.53 Kg)

### **27 INCH SEAT SHIPPING DIMENSIONS**

Height = 54 inches (137.16 cm)  
Depth = 23 ¾ inches ( 60.33 cm )  
Width = 35 ½ inches (90.17 cm)

### **27 INCH MODEL SEAT SHIPPING WEIGHT**

Weight = 125 lbs. (57.04Kg)

## **INSPECTION AND INSTALLATION**

**WARNING:** Use extreme care when moving or servicing the game cabinet. Don't plug in the game until you have read this manual.

Please check the following after the game after the game has been removed from its shipping crate and placed in a suitable play or service area.

Make sure that the game cabinet is level. Adjust the casters as needed.

1. Check the AC line cord for any visible signs of damage to the plug or line cord insulation.
2. Check for possible shipping damage to the following:
  - Player interfaces: steering wheel, buttons, keypad and shifter.
  - Seat assembly.
  - Monitor glass.
  - Cabinet backdoor.
  - Cabinet coin door.
  - Cabinet and seat decals.
3. Remove the coin door key from the coin return chute.
4. Open the top coin door and locate the key for the backdoor and the cashbox.
5. Locate hardware kit:
  - tamper proof tool kit
  - crossover network cable
  - line cord
  - seat hardware fasteners (8 sets)
6. Remove the backdoor the backdoor from the cabinet and visually inspect the electronic components.
7. Verify that all connectors are secure and that the bottom of the cabinet is free of loose objects which may have possibly come loose during shipping.

## Seat Assembly Procedure

**WARNING:** The cabinet is top heavy. Install only on level surface. Use the leg levelers to make sure the cabinet and seat are stable. Do not push against plastic parts during movement.

1. Roll the cabinet and seat to the intended location and lower the leg levelers until both are equal height and stable.
2. Reach inside the base of the cabinet remove the bolts to fasten a mounting rail to the cabinet and set aside. Individually pull the rail out, flip it end over end and reinsert it. Fasten the rail to the inside of the cabinet with bolts until finger tight; some movement is required in the mounting rails to align holes with seat pedestal assembly. Repeat for the mounting rail on the other side. See diagram.

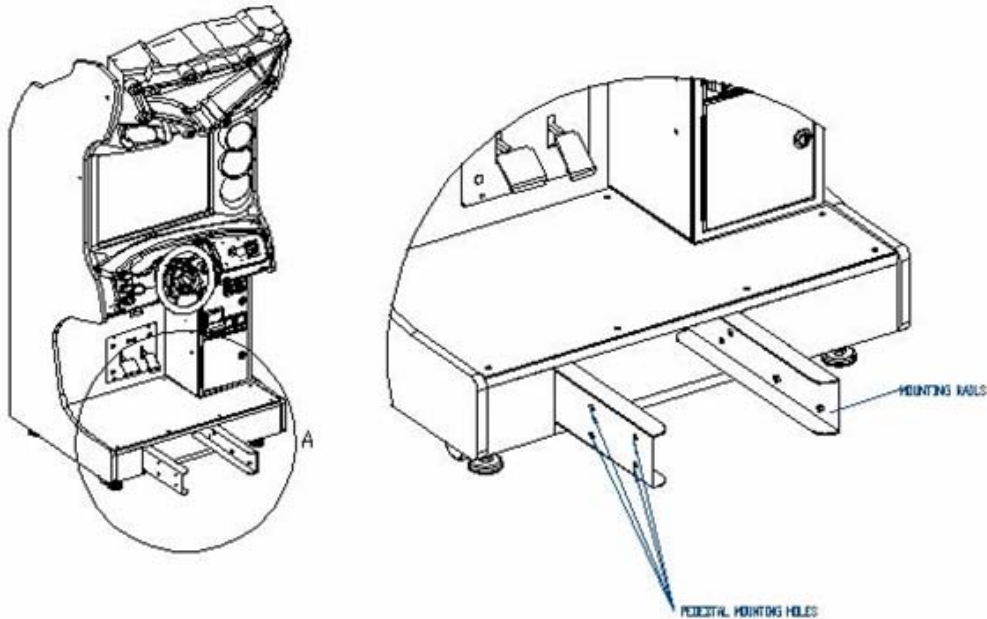

3. Roll the pedestal near the cabinet and align the opening in the pedestal with the ends of the rails. Slide the pedestal forward onto the rails leaving enough space to attach the wiring harness. Mate each cable connector and press firmly to seat the contacts. Ensure no wires are pinched during the pedestal attachment. Fasten in place with the ¼" X 20 tamper resistant screws and large flat washers provided.
4. Tighten the screws firmly with the wrench provided, and then tighten the bolts for the mounting rails.
5. Adjust all levelers until both cabinet and seat are flush and parallel with each other. Inspect for pinched wires before firmly tightening the remaining fasteners to attach the two pieces as one.

## Power Up Procedure

1. Plug the game line cord into an appropriately wired and fused AC receptacle.
2. Locate the game AC main switch to the bottom left side on back of the game cabinet.
3. Turn the switch to the ON position.
4. The game attract feature will begin after the game is finished loading- approximately 1 minute.
5. Proceed to Switch Test of this document and verify proper game operation.

## **Game Networking**

NOTICE: To link the two games together, use the crossover cable provided in the spare parts bag. Use of another cable other than the one shipped with the game could void warranty or cause games not to link. Use network cables which are at least CAT5 grade.

### **Networking Considerations**

Each FNF game comes with a network cable. Optionally, a hub can be installed and located remotely to monitor network activity.

Take care to protect exposed game wiring from general foot traffic around the game. Use a conduit or wire way to protect the cables as needed.

Please mark linking cables for your game if other such cables are in the vicinity to avoid confusion. Network cables are not marked or coded.

Avoid routing the network cables near sources of heat, moisture or electrical energy such as neon lights, compressor motors, transformers etc.

### **Networking Setup**

1. Remove the network cable from the spare parts bag inside the cashbox.
2. Connect each end of the cable to network jack behind each PC.
3. Neatly route the cable through the notch on the back of the cabinet.
4. Use the DIP switch diagram below for enabling link feature and master/slave configuration. The DIP switch is located on the JAMMA I/O board. The JAMMA I/O board is mounted inside the back of the cabinet.

**DIP SWITCH DIAGRAM:**

DIP SW#	SW1	SW2	SW3	SW4	SW5	SW6	SW7	SW8
<b>MASTER</b>	OFF	OFF						ON
<b>SLAVE</b>	ON	OFF						ON

5. Reset both games simultaneously and verify that link is successful. If not, check the DIP switch settings and make sure that the network cable is connected properly and secured. Please refer to the Game Troubleshooting Guide on this manual for more details.



**SETUP AND TEST MENU** VOL (+)

Locate the *Service Button Panel*. The Service Button Panel is made up of two rocker switches. Simply press the side of the switch indicated by the function you want to activate. It is mounted inside the coin door area on top of the cash box vault. Press the **TEST** button to access the **Test Menu**.

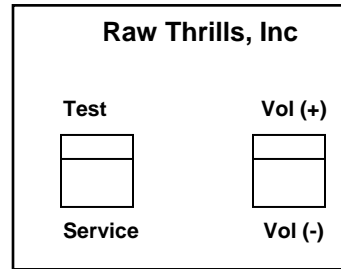

**Menu Navigation:**

Button	Action
Test	Enter Operator Screen
Start Button	Enter/Select Item Sub-Menu
Vol. (+) or View 1 Button	Scroll up thru Menu items
Vol. (-) or View 3 Button	Scroll down thru Menu items
Service or Tunes	Exit to previous Menu

**MAIN MENU**

The **Test Main Menu** appears when the **TEST** button is pressed.

<p><b>Test Main Menu</b></p> <ul style="list-style-type: none"> <li>Diagnostics</li> <li>Game Audits</li> <li>Pricing Adjustments</li> <li>System Adjustments</li> <li>Game Adjustments</li> <li>Utilities</li> <li>Calibration</li> <li>Volume</li> <li>Messages</li> <li>Exit</li> </ul>	<p><b>Version Information</b></p> <p>Version : 1.0                  OS Version: 1.0                  Exe Version: 1.1.4                  Date : March 3, 2007</p> <p>Machine ID: 1                  JUSB Ver.: Debug 7f</p>
<p>Press Volume +/- or View 1/3 to Select                  Press Test or Start to Activate                  Press Service or Tunes to Exit</p>	

## Diagnostics Menu

From the **Main Menu**, select **Diagnostics** and enter to view options.

<p><b>Diagnostics Menu</b></p> <p>Switch Test          DIP Switch Test          Sound Test          Wheel Test          Monitor Test          Lamp Test          Coin Meter Test          Watchdog Test          Link Test          Exit</p>	<p><b>Diagnostics</b></p>
<p>Press Volume +/- or View 1/3 to Select          Press Test or Start to Activate          Press Service or Tunes to Exit</p>	

## Switch Test

From the **Diagnostics** select and enter **Switch Test**. Verify proper switch input function using this menu. Each switch activated will be indicated on the test screen in corresponding yellow box and will be accompanied by a switch active sound indicator. Verify pot value for min, center and max are correct. If not, proceed to Calibration section of this manual. Press and hold the **Service Button** for three seconds to return to the **Diagnostics Menu**.

<b>SWITCH TEST</b>																																			
<table border="1" style="width: 100%; border-collapse: collapse;"> <tr> <th colspan="3" style="text-align: left; padding: 5px;"><u>Wheel /Pedal Info</u></th> </tr> <tr> <th style="text-align: left; padding: 5px;">Input Device</th> <th style="text-align: left; padding: 5px;">Pot Value</th> <th style="text-align: left; padding: 5px;">Min Center Max</th> </tr> <tr> <td style="padding: 5px;">Wheel</td> <td style="padding: 5px;"><input style="width: 100%;" type="text"/></td> <td style="padding: 5px;"></td> </tr> <tr> <td style="padding: 5px;">Gas</td> <td style="padding: 5px;"><input style="width: 100%;" type="text"/></td> <td style="padding: 5px;"></td> </tr> <tr> <td style="padding: 5px;">Brake</td> <td style="padding: 5px;"><input style="width: 100%;" type="text"/></td> <td style="padding: 5px;"></td> </tr> </table>			<u>Wheel /Pedal Info</u>			Input Device	Pot Value	Min Center Max	Wheel	<input style="width: 100%;" type="text"/>		Gas	<input style="width: 100%;" type="text"/>		Brake	<input style="width: 100%;" type="text"/>																			
<u>Wheel /Pedal Info</u>																																			
Input Device	Pot Value	Min Center Max																																	
Wheel	<input style="width: 100%;" type="text"/>																																		
Gas	<input style="width: 100%;" type="text"/>																																		
Brake	<input style="width: 100%;" type="text"/>																																		
<table border="1" style="width: 100%; border-collapse: collapse;"> <tr> <th colspan="2" style="text-align: left; padding: 5px;"><u>Button Info</u></th> </tr> <tr> <td style="padding: 5px;">1</td> <td rowspan="10" style="width: 50px; text-align: center;"><input style="width: 100%; height: 100%;" type="text"/></td> </tr> <tr><td style="padding: 5px;">2</td></tr> <tr><td style="padding: 5px;">3</td></tr> <tr><td style="padding: 5px;">Tunes</td></tr> <tr><td style="padding: 5px;">Start</td></tr> <tr><td style="padding: 5px;">Handbrake</td></tr> <tr><td style="padding: 5px;">Coin 1</td></tr> <tr><td style="padding: 5px;">Coin 2</td></tr> <tr><td style="padding: 5px;">Bill</td></tr> </table>	<u>Button Info</u>		1	<input style="width: 100%; height: 100%;" type="text"/>	2	3	Tunes	Start	Handbrake	Coin 1	Coin 2	Bill	<table border="1" style="width: 100%; border-collapse: collapse;"> <tr> <th colspan="2" style="text-align: left; padding: 5px;"><u>Shift Info</u></th> </tr> <tr> <td style="padding: 5px;">One</td> <td style="padding: 5px;">Three</td> </tr> <tr> <td style="padding: 5px;">Two</td> <td style="padding: 5px;">Four</td> </tr> </table>	<u>Shift Info</u>		One	Three	Two	Four	<table border="1" style="width: 100%; border-collapse: collapse;"> <tr> <th colspan="3" style="text-align: left; padding: 5px;"><u>Keypad Info</u></th> </tr> <tr> <td style="padding: 5px;">1</td> <td style="padding: 5px;">2</td> <td style="padding: 5px;">3</td> </tr> <tr> <td style="padding: 5px;">4</td> <td style="padding: 5px;">5</td> <td style="padding: 5px;">6</td> </tr> <tr> <td style="padding: 5px;">7</td> <td style="padding: 5px;">8</td> <td style="padding: 5px;">9</td> </tr> <tr> <td style="padding: 5px;">*</td> <td style="padding: 5px;">0</td> <td style="padding: 5px;">#</td> </tr> </table>	<u>Keypad Info</u>			1	2	3	4	5	6	7	8	9	*	0	#
<u>Button Info</u>																																			
1	<input style="width: 100%; height: 100%;" type="text"/>																																		
2																																			
3																																			
Tunes																																			
Start																																			
Handbrake																																			
Coin 1																																			
Coin 2																																			
Bill																																			
<u>Shift Info</u>																																			
One	Three																																		
Two	Four																																		
<u>Keypad Info</u>																																			
1	2	3																																	
4	5	6																																	
7	8	9																																	
*	0	#																																	
<table border="1" style="width: 100%; border-collapse: collapse;"> <tr> <th colspan="2" style="text-align: left; padding: 5px;"><u>TVVS Info</u></th> </tr> <tr> <td style="padding: 5px;">Service Credit</td> <td style="padding: 5px;"></td> </tr> <tr> <td style="padding: 5px;">Vol+</td> <td style="padding: 5px;"></td> </tr> <tr> <td style="padding: 5px;">Vol-</td> <td style="padding: 5px;"></td> </tr> <tr> <td style="padding: 5px;">Test</td> <td style="padding: 5px;"></td> </tr> </table>	<u>TVVS Info</u>		Service Credit		Vol+		Vol-		Test		<table border="1" style="width: 100%; border-collapse: collapse;"> <tr> <th colspan="2" style="text-align: left; padding: 5px;"><u>Software Info</u></th> </tr> <tr> <td style="padding: 5px;">Date: July 28, 2004</td> <td style="padding: 5px;"></td> </tr> <tr> <td style="padding: 5px;">Time: 15.03:29</td> <td style="padding: 5px;"></td> </tr> <tr> <td style="padding: 5px;">Ver: 1.0</td> <td style="padding: 5px;"></td> </tr> <tr> <td style="padding: 5px;">ID: 4</td> <td style="padding: 5px;"></td> </tr> <tr> <td style="padding: 5px;">DIP SW: 1 2 3 4 5 6 7 8</td> <td style="padding: 5px;"></td> </tr> <tr> <td style="padding: 5px;">VALUE: 1 1 00000001</td> <td style="padding: 5px;"></td> </tr> </table>		<u>Software Info</u>		Date: July 28, 2004		Time: 15.03:29		Ver: 1.0		ID: 4		DIP SW: 1 2 3 4 5 6 7 8		VALUE: 1 1 00000001										
<u>TVVS Info</u>																																			
Service Credit																																			
Vol+																																			
Vol-																																			
Test																																			
<u>Software Info</u>																																			
Date: July 28, 2004																																			
Time: 15.03:29																																			
Ver: 1.0																																			
ID: 4																																			
DIP SW: 1 2 3 4 5 6 7 8																																			
VALUE: 1 1 00000001																																			

## **DIP Switch Test**

From the ***Diagnostics Menu*** select and enter **DIP Switch Test**. Verify correct DIP switch settings. Please refer to Appendix n. Press the Tunes Button to return to ***Diagnostics Menu***.

DIP SWITCH VALUES		
VALUE	STATE	SWITCH
ON		8 - NET ENABLED
ON		7 -ANALOG BRAKE
ON		6
ON		5
ON		4
ON		3 -
ON		2 -  MACHINE ID 1-8
ON		1 -

## **Sound Test**

From the ***Diagnostics Menu*** select and enter **Sound Test**. Verify that marquee, cabinet and seat sound volume and quality are good. Press the Tunes Button to return to ***Diagnostics Menu***

<p><b>Sound Test Menu</b></p> <p>Change Music Change Effect</p> <p>Play 100Hz Test Play 1000Hz Test</p> <p>Set Pan Center Set Pan Left Set Pan Right</p> <p><b>Exit</b></p>	<p><b>Sound Test</b></p> <p>Current Music Track:</p> <p>Current Sound Effect:</p>	<p><b>Note:</b> Use Pan functions to test left/right speakers separately.</p> <p>Use 100-1Khz test to verify subwoofer sound quality.</p> <p>Go to Volume section to adjust sound level.</p>
<p>Press Volume +/- or View 1/3 to Select Press Test or Start to Activate Press Service or Tunes to Exit</p>		

## Wheel Test

Caution: Begin by placing the wheel at center position. The steering wheel moves automatically during the wheel test. Stay clear of the wheel!

From the **Diagnostics Menu** select and enter **Wheel Test**. Verify proper wheel force feedback function using this menu. Follow the screen instruction carefully.

**Wheel Test**

- Hit Test/Start To Begin
- Turning Wheel Left
- Hit Start/Test To Coninue
- Turning Wheel Right
- Hit Test /Start To Exit

## Monitor Test

From the **Audio/Video Options** menu, select and enter **Color Bars & Purity**. Verify correct color and purity for Red, Blue and Green screens. Use the convergence screen to also verify linearity. See Appendix n.

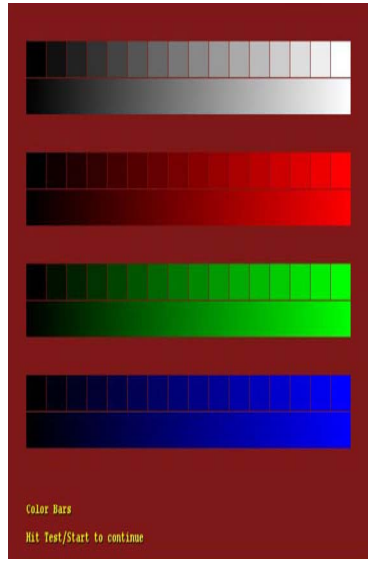
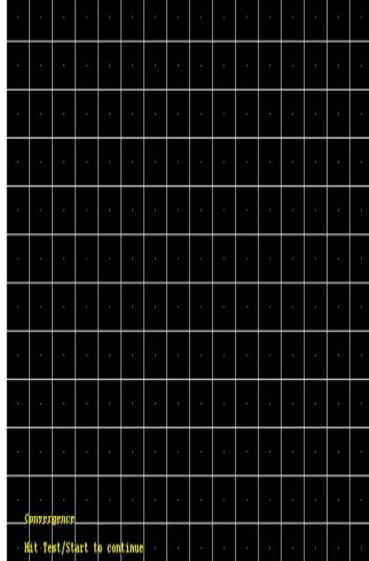
 <p>Color Bar</p>	<ul style="list-style-type: none"> <li>• White Screen</li> <li>• Red Screen</li> <li>• Green Screen</li> <li>• Blue Screen</li> </ul> <p>Purity Screen</p>	 <p>Convergence</p>
--	--	--

### **Lamp Test**

From the ***Diagnostics Menu*** select and enter ***Lamp Test***. Use View1 or View 3 to select the lamp and press Start to activate that lamp. Verify that ALL lamps are working.

<p><b>Lamp Test Menu</b></p> <p>ALL Lamps ON ALL Lamps OFF 1 Lamp ON 2 Lamp ON 3 Lamp ON Tunes Lamp ON Start Lamp ON</p> <p>Exit</p>	<p><b>Lamp Test</b></p>
<p>Press Volume +/- or View 1/3 to Select Press Test or Start to Activate Press Service or Tunes to Exit</p>	

**Note:**

Lamp function could also be verified using Switch Test.

Please check the coin door lamps as part of your game diagnostic check.

### **Coin Meter Test**

From the ***Diagnostics Menu*** select and enter ***Coin Meter Test***. Advance the meter once using by pressing Start. Press the Tunes Button to return to ***Diagnostics Menu***.

**Hit Test/Start to advance coin meter.**

Press Service or Tunes to Exit

## **Watchdog Test**

From the ***Diagnostics Menu*** select and enter ***Watchdog Test***. The game will reset in approximately 6 seconds. The watchdog feature allows the PC to monitor normal game software and hardware operation.



## **Game Audits**

From the ***Main Menu***, select ***Game Audits*** and enter to view options.

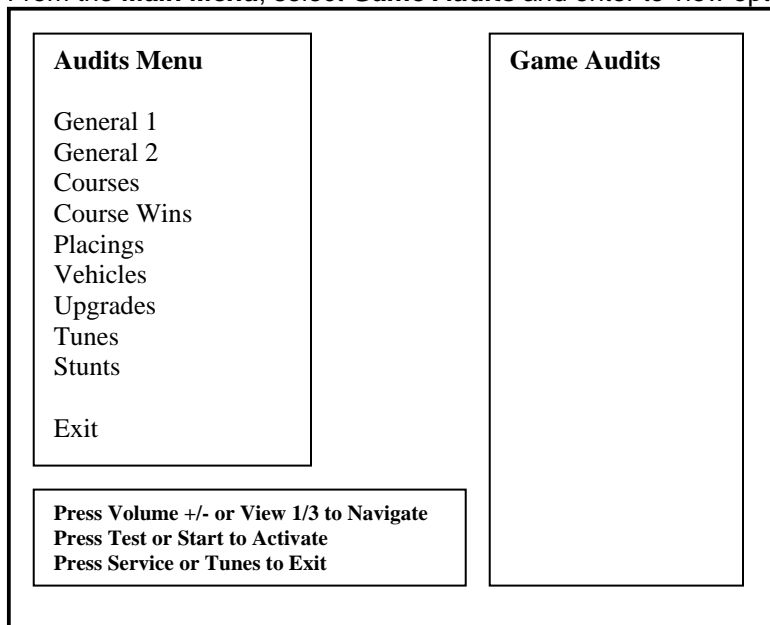

### **Note:**

- Use game audit screens to assess game performance.
- Use information to determine options such as game difficulty and free game award to maximize game earnings.
- Use information to detect possible intermittent problems.

## **General 1 Audits**

From the ***Audits Menu***, select ***General 1*** and enter to view general game statistics. Press the Tunes Button to return to ***Main Menu***.

<p><b>Audits Menu</b></p> <p><b><u>General 1</u></b>          General 2          Courses          Course Wins          Placings          Vehicles          Upgrades          Tunes          Stunts</p> <p>Exit</p>	<p><b>General Audits</b></p> <p>Time Game On          Time Game Played          Average Time Per Game</p> <p>Games Played          Games Started          Game Continued          Game Timed Out          Free Games          PIN Games          Link Games</p> <p>Boot Ups          Test Mode Entries          Unfinished Games</p>
<p>Press Volume +/- or View 1/3 to Navigate          Press Test or Start to Activate</p>	

## **General 2 Audits**

From the ***Audits Menu***, select ***General 2*** and enter to view additional general game statistics. Press the Tunes Button to return to ***Main Menu***.

<p><b>Audits Menu</b></p> <p>General 1  <b><u>General 2</u></b>          Courses          Course Wins          Placings          Vehicles          Upgrades          Tunes          Stunts</p> <p>Exit</p>	<p><b>General Audits</b></p> <p>Auto Games          Manual Games</p> <p>1<sup>st</sup> Person Cam Game          Behind Cam Game          Behind Cam High Game</p> <p>Coindrops          Coindrops Slot 0 Left          Coindrops Slot 1 Right          Coindrops Slot 2 DBV</p> <p>Current Credits          Current Coins</p>
<p>Press Volume +/- or View 1/3 to Navigate          Press Test or Start to Select          Press Service or Tunes to Exit</p>	

## **Course Audits**

From the ***Audits Menu***, select ***Courses*** and enter to view individual information on each course. View how many times each course is selected, as well as its popularity by overall percentage. Press the Tunes Button to return to ***Main Menu***.

<p><b>Audits Menu</b></p> <p>General 1 General 2 <b><u>Courses</u></b> Course Wins Placings Vehicles Upgrades Tunes Stunts</p> <p>Exit</p>	<p><b>Course Selects/Percentage</b></p> <p>Time Square Mojave Chinatown Malibu Central Park LA Ghetto Shibuya Sado Shijuku Tour Bonus Kyoto Takayama Nagano San Francisco New England Hollywood SF Tour Chinatown EX Mulholland Drive</p> <p>Tour Entries</p>
<p>Press Volume +/- or View 1/3 to Navigate Press Test or Start to Slect Press Service or Tunes to Exit</p>	

## **Course Wins Audit**

From the ***Audits Menu***, select ***Courses Wins*** and enter to view individual win and overall percentage information on each course. Press the Tunes Button to return to ***Main Menu***.

<p><b>Audits Menu</b></p> <p>General 1 General 2 Courses <b><u>Course Wins</u></b> Placings Vehicles Upgrades Tunes Stunts</p> <p>Exit</p>	<p><b>Course Wins/Percentage</b></p> <p>Time Square Mojave Chinatown Malibu Central Park LA Ghetto Shibuya Sado Shijuku Tour Bonus Kyoto Takayama Nagano San Francisco New England Hollywood SF Tour Chinatown EX Mulholland Drive</p>
<p>Press Volume +/- or View 1/3 to Navigate Press Test or Start to Select Press Service or Tunes to Exit</p>	



## **Placings Audit**

From the ***Audits Menu***, select ***Placings*** and enter to view individual count for each standing and percentage information. Use this information to determine game difficulty adjustments to properly reward players and maximize game earning performance. Press the Tunes Button to return to ***Main Menu***.

<p><b>Audits Menu</b></p> <p>General 1 General 2 Courses Course Wins <b><u>Placings</u></b> Vehicles Upgrades Tunes Stunts</p> <p>Exit</p>	<p><b>Placings/Percentage</b></p> <p>1<sup>st</sup> Place 2<sup>nd</sup> Place 3<sup>rd</sup> Place 4<sup>th</sup> Place 5<sup>th</sup> Place 6<sup>th</sup> Place 7<sup>th</sup> Place 8<sup>th</sup> Place</p> <p>Avg. Place:</p> <p>Max Win Streak: Max Lose Streak: Cur Win Streak: Cur Lose Streak:</p>
<p>Press Volume +/- or View 1/3 to Navigate Press Test or Start to Select Press Service or Tunes to Exit</p>	

## **Vehicles Audit**

From the ***Audits Menu***, select ***Vehicles*** and enter to view individual count for each vehicle selection and percentage information. Press the Tunes Button to return to ***Main Menu***.

<p><b>Audits Menu</b></p> <p>General 1 General 2 Courses Course Wins Placings <b><u>Vehicles</u></b> Upgrades Tunes Stunts</p> <p>Exit</p>	<p><b>Vehicle Selects/Percentage</b></p> <p>Mustang GT Challenger Solstice GXP RX-7 GT 350Z S7 Twin Turbo Skyline GTR R34 Viper SRT10 RX-8 Camaro Mustang Fastback</p>
<p>Press Volume +/- or View 1/3 to Navigate Press Test or Start to Select Press Service or Tunes to Exit</p>	

## Upgrade Audit

From the **Audits Menu**, select **Upgrades** and enter to view individual count for each vehicle feature upgrade selection and percentage information. Press the Tunes Button to return to **Main Menu**.

<p><b>Audits Menu</b></p> <p>General 1 General 2 Courses Course Wins Placings Vehicles <b>Upgrades</b> Tunes Stunts</p> <p>Exit</p>	<p><b>Upgrades/Percentage</b></p> <p>Decal Tires Nitro Neon Body Engine</p> <p>Upgrade Users Upgrade Buy-ins Upgrade Credits</p> <table border="1"> <thead> <tr> <th>#Visits</th> <th>Count</th> <th>Percent</th> </tr> </thead> <tbody> <tr> <td>1 visit</td> <td>40</td> <td>40%</td> </tr> <tr> <td>:</td> <td></td> <td></td> </tr> <tr> <td>70-99 visits</td> <td>40</td> <td>40%</td> </tr> <tr> <td>100+ visits</td> <td>20</td> <td>20%</td> </tr> </tbody> </table>	#Visits	Count	Percent	1 visit	40	40%	:			70-99 visits	40	40%	100+ visits	20	20%
#Visits	Count	Percent														
1 visit	40	40%														
:																
70-99 visits	40	40%														
100+ visits	20	20%														
<p>Press Volume +/- or View 1/3 to Navigate Press Test or Start to Select Press Service or Tunes to Exit</p>																

## Tunes Audit

From the **Audits Menu**, select **Tunes** and enter to view individual count for each tune selection and playtime information. Press the Tunes Button to return to **Main Menu**

<p><b>Audits Menu</b></p> <p>General 1 General 2 Courses Course Wins Placings Vehicles Upgrades <b>Tunes</b> Stunts</p> <p>Exit</p>	<p><b>Tunes (Time in Each)</b></p> <p>Stealth DragRacer Overflow FunkyDohl HitThemHard Ignition LazerRide EatDirt SpeedFreak</p>
<p>Press Volume +/- or View 1/3 to Navigate Press Test or Start to Select Press Service or Tunes to Exit</p>	

## **Stunts Audit**

From the **Audits Menu**, select **Stunts** and enter to view individual count for each stunt performed. Press the Tunes Button to return to **Main Menu**

<p><b>Audits Menu</b></p> <p>General 1                  General 2                  Courses                  Course Wins                  Placings                  Vehicles                  Upgrades                  Tunes  <b><u>Stunts</u></b>                  Exit</p>	<p><b>Stunts / Assist</b></p> <p>Wheelies                  Slides                  Leap Frogs                  Back Flips                  Helis                  Rolls                  End Over Ends                  Spin Outs                  Nitros                    Auto Pilot Triggers</p>
<p>Press Volume +/- or View 1/3 to Navigate                  Press Test or Start to Activate                  Press Service or Tunes to Exit</p>	

## **Pricing Adjustment Menu**

From the **Main Menu**, select **Pricing Adjustment** and enter. The Adjustment Menu allows you to customize the game. Each variable will change an aspect of the basic game pricing, other related player free game reward and upgrade cost. Optimizing these settings should result in continued high player interest and game earnings. You can monitor the affects of these options by comparing audit information before and after the changes have been implemented. Press Start to Select. Press Tunes or Service to Exit.

<p><b>Pricing Menu</b></p> <p>Free Play                  Money Unit                  Coin Value                  Coins Per Bill Pulse                  Coins Per Credit                  Credits to Start                  Credits to Continue                  Max Credits                  First Place Free Race                  Multiplay Win Free Race                  PurchasableUpdates                  Upgrades Per Credits                  Sync All Adjustments                  Exit</p>	<p><b>Preference And Adjustments</b></p>
<p>Press Volume +/- or View 1/3 to Navigate                  Press Test or Start to Select                  Press Service or Tunes to Exit</p>	

## **Price Menu**

From the **Pricing Adjustment Menu**, select **Freeplay** and enter. This option allows you to set the game to Free Play or at no cost. Any coins or bills inserted will continue to be accepted and counted. This will be reflected in the Audits. The credits issued money accepted during Freeplay mode will be available after Freeplay is turned off or deactivated. Please perform Clear Credits to remove unwanted credits. Press Start to Select. Press Tunes or Service to Exit.

<p><b>Freeplay Activate?</b></p> <p>Yes No  Exit</p>	<p><b>Credit Options</b></p> <p><b>Please note the following:</b></p> <p><b>Adjusting the number of Coins per credit will reset the stored number of partial credits.</b></p>
<p>Press Volume +/- or View 1/3 to Navigate Press Test or Start to Select Press Service or Tunes to Exit</p>	

## **Money Unit Menu**

From the **Pricing Menu**, select **Money Unit** and enter. Select the currency which applies to the games location and press Start to select. Press Start to Select. Press Tunes or Service to Exit.

<p><b>Select Currency</b></p> <p>USD US Dollars AUD AUS Dollars CAD CAN Dollars EUR Euros GBP British Pounds DEM Deutschmarks FRF French Franks JPY Japanese Yen ITL Italian Lire CHF Swiss Franks BRL Brazilian Reals DKK Danish Kroner MXN Mexican Pesos RUR Russian Rubles KRW Korean Won CNY Chinese Won</p> <p>Cancel</p>	<p><b>Credit Options</b></p> <p><b>Please note the following:</b></p> <p><b>Adjusting the number of Coins per credit will reset the stored number of partial credits.</b></p>
<p>Press Volume +/- or View 1/3 to Navigate Press Test or Start to Select Press Service or Tunes to Exit</p>	

## **Coin Value Menu**

From the **Pricing Menu**, select **Coin Value** and enter. Choose the coin value based on the currency selected and the coin acceptor type or setting. Press Start to Select. Press Tunes or Service to Exit.

<p><b>Coin Value</b></p> <p>0.01 USD          0.05 USD          0.10 USD          0.25 USD          0.50 USD          1.00 USD          2.00 USD          5.00 USD          10.00 USD          20.00 USD          50.00 USD          100.00 USD          Exit</p>	<p><b>Credit Options</b></p> <p><b>Please note the following:</b></p> <p><b>Adjusting the number of Coins per credit will reset the stored number of partial credits.</b></p>
<p>Press Volume +/- or View 1/3 to Navigate          Press Test or Start to Select          Press Service or Tunes to Exit</p>	

## **Coin Per Bill Pulse Menu**

From the **Pricing Menu**, select **Coin per Bill Pulse Menu** and enter. Choose the equivalent coin value based on the bill acceptor currency type or settings. Press Start to Select. Press Tunes or Service to Exit.

<p><b>Coin Per Bill Pulse?</b></p> <p>1          2          3          4          5          10          20          25          50          100          Exit</p>	<p><b>Credit Options</b></p> <p><b>Please note the following:</b></p> <p><b>Adjusting the number of Coins per credit will reset the stored number of partial credits.</b></p>
<p>Press Volume +/- or View 1/3 to Navigate          Press Test or Start to Select          Press Service or Tunes to Exit</p>	

### **Coin Per Credit Menu**

From the ***Pricing Menu***, select ***Coin per Credit Menu*** and enter. Choose the number of coins required to earn one credit. Press Start to Select. Press Tunes or Service to Exit.

<p><b>Coin Per Credit</b></p> <p>1 2 3 4 5 6 7 8 9 10</p> <p>Cancel</p>	<p><b>Credit Options</b></p> <p><b>Please note the following:</b></p> <p><b>Adjusting the number of Coins per credit will reset the stored number of partial credits.</b></p>
<p>Press Volume +/- or View 1/3 to Navigate Press Test or Start to Select Press Service or Tunes to Exit</p>	

### **Credit To Start Menu**

From the ***Pricing Menu***, select ***Credit To Start Menu*** and enter. Choose the number of credits required to start one game. Press Start to Select. Press Tunes or Service to Exit.

<p><b>Credits to Start</b></p> <p>1 2 3 4 5 6 7 8 9 10</p> <p>Cancel</p>	<p><b>Credit Options</b></p> <p><b>Please note the following:</b></p> <p><b>Adjusting the number of Coins per credit will reset the stored number of partial credits.</b></p>
<p>Press Volume +/- or View 1/3 to Navigate Press Test or Start to Select Press Service or Tunes to Exit</p>	

### **Credit to Continue Menu**

From the **Pricing Menu**, select **Credit To Continue Menu** and enter. Choose the number of credits required to continue from the current game. Press Start to Select. Press Tunes or Service to Exit.

<p><b>Credits to Continue</b></p> <p>1 2 3 4 5 6 7 8 9 10</p> <p>Cancel</p>	<p><b>Credit Options</b></p> <p><b>Please note the following:</b></p> <p><b>Adjusting the number of Coins per credit will reset the stored number of partial credits.</b></p>
<p>Press Volume +/- or View 1/3 to Navigate Press Test or Start to Select Press Service or Tunes to Exit</p>	

### **Max Credits Menu**

From the **Pricing Menu**, select **Max Credit Menu** and enter. Choose the number of maximum credits the game will post. Please note that the game will continue to accept and count additional coins with no additional credits added over the maximum number selected. Press Start to Select. Press Tunes or Service to Exit.

<p><b>Credits to Start</b></p> <p>10 15 20 25 30 35 40 45 50</p> <p>Cancel</p>	<p><b>Credit Options</b></p> <p><b>Please note the following:</b></p> <p><b>Adjusting the number of Coins per credit will reset the stored number of partial credits.</b></p>
<p>Press Volume +/- or View 1/3 to Navigate Press Test or Start to Select Press Service or Tunes to Exit</p>	

### **1<sup>st</sup> Place Free Race Menu**

From the **Pricing Menu**, select **1<sup>st</sup> Place Free Race** and enter. The player wins a free race for a 1<sup>st</sup> place overall finish during a single of networked race game. Press Start to Select. Press Tunes or Service to Exit.

<p><b>First Place Wins Free Race?</b></p> <p>Yes No</p> <p><b>Cancel</b></p>	<p><b>Preference and Adjustments</b></p> <p><b>Please note the following:</b></p> <p><b>Adjusting the number of Coins per credit will reset the stored number of partial credits.</b></p>
<p>Press Volume +/- or View 1/3 to Navigate Press Test or Start to Select Press Service or Tunes to Exit</p>	

### **Multiplay 1<sup>st</sup> Place Wins Free Race**

From the **Pricing Menu**, select **Multiplay 1<sup>st</sup> Wins Free Race** and enter. Select the amount of time in seconds given to the player to reach the first check point. Press Start to Select. Press Tunes or Service to Exit.

<p><b>Multiplay 1<sup>st</sup> Wins Free Race?</b></p> <p>Yes No</p> <p><b>Cancel</b></p>	<p><b>Preference and Adjustments</b></p> <p><b>Please note the following:</b></p> <p><b>Adjusting the number of Coins per credit will reset the stored number of partial credits.</b></p>
<p>Press Volume +/- or View 1/3 to Navigate Press Test or Start to Select Press Service or Tunes to Exit</p>	



## Purchasable Upgrades ?

From the **Pricing Menu**, select **Purchasable Upgrades** and enter. This option if enabled allows purchase of upgrades. Press Start to Select. Press Tunes or Service to Exit.

<p><b>Purchasable Upgrades?</b></p> <p>Yes No</p> <p><b>Cancel</b></p>	<p><b>Preference and Adjustments</b></p> <p><b>Please note the following:</b></p> <p><b>Adjusting the number of Coins per credit will reset the stored number of partial credits.</b></p>
<p>Press Volume +/- or View 1/3 to Navigate Press Test or Start to Select Press Service or Tunes to Exit</p>	

## Upgrades per Credit Menu

From the **Pricing Menu**, select **Upgrades per Credit** and enter. Choose the number of upgrades given per credit. Press Start to Select. Press Tunes or Service to Exit.

<p><b>Upgrades per Credit</b></p> <p>1 2 3 4 5 6 7 8 9 10</p> <p><b>Cancel</b></p>	<p><b>Credit Options</b></p> <p><b>Please note the following:</b></p> <p><b>Adjusting the number of Coins per credit will reset the stored number of partial credits.</b></p>
<p>Press Volume +/- or View 1/3 to Navigate Press Test or Start to Select Press Service or Tunes to Exit</p>	

## **System Ajustments Menu**

From the **Main Menu**, select **System Adjustments** and enter. Press Start to Select. Press Tunes or Service to Exit.

<p><b>System Adjustments</b></p> <p>Attract Audio          Max Name Length          Wheel Stiffness          Automatic Vol. Sync          Allow Auto Calibration          Allow Wheel Effects</p> <p>Sync All Adjustments</p> <p>Exit</p>	<p><b>Preference and Adjustments</b></p> <p><b>Change all system related adjustments and settings here.</b></p>
<p>Press Volume +/- or View 1/3 to Navigate          Press Test or Start to Select          Press Service or Tunes to Exit</p>	

## **Attract Audio Menu**

From the **System Adjustment Menu**, select **Attract Audio** and enter. Select option to play game music during standby or attract mode. Press Start to Select. Press Tunes or Service to Exit.

<p><b>Turn On Attract Mode Audio?</b></p> <p>Yes          No</p> <p><b>Cancel</b></p>	<p><b>Preference and Adjustments</b></p> <p><b>Change all system related adjustments and settings here.</b></p>
<p>Press Volume +/- or View 1/3 to Navigate          Press Test or Start to Select          Press Service or Tunes to Exit</p>	

### **Max Name Length Menu**

From the **System Adjustment Menu**, select **Max Name Length** and enter. Choose the maximum number of alpha numeric characters allowed during player name entry. Press Start to Select. Press Tunes or Service to Exit.

<p><b>Maximum Name Length</b></p> <p>3 4 5 6 7</p> <p>Cancel</p>	<p><b>Preference and Adjustments</b></p> <p>Change all system related adjustments and settings here.</p>
<p>Press Volume +/- or View 1/3 to Navigate Press Test or Start to Select Press Service or Tunes to Exit</p>	

### **Wheel Stiffness Level Menu**

From the **Adjustment Menu**, select **Wheel Stiffness** and enter. Select wheel stiffness level. Default setting is 0.20. Press Start to Select. Press Tunes or Service to Exit.

<p><b>Wheel Stiffness Factor?</b></p> <p>0.00 Less Stiff 0.10 <b>0.20 Default</b> 0.30 0.40 More Stiff</p> <p>Cancel</p>	<p><b>Preference and Adjustments</b></p>
<p>Press Volume +/- or View 1/3 to Navigate Press Test or Start to Select Press Service or Tunes to Exit</p>	

## Automatic Volume Sync Menu

From the **System Adjustment Menu**, select **Automatic Volume Sync** and enter. Select option to synchronize game volume adjustment across all linked or networked games. When active, volume for all linked games can be adjusted to the same level from any one of the games connected to the network. Press Start to Select.

<p><b>Automatic Volume Sync?</b></p> <p>Yes No</p> <p><b>Cancel</b></p>	<p><b>Preference and Adjustments</b></p> <p><b>Change all system related adjustments and settings here.</b></p>
<p>Press Volume +/- or View 1/3 to Navigate Press Test or Start to Select Press Service or Tunes to Exit</p>	

## Automatic Volume Sync Menu

From the **System Adjustment Menu**, select **Automatic Volume Sync** and enter. Select option to synchronize game volume adjustment across all linked or networked games. When active, volume for all linked games can be adjusted to the same level from any one of the games connected to the network. Press Start to Select. Press Tunes or Service to Exit.

<p><b>Automatic Volume Sync?</b></p> <p>Yes No</p> <p><b>Cancel</b></p>	<p><b>Preference and Adjustments</b></p> <p><b>Change all system related adjustments and settings here.</b></p>
<p>Press Volume +/- or View 1/3 to Navigate Press Test or Start to Select Press Service or Tunes to Exit</p>	

## Allow Auto Calibration Menu

From the **System Adjustment Menu**, select **Allow Autocalibration** and enter. If active, this feature allows the game to calibrate the steering wheel every time the game is powered on or re-started. Press Start to Select. Press Tunes or Service to Exit.

<p><b>Allow Auto Calibration?</b></p> <p>Yes No</p> <p><b>Cancel</b></p>	<p><b>Preference and Adjustments</b></p> <p><b>Change all system related adjustments and settings here.</b></p>
<p><b>Press Volume +/- or View 1/3 to Navigate</b> <b>Press Test or Start to Select</b> <b>Press Service or Tunes to Exit</b></p>	

## Allow Feedback Wheel Effects

From the **System Adjustment Menu**, select **Allow Feedback Wheel Effects** and enter. If this feature is active, the steering wheel feedback mechanism produces an appropriate response to the steering wheel during events such as collisions or driving on gravel for added realism and enhanced player experience. Press Start to Select. Press Tunes or Service to Exit.

<p><b>Allow Feedback Wheel Effects?</b></p> <p>Yes No</p> <p><b>Cancel</b></p>	<p><b>Preference and Adjustments</b></p> <p><b>Change all system related adjustments and settings here.</b></p>
<p><b>Press Volume +/- or View 1/3 to Navigate</b> <b>Press Test or Start to Select</b> <b>Press Service or Tunes to Exit</b></p>	

## **Game Adjustments Menu**

From the **Main Menu**, select **Game Adjustments** and enter. Press Start to Select. Press Tunes or Service to Exit.

<p><b>Game Adjustments</b></p> <p>Start Time Bonus Checkpoint Time Bonus Game Difficulty Speed Measurements Plays for Score Reset Autopilot Available Girls and Crowd Active</p> <p>Sync All Adjustments</p> <p>Exit</p>	<p><b>Preference and Adjustments</b></p> <p><b>Change all game related adjustments and settings here.</b></p>
<p>Press Volume +/- or View 1/3 to Navigate Press Test or Start to Select Press Service or Tunes to Exit</p>	

## **Start Time Bonus Menu**

From the **Game Adjustment Menu**, select **Start Bonus Time** and enter. Select amount of time given at the start of the race to reach the first Checkpoint. Additional time is given at each Checkpoint. Press Start to Select. Press Tunes or Service to Exit

<p><b>Check Point Bonus Time?</b></p> <p>30 seconds 40 seconds 50 seconds 60 seconds 70 seconds 80 seconds 90 seconds 100 seconds 120 seconds</p> <p>Cancel</p>	<p><b>Preference and Adjustments</b></p> <p><b>Change all game related adjustments and settings here.</b></p>
<p>Press Volume +/- or View 1/3 to Navigate Press Test or Start to Select Press Service or Tunes to Exit</p>	

## **Checkpoint Bonus Time Menu**

From the **Game Adjustment Menu**, select **Checkpoint Bonus Time** and enter. Select the amount of time in seconds given to the player to reach the next check point after reaching a check point. Press Start to Select. Press Tunes or Service to Exit.

<p><b>Check Point Bonus Time?</b></p> <p>10 seconds                  20 seconds                  30 seconds                  40 seconds                  50 seconds                  60 seconds                  70 seconds                  80 seconds                  90 seconds                  100 seconds</p> <p><b>Cancel</b></p>	<p><b>Preference and Adjustments</b></p> <p><b>Change all game related adjustments and settings here.</b></p>
<p>Press Volume +/- or View 1/3 to Navigate                  Press Test or Start to Select                  Press Service or Tunes to Exit</p>	

## **Game Difficulty Menu**

From the **Game Adjustment Menu**, select **Game Difficulty** and enter. The default difficulty level is 5. Press Start to Select. Press Tunes or Service to Exit.

<p><b>Game Difficulty Level?</b></p> <p>1 Easier                  2                  3                  4  <b>5</b>                  6                  7                  8                  9                  10 Harder</p> <p><b>Cancel</b></p>	<p><b>Preference and Adjustments</b></p> <p><b>Change all game related adjustments and settings here.</b></p>
<p>Press Volume +/- or View 1/3 to Navigate                  Press Test or Start to Select                  Press Service or Tunes to Exit</p>	

**Note:**

Please reference the game Audit information to determine the appropriate difficulty setting for your location. Compare changes in game statistics and game revenue before and after the change.

### **Speed Measurement Menu**

From the **Game Adjustment Menu**, select **Speed Measurement** and enter. Select which unit is to be used to measure car speed. Choose MPH or Miles per Hour. Choose KPH or Kilometers per Hour. Press Start to Select. Press Tunes or Service to Exit

<p><b>Speed Measured In?</b></p> <p>MPH KPH</p> <p>Cancel</p>	<p><b>Preference and Adjustments</b></p> <p>Change all game related adjustments and settings here.</p>
<p>Press Volume +/- or View 1/3 to Navigate Press Test or Start to Select Press Service or Tunes to Exit</p>	

### **Plays for High Score Reset Menu**

From the **Adjustment Menu**, select **Plays for High Score Reset** and enter. Select the number of plays before high score table is reset. Press Start to Select. Press Tunes or Service to Exit.

<p><b>Plays For High Score Reset?</b></p> <p>1000 2000 2500 5000 7500 <b>10000</b> 12500 15000 17500 20000</p> <p>Cancel</p>	<p><b>Preference and Adjustments</b></p> <p>Change all game related adjustments and settings here.</p>
<p>Press Volume +/- or View 1/3 to Navigate Press Test or Start to Select Press Service or Tunes to Exit</p>	



### **Autopilot Available Menu**

From the **Game Adjustment Menu**, select **Autopilot Available** and enter. When active, this feature allows the game to run in autopilot mode after 10 seconds has elapsed without player input. This provides an opportunity for younger players to enjoy the game experience as well. Press Start to Select. Press Tunes or Service to Exit

<p><b>Turn On Attract Mode Audio?</b></p> <p>Yes No</p> <p><b>Cancel</b></p>	<p><b>Preference and Adjustments</b></p> <p><b>Change all game related adjustments and settings here.</b></p>
<p>Press Volume +/- or View 1/3 to Navigate Press Test or Start to Select Press Service or Tunes to Exit</p>	

### **Girls and Crowds Enable Menu**

From the **Game Adjustment Menu**, select **Girls and Crowds** and enter. Starting line girl and crowds feature can be activated or deactivated by selecting yes or no. Press Start to Select. Press Tunes or Service to Exit.

<p><b>Girls and Crowds Enabled?</b></p> <p>Yes No</p> <p><b>Cancel</b></p>	<p><b>Preference and Adjustments</b></p> <p><b>Change all game related adjustments and settings here.</b></p>
<p>Press Volume +/- or View 1/3 to Navigate Press Test or Start to Select Press Service or Tunes to Exit</p>	

**Note:**

The starting line girl and crowd can be removed for certain locations which may consider this feature not suitable or appropriate.

## **Utilities Menu**

From the ***Test Main Menu***, select ***Utilities*** and enter. The Utilities Menu contains tools which the operator could use to manage game adjustments or reset key game and player score and statistic information. The option to perform a game factory restore can also be accessed.

<p><b>Utilities Menu</b></p> <p>CRC Check</p> <p>Clear Credits Clear Audits Reset High Scores Reset Player Stats Default Adjustments Reset Link System Config. Factory Restore</p> <p><b>Cancel</b></p>	<p><b>Utilities</b></p> <p><b>Please note the following:</b></p> <p><b>Setting default adjustments or performing a factory restore will require calibration afterwards.</b></p> <p><b>A factory restore will perform all the resets listed at the left, clearing credits, audits, high scores, player data.</b></p>
<p>Press Volume +/- or View 1/3 to Navigate Press Test or Start to Select Press Service or Tunes to Exit</p>	

### **Note:**

- Information will be permanently erased by Clear or Reset functions.
- It is often ideal to perform a factory restore when the game is being moved to a new location.
- Record your game audit information if performing any of the above functions.

## **CRC Check Menu**

From the ***Utilities Menu***, select ***CRC Check*** and enter. Performing CRC check verifies the integrity of the software. Press Start to Select. Press Tunes or Service to Exit.

<p><b>Really Perform CRC Check?</b></p> <p>Yes No</p> <p><b>Cancel</b></p>	<p><b>Utilities</b></p> <p><b>Please note the following:</b></p> <p><b>Setting default adjustments or performing a factory restore will require calibration afterwards.</b></p> <p><b>A factory restore will perform all the resets listed at the left, clearing credits, audits, high scores, player data.</b></p>
<p>Press Volume +/- or View 1/3 to Navigate Press Test or Start to Select Press Service or Tunes to Exit</p>	

### **Clear Credit Menu**

From the ***Utilities Menu***, select ***Clear Credits*** and enter. Performing Clear Credit will delete any remaining credits posted. Press Start to Select. Press Tunes or Service to Exit.

<p><b>Really Clear Credits?</b></p> <p>Yes No</p> <p><b>Cancel</b></p>	<p><b>Utilities</b></p> <p><b>Please note the following:</b></p> <p><b>Setting default adjustments or performing a factory restore will require calibration afterwards.</b></p> <p><b>A factory restore will perform all the resets listed at the left, clearing credits, audits, high scores, player data.</b></p>
<p>Press Volume +/- or View 1/3 to Navigate Press Test or Start to Select Press Service or Tunes to Exit</p>	

### **Clear Audit Menu**

From the ***Utilities Menu***, select ***Clear Audit*** and enter. Performing Clear Audit will delete all audit information found on the Audit Menu. Please record them if you ever need to reference the information. Press Start to Select. Press Tunes or Service to Exit.

<p><b>Really Clear Credits?</b></p> <p>Yes No</p> <p><b>Cancel</b></p>	<p><b>Utilities</b></p> <p><b>Please note the following:</b></p> <p><b>Setting default adjustments or performing a factory restore will require calibration afterwards.</b></p> <p><b>A factory restore will perform all the resets listed at the left, clearing credits, audits, high scores, player data.</b></p>
<p>Press Volume +/- or View 1/3 to Navigate Press Test or Start to Select Press Service or Tunes to Exit</p>	

### **Clear High Scores Menu**

From the **Utilities Menu**, select **Clear High Scores** and enter. Performing Clear High Score will clear the all high score tables. Press Start to Select. Press Tunes or Service to Exit.

<p><b>Really Clear High Scores?</b></p> <p>Yes No</p> <p><b>Cancel</b></p>	<p><b>Utilities</b></p> <p><b>Please note the following:</b></p> <p><b>Setting default adjustments or performing a factory restore will require calibration afterwards.</b></p> <p><b>A factory restore will perform all the resets listed at the left, clearing credits, audits, high scores, player data.</b></p>
<p>Press Volume +/- or View 1/3 to Navigate Press Test or Start to Select Press Service or Tunes to Exit</p>	

### **Clear Player Stats Menu**

From the **Utilities Menu**, select **Clear Player Stats** and enter. Performing Clear Player Stats will clear all player information, including PIN, car upgrades and money earned. Press Start to Select. Press Tunes or Service to Exit.

<p><b>Really Clear Player Stats?</b></p> <p>Yes No</p> <p><b>Cancel</b></p>	<p><b>Utilities</b></p> <p><b>Please note the following:</b></p> <p><b>Setting default adjustments or performing a factory restore will require calibration afterwards.</b></p> <p><b>A factory restore will perform all the resets listed at the left, clearing credits, audits, high scores, player data.</b></p>
<p>Press Volume +/- or View 1/3 to Navigate Press Test or Start to Select Press Service or Tunes to Exit</p>	

## **Set Default Adjustments Menu**

From the **Utilities Menu**, select **Default Adjustment** and enter. Performing Default Adjustment setting will restore game adjustments back to its manufacturer recommended settings. The game will need to be re-calibrated. Press Start to Select. Press Tunes or Service to Exit.

<p><b>Really Set Default Adjustments?</b></p> <p>Yes No</p> <p><b>Cancel</b></p>	<p><b>Utilities</b></p> <p>Please note the following:</p> <p>Setting default adjustments or performing a factory restore will require calibration afterwards.</p> <p>A factory restore will perform all the resets listed at the left, clearing credits, audits, high scores, player data.</p>
<p>Press Volume +/- or View 1/3 to Navigate Press Test or Start to Select Press Service or Tunes to Exit</p>	

## **Set Default Adjustments Menu**

From the **Utilities Menu**, select **Reset Link System Config** and enter. This utility allows the communication between linked games to be re-established due to a possible fault other than hardware. Check all network related hardware (cables, router) and make sure that they are connected and then power cycle the games. Press Start to Select. Press Tunes or Service to Exit.

<p><b>REALLY Reset Link System Config?</b></p> <p>Yes (All Linked Games) Yes (This Game Only)</p> <p><b>Cancel</b></p>	<p><b>Confirmation:</b></p> <p>Select "Yes" to carry out this utility.</p> <p>Select "Cancel" to return to the previous menu.</p> <p>This will cause the Link System configuration to be reset. The Link System will not function until the machine reboots.</p>
<p>Press Volume +/- or View 1/3 to Navigate Press Test or Start to Select</p>	

## **Factory Restore Menu**

From the **Utilities Menu**, select **Factory Restore** and enter. Performing Factory Restore will restore game adjustments back to its manufacturer recommended settings and clear all audit information. The game will need to be re-calibrated. Press Start to Select. Press Tunes or Service to Exit.

<p><b>Really Perform Factory Restore?</b></p> <p>Yes No</p> <p><b>Cancel</b></p>	<p><b>Utilities</b></p> <p><b>Please note the following:</b></p> <p><b>Setting default adjustments or performing a factory restore will require calibration afterwards.</b></p> <p><b>A factory restore will perform all the resets listed at the left, clearing credits, audits, high scores, player data.</b></p>
<p>Press Volume +/- or View 1/3 to Navigate Press Test or Start to Select Press Service or Tunes to Exit</p>	

## **Calibration Menu**

From the **Test Main Menu**, select **Calibration** and enter. Making sure that the wheel, gas and brake are all properly calibrated is the easiest way to make sure that your driving game could maximize its earning potential. Follow the screen instructions carefully. Verify proper calibration on the Switch Test screen. Check and make sure that the minimum, center and maximum values correspond to the actual position of the control.

<p><b>Calibration</b></p>	
<input type="checkbox"/>	<p>Turn Wheel To Center Hit Test/Start</p>
<input type="checkbox"/>	<p>Turn Wheel Left Then Hit Test/Start</p>
<input type="checkbox"/>	<p>Turn Wheel Right Then Hit Test/Start</p>
<input type="checkbox"/>	<p>Push and Release Gas Then Hit Test/Start</p>
<input type="checkbox"/>	<p>Push and Release Gas Then Hit Test/Start</p>
<input type="checkbox"/>	<p>Hit Test/Start to Exit</p>

**Note:**

- If the game requires constant re-calibration, check the controls for mechanical wear or damage. Replace if necessary.
- Normal wear and tear of the controls means that calibration should be part of the games scheduled maintenance.

## **Volume Menu**

From the ***Test Main Menu***, select ***Volume*** and enter. This refers to the game volume while in play. Use the Volume Up/ Volume Down button on the service panel to adjust volume level. Press Start to Select. Press Tunes or Service to Exit.

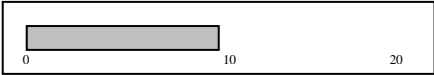
<p>Volume</p> 	<p><b>Volume Adjust</b></p> <p><b>Volume:</b> <b>10/20</b></p> <p><b>Current Track:</b> <b>DNB</b></p>
<p>Press Volume UP/DOWN to Adjust Press Test Button to Accept Press Service Button to Exit</p>	

### **Note:**

- Adjusting the volume while in attract mode only affects the attract volume and not the actual game volume.
- Adjustment to game volume must be done while on Volume Adjust screen or while on game mode.
- Adjust volume levels relative to location and environment.

## **Volume Menu**

From the ***Test Main Menu***, select ***Attract Volume*** and enter. This refers to the attract mode volume. Use the Volume Up/ Volume Down button on the service panel to adjust volume level. Press Start to Select. Press Tunes or Service to Exit.

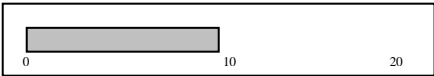
<p>Attract Volume</p> 	<p><b>Attract Volume Adjust</b></p> <p><b>Volume:</b> <b>10/20</b></p> <p><b>Current Track:</b> <b>DNB</b></p>
<p>Press Volume UP/DOWN to Adjust Press Test Button to Accept Press Service Button to Exit</p>	

## TROUBLESHOOTING GUIDE

PROBLEM	POSSIBLE CAUSE	SOLUTION
<b>Game will not power up.</b>	Game not plugged in.	Plug game into receptacle.
	Game not turned on.	Turn ON main power switch
	Game fuse is blown	Check game fuse.
	No power to receptacle.	Plug game into powered receptacle.
	PC power switch is OFF	Turn PC power switch ON.
	PC BIOS set wrong.	See Appendix B.
<b>“No Signal” Message</b>	Video cable not secure.	Check and secure video connector.
	PC not turned ON.	Turn ON power to PC.
<b>No video display.</b>	No power to video display.	Check power to video display.
		see <i>Game will not power up.</i>
<b>No sound.</b>	Audio cable not connected.	Check audio cable connection.
	Speaker not connected.	Check speaker connection.
<b>“I/O Board Missing”</b>	USB connector not connected.	Check USB connector from PC to I/O board. Perform Hard Drive Recovery
<b>Game will not load.</b>	New Hard Drive installed.	Power cycle by un-plugging game. Perform Hard Drive Recovery
	Hard Drive data corrupted.	Perform Hard Drive Recovery.
<b>Game Freezes</b>	Secure Dongle Loose	Secure and Tighten Dongle
	Poor Ventilation	Check Fan Operation and Airflow
	USB cable loose	Remove and Reinsert USB both ends of cable
	Failing or Bad Power Supply	Check Power Supply Output or Replace With Known Good.
	Corrupted Hard Drive	Perform CRC Check. Re-Image if bad.
<b>Game resets.</b>	Low DC voltage.	Check for proper voltage(+5V,+12V). Adjust cabinet main power supply.
	Door lamp is wrong rating.	Use only 5volt lamps.
	Cabinet/PC temperature is too high.	Check that vents and fans are functioning and not obstructed.
	Hard Drive data corrupted.	Perform Hard Drive Recovery..
<b>Not Linking</b>	DIP Switch Set Wrong	Refer to Networking Setup Section.
	Network Cable Bad	Check Connection or Replace
	Game Operator Settings Not The Same.	Make Sure All Settings Are The Same Between Linked Games
<b>No Wheel Feedback</b>	Bad Wheel Driver Board	Replace With Known Good To Verify
	Bad Fuse on Wheel Driver Board	Replace Fuse On Wheel Driver With The Same Value Fuse
	Parallel Cable Loose	Secure and Tighten Parallel Cable
	Loose Electrical Connection	Check Connection To Motor and Wheel Driver Board
	Bad Transformer Fuse	Replace With Same Value Fuse

**Warning:** Do not connect or disconnect any cables or connectors on this game with the power on. This could potentially damage the game.



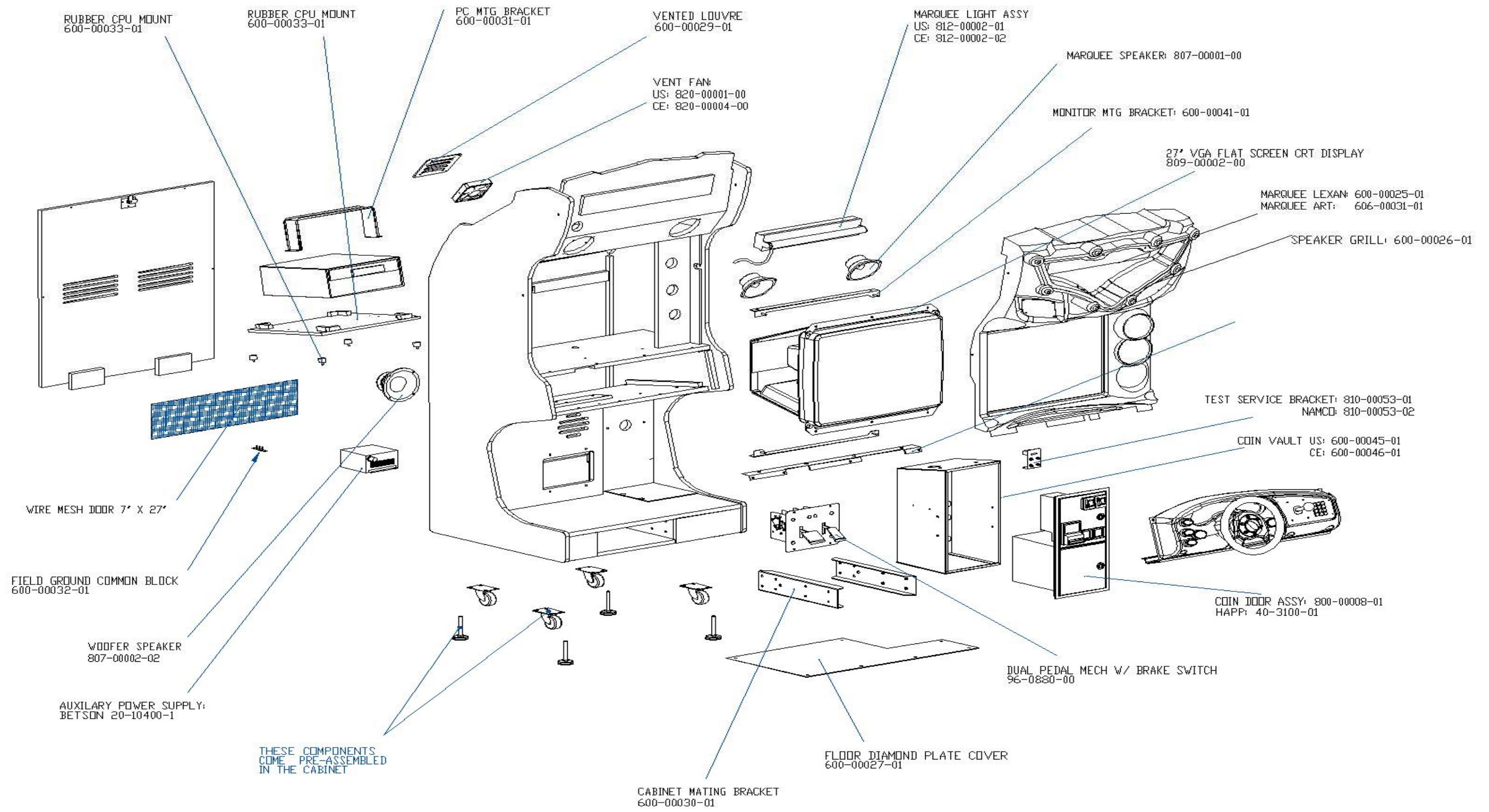

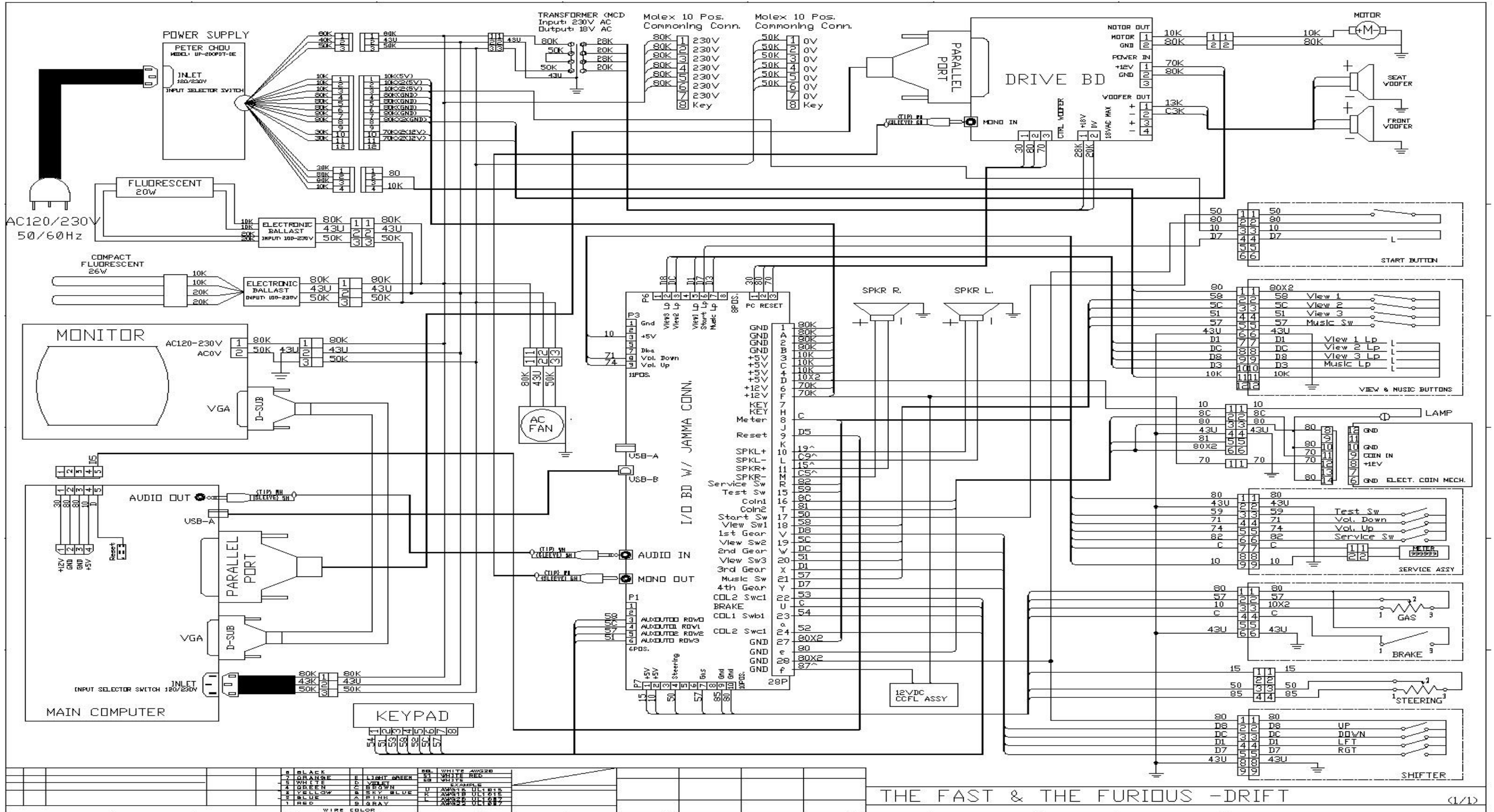

# CONTROL PANEL ASSEMBLY

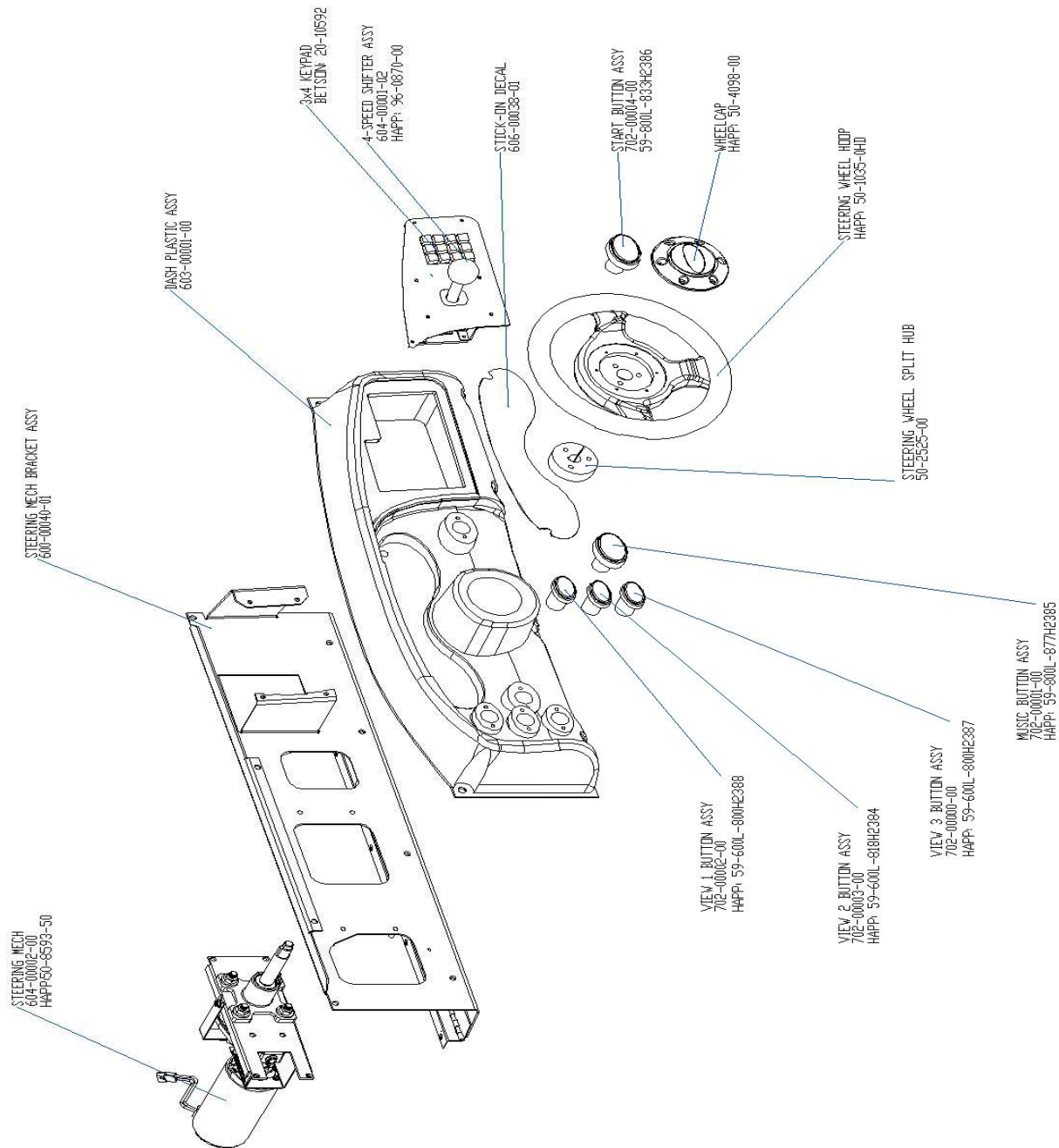

# PEDESTAL ASSEMBLY

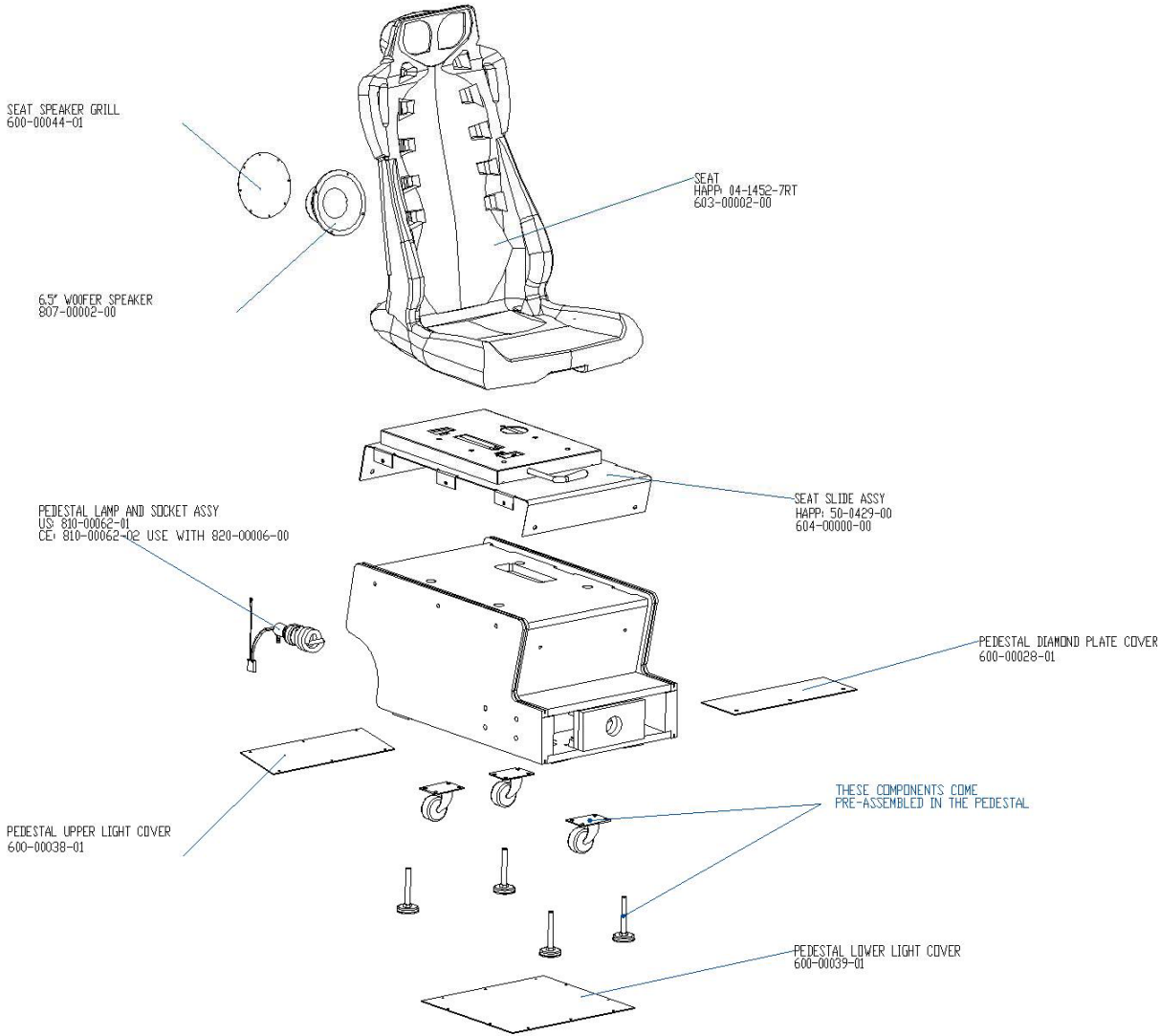

## **Appendix A: Hard Drive Recovery**

**NOTICE:** Fast and the Furious is shipped with a recovery compact disk. Hard drives have been known to occasionally fail for many reasons. Follow the procedure below to restore data on the hard drive if a disk failure should occur. Use extreme care when performing the following procedure and avoid rough handling of pc or CD. Please check the Troubleshooting Guide section of this document. Have the recovery CD ready before you begin.

The following are some symptoms which may indicate a possible bad hard drive:

- Hard Drive Test reports “bad” or “missing” files. Please refer to Trouble Shooting section of the manual.
- The game fails to finish loading.
- A boot error is reported after game is power cycled or reset.
- The game is looking for a boot CD to be inserted.
- Erratic game or attract mode.

**Note:** It is important that the USB cable from pc and power is connected to the I/O board before you proceed.

### Hard Drive Recovery Procedure:

1. Open the control panel to access the pc.
2. Press the button on the CD drive to open CD tray.
3. Carefully insert the recovery disk into the tray.
4. Press the button on the CD drive to close the CD tray.
5. Turn OFF the pc by pressing the power button once.
6. Turn ON the pc by pressing the power button once.
7. Disk recovery process will begin automatically.
8. A message at the top of the screen will prompt you to remove the disk when process is over. Press the CD drive button to open tray. Remove the recovery disk and store safely.
9. Turn OFF the pc by pressing the power button once.
10. Turn ON the pc by pressing the power button once.

**Note:** Do not interrupt power or reset the game during the following process!

11. The game will begin to initialize and load. It will typically take about five minutes to complete.
12. The hard drive recovery process is complete when the game enters attract mode.
13. Proceed with control calibration and make necessary game adjustments. Please refer to Setup and Test section of this manual.

-- End of Procedure--

## **AppendixB: Power Management Setting(BIOS)**

**NOTE:** Fast and Furious is shipped with the correct BIOS settings. Any changes made to the BIOS other than what is described below may adversely affect game functionality.

This BIOS setting allows the PC to automatically power up when AC power is detected. This eliminates the need to manually turn the PC ON after a power disruption.

Procedure:

1. Turn game *OFF*.
2. Connect a PS/2 or USB keyboard to the PC.
3. Hold the DELETE key while turning the PC *ON*.
4. On the **BIOS** menu screen, use the DOWN arrow to scroll down to **Power Management Setup**. Hit ENTER key once.
5. On the **Power Management Setup** menu, use the DOWN arrow to scroll down to **After AC Power Lost**.
6. Use the (+) button to change **After Power Lost** setting to: [**Power ON**].
7. Hit F10.
8. Hit Enter to Save and Exit.
9. PC will reset and begin to load game.

## Appendix C: Basic Display Adjustments

**WARNING:** Extremely high voltage is present on the monitor assembly. The monitor does not contain any user serviceable parts. Do not attempt to service the monitor.

Target:  
Terror

utilizes gun optic boards which rely on signals being detected from the display to operate properly. The quality of the display is an important element in making sure that the guns operate correctly and reliably.

The following are display settings which you should become familiar with. It is important to note that settings may differ slightly between manufacturers and even between displays of the same manufacturers. Certain factors like age of the display could also be a factor. Therefore, the information below should only serve as a reference as actual settings may not be practical in most cases.

Setting	Adjustment
<b>Brightness</b>	<b>Function:</b> Background Brightness or Black Level. <b>Set Level:</b> Black background should appear dark and not gray.
<b>Contrast</b>	<b>Function:</b> Definition/ Sharpness of character against background. <b>Set Level:</b> Outer edges of character or text should not be distorted.
<b>H-Position</b>	<b>Function:</b> Horizontal Position. Side/side centering. <b>Set Level:</b> Picture should be centered from side to side.
<b>H-Size</b>	<b>Function:</b> Horizontal Size. Side/side dimension. <b>Set Level:</b> Picture should be full from side to side.
<b>V-Position</b>	<b>Function:</b> Vertical Position. Up/down centering. <b>Set Level:</b> Picture should be centered up and down.
<b>V-Size</b>	<b>Function:</b> Vertical Size. Up/down dimension. <b>Set Level:</b> Picture should be full from top to bottom.
<b>Pin Cushion</b>	<b>Function:</b> Degree of straightness along both vertical sides of the picture. <b>Set Level:</b> Both sides of the picture should be straight, without curvature.
<b>Degauss</b>	<b>Function:</b> De-magnetizes the picture tube when activated. This eliminates picture discoloration caused by magnetic disturbance around the picture tube.

Digital displays are adjusted using a button type remote adjust board. Below are functional diagrams for Kortek and Wells Gardner 27" digital displays:

### Neotec Remote:

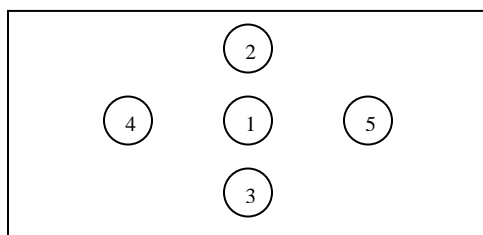

**Button 1:** Display Menu  
**Button 2:** Cycle up thru menu levels  
**Button 3:** Cycles downward thru menu levels  
**Button 4:** Increase Value of Selected Item  
**Button 5:** Decrease Value of Selected Item

### Wells Gardner:

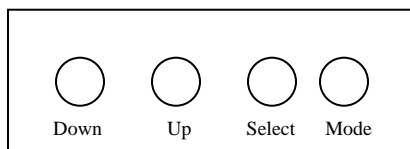

**Down:** Cycles downward thru levels  
**Up:** Cycles upward thru levels  
**Select:** Select setting to be adjusted.  
**Mode:** Menu/Exit

## Copyright and License Notice:

The Fast and the Furious is a trademark and copyright of Universal Studios licensed by Universal Studios Licensing L.L.L.P. All rights reserved.

### Parental Advisory

A note to parents: The Fast and the Furious is rated PG-13. Consult [www.filmratings.com](http://www.filmratings.com) for further information.

Steering wheel force feedback technology is licensed from Atari Games Corporation, United States Patent #5,044,956.

Dodge and HEMI are trademarks of Daimler Chrysler Corporation. Dodge Viper SRT10, Dodge Challenger Concept and their trade dress are used under license by Raw Thrills, Inc.  
Daimler Chrysler Corporation 2007

Nissan: 350Z, and Skyline GTR and associated symbols emblems and designs are trademarks of Nissan Motor Co. Ltd. Used under license to Raw Thrills, Inc.

General Motors trademarks used under license to Raw Thrills, Inc.

Mazda, RX-7, RX-8 and associated symbols, emblems and design are trademarks of Mazda Motor Corporation. Used under licensed to Raw Thrills, Inc.

Saleen, S7 and all vehicle model names and designs are registered trademarks of Saleen, Inc...  
Used under license to Raw Thrills, Inc.

Ford Oval and nameplates are registered trademarks owned and licensed by Ford Motor Company.