

# BUSTER BUBBLES



*Our First Ever  
Touch Screen  
Video  
Redemption  
Game!*

Dimensions: 33" w x 32" l x 70" h



Innovative Concepts in Entertainment 10123 Main Street Clarence, New York 14031  
Phone: 716-759-0370 Fax: 716-759-0390 Email: [play@icegame.com](mailto:play@icegame.com) Visit: [www.icegame.com](http://www.icegame.com)

## Table of Contents

Setup - Calibration - Cleaning	Page 3 - 6
Entering Setup	
Calibration	
Cleaning Touch Screen	
Programming	
Assembly diagrams	
Lower assembly	Page 7
Monitor assembly	Page 8 - 9
Back Door assembly	Page 10
Bottom plate assembly	Page 11 - 12
I/O board assembly	Page 13
Jamma Harness Pinout	Page 14
Parts list	Page 15
Warranty	Page 16 - 17

## Setup

Located inside the coin door are the coin and ticket meters, volume up and down buttons, service button, and test button. You can lower or raise the volume by pressing the UP and DOWN VOLUME buttons or set the volume through settings. To test play your game without adding to the coin meter, press the SERVICE button. To enter programming options, press the TEST button.

To navigate through the menus, press volume up and down to move to different options and press test to select that option.

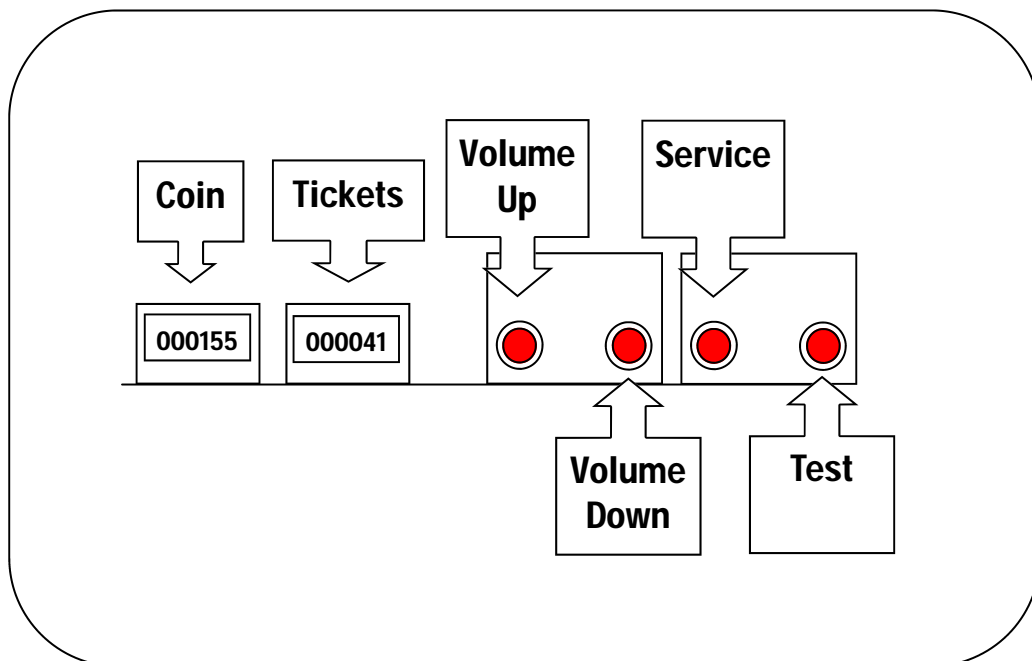

## Touch Screen - Calibration and Cleaning

When you have installed your game on location it is a good idea to enter programming and adjust the calibration. Doing so will ensure reliable operation at that location. If at anytime you upgrade the software to a newer version you should also enter programming and perform a calibration.

When cleaning your touch-screen monitor it is important to never use an ammonia based cleaner. Any non-ammonia based glass cleaner can be used to clean the screen. Always spray the glass cleaner on the cloth or towel and then clean the touch-screen.

# Setup - Programming

Software version 1.00.01

## Main Menu

### Operation Adjustments

<i>Game Adjustments</i>	<i>Default</i>	<i>Options</i>
Invert Touch Input	Off	On/Off
Use Bonus Bar	On	Off/On
Bonus Payout Amount	Small	Small/Medium/Large
 <i>Ticket Adjustments</i>		
Minimum Tickets	1	0 or 1
Ticket Value (in cents)	.01	0 - 100
Credit Value (in cents)	.25	0 - 100
 <i>Coin Settings</i>		
Free play	Off	On/Off
Currency Type	Dollar	Country or Coins
Currency Unit Value	.25	
Coin 1 Value	.25	
Coin 2 Value	.25	
Coin 3 Value/DBV Pulse	.25	
Maximum Credits	\$500	
 <i>Player Cost/Payout</i>		
Cost to Play	.25	
Target Payout Percentage	40%	25 - 50
 <i>Volume</i>		
Game Volume	8	1-32
Attract Volume	6	1-32
Attract Sounds	occasionally	off/always/occasionally

# Setup - Programming

Software version 1.00.01

## Main Menu

### General Audits

#### *Game Audits*

*Games played*

*Average game time*

#### *Ticket Audits*

Total tickets dispensed

Average tickets per play

Current payout percentage

Total tickets (500 games)

Average tickets (500 games)

Payout percentage (500 games)

Tickets owed

#### *System Audits*

Playtime

Up time

Watch dogs

Exceptions

Bad traps

#### *Coin Audits*

Total Coin 1

Total Coin 2

Total Coin 3 (DBV)

Lifetime coin count

Service credits

# Setup - Programming

**Software version 1.00.01**

**Main Menu**

**Reset Menu**

*Reset game audits*  
*Reset credits*  
*Reset tickets*  
*Reset coin counters*  
*Reset adjustments*  
*Factory reset*

**System Tests**

*Version list*  
*Switch test*  
*Screen tests*  
*Sound test*  
*File test*  
*Coin meter test*  
*Ticket dispenser test*  
*Dipswitch settings*  
*Watchdog test*

**Screen Calibration**

ITEM NO.	PART NUMBER	DESCRIPTION	QTY.
1	BU3054X	MOUNTING PANEL - LEFT ASSY	1
2	HR1019	LEVELING LEG SHORT	4
3	BU3001	FIBERGLASS BUSTER SQUIRREL	1
4	BU1001X	MONITOR HOUSING ASSEMBLY	1
5	BU3052CX	LOWER REAR ACCESS DOOR ASY	1
6	DN2000	DN COMPUTER	1
7	WS1022	TICKET BIN (DOUBLE)	1
8	211	SWITCH (LOW TICKET) V7-2B17D8	1
9	WA5001	COIN DOOR (TRIPLE) DUAL MECH W/ TICKET	1
10	BU2007X	ASY (POWER SUPPLY)	1
11	BU3055X	MOUNTING PANEL - RIGHT ASSY	1
12	BU3060X	ASSY- PCB MOUNTING BOARD	1
13	SX1013	COUNTER BRACKET	1
14	BU1004	BASE PLATE	2
15	BU7011	DECAL-EYES	1
16	BU7009	DECAL-TICKETS	1
17	HH5005	TICKET DISPENSER (ENTROPY)	1
18	7989	DECAL-ICE WEB LOGO	1

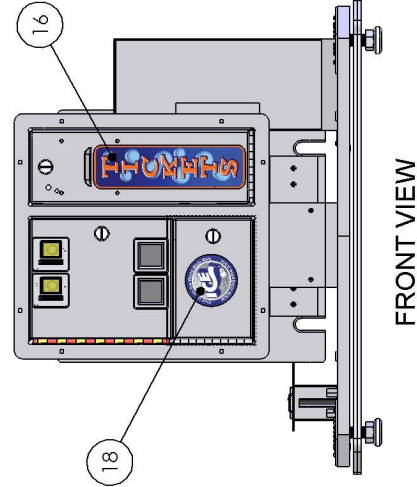

FRONT VIEW

COMPONENTS DIAGRAM  
FIBERGLASS SHELL BODY (BU3001)  
NOT SHOWN

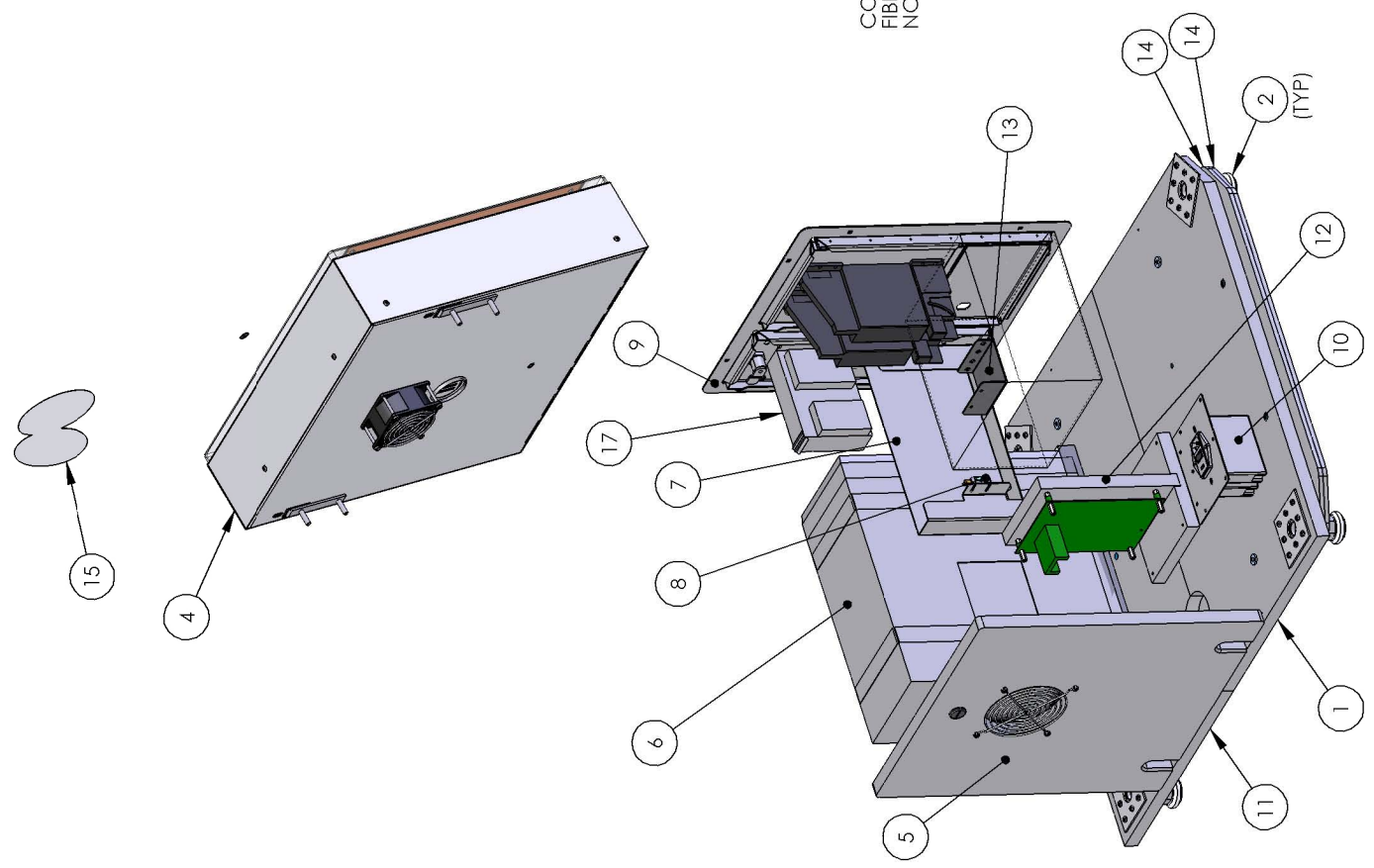

BU1001X



ITEM NO.	PART NUMBER	DESCRIPTION	QTY.
1	BU1001	MONITOR FRONT HOUSING	1
2	MONT19T	MONITOR (19" TOUCHSCREEN)	1
3	BU1002	MONITOR MOUNTING FRAME	1
4	BU7010	DECAL - MONITOR BEZEL	1
5	6433	BHCS, #8-32 x .50" LG. (ZINC)	8
6	6004a	8-32 KEP NUT	12
7	2764	SMALL AC FAN	1
8	E2364G	FAN GUARD (FG-8) METAL 80MM (ROHS)	2
9	3079	GROMMET (BP2 - PUNCHED)#853118	1
10	FP2007	SPEAKER (4" ROUND) 60-9240	2
11	SK624	6-32 KEP NUT	8
12	6146	6-32 x 2" LG. PPHMS	4
13	6002A	6-32 NYLOCK NUT	4
14	3030	SCREW CAP (SC-1BK)	6
15	6676	#8-32x.75" LG. PPHMS	6
16	BU3001 CUTOUT	BODY-CHEST CUTOUT/HOLE PATTERN	1
17	BU3002	MONITOR SPACER	1
18	PX4001	GASKET (C)	1
19	BU7010M	GRAPHIC BEZEL	1



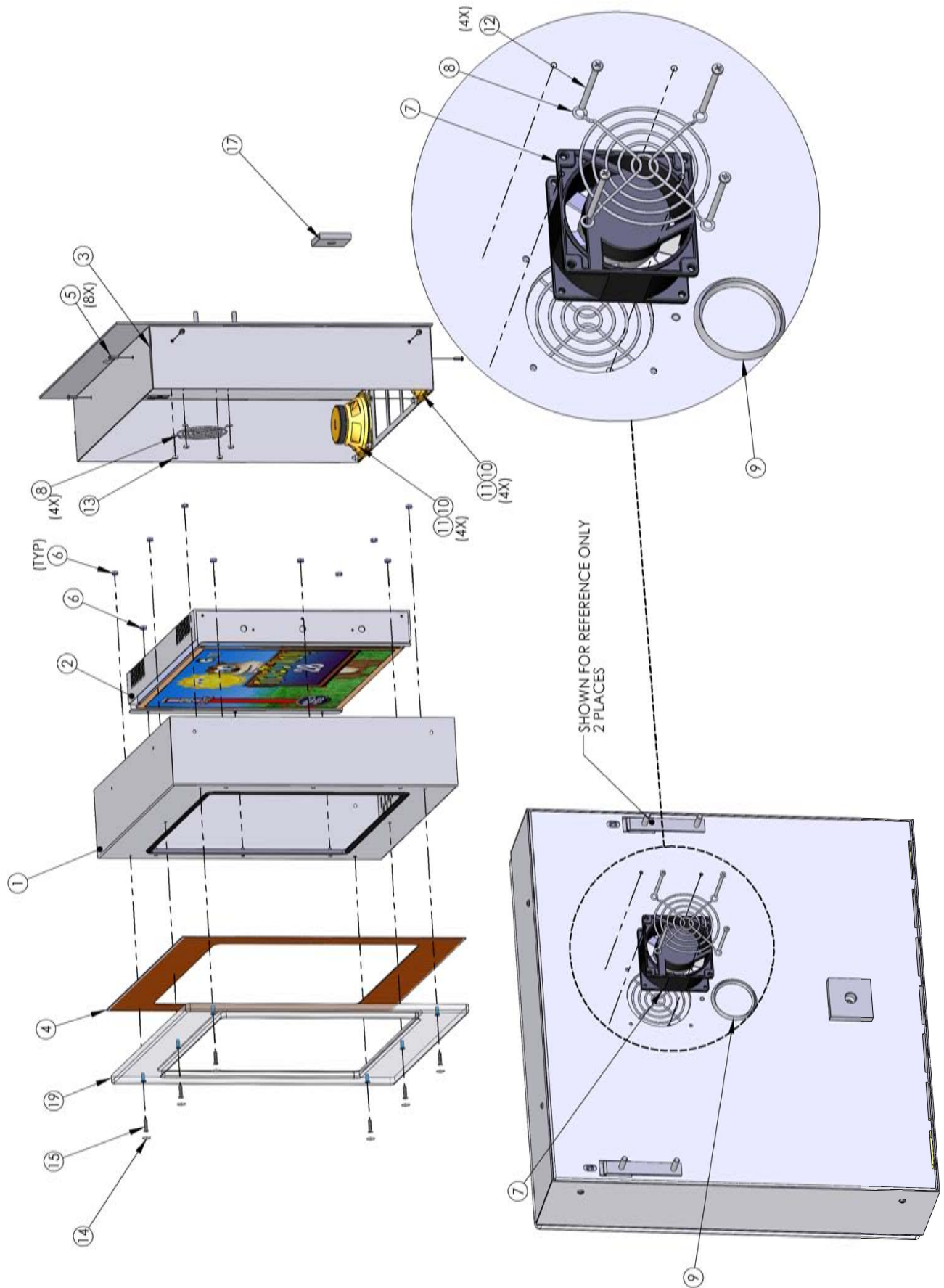

ITEM NO.	PART NUMBER	DESCRIPTION	QTY.
1	BU3052	REAR ACCESS DOOR	1
2	5014	7/8" CAMLOCK	1
3	BU3090	REAR ACCESS DOOR CLEAT	1
4	BU3091	REAR ACCESS CLEAT SPACER	1
5	E02027G	FAN FINGER GUARD	1
6	E02027FL	FAN FILTER 120MM	1
7	655S	#8 x 5/8 SQ. DRIVE (SILVER)	4
8	6267	#8 X 5/8 PHILLIPS FLAT HEAD (ZINC)	4
9	6166	DRYWALL SCREW 1-1/2"	4

DWG. NO.: BU3052CX  
1 of 1  
REV: A

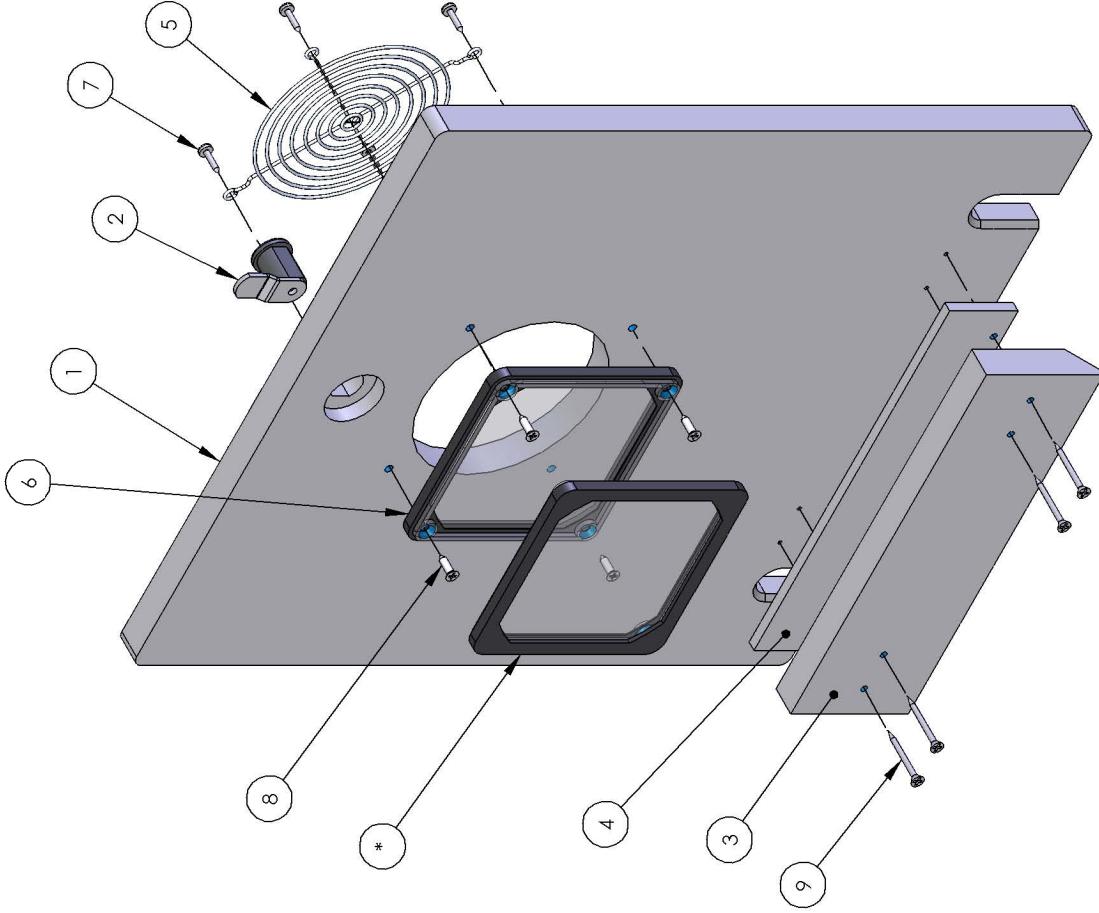

EXPLODED VIEW

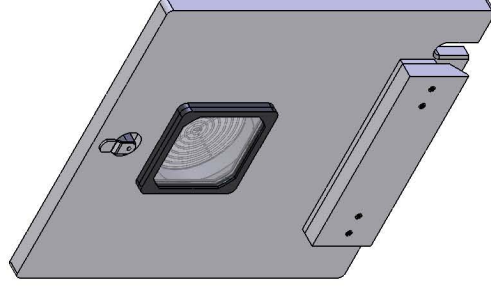

ISO VIEW

ITEM NO.	PART NUMBER	DESCRIPTION	QTY.
1	BU3054	PC MOUNTING PANEL	1
2	FP1004	LEG'S MOUNTING PLATE	2
3	655	#8 x 3/4 SQ. DRIVE (BLACK)	16
4	6061	8-32 CAB INSERT (J-50111)	2
5	PC60631	025-20 CABINET INSERT (J50115)	2

DWG. NO.: BU3054X  
1 of 1  
REV. A

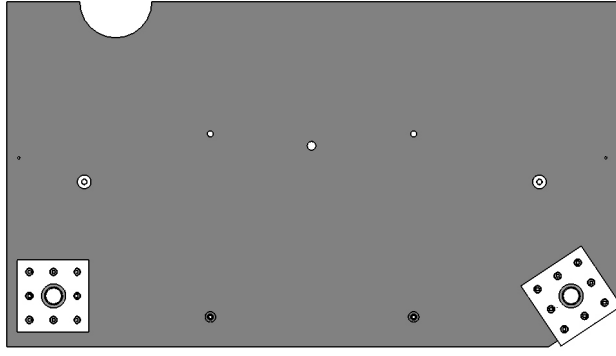
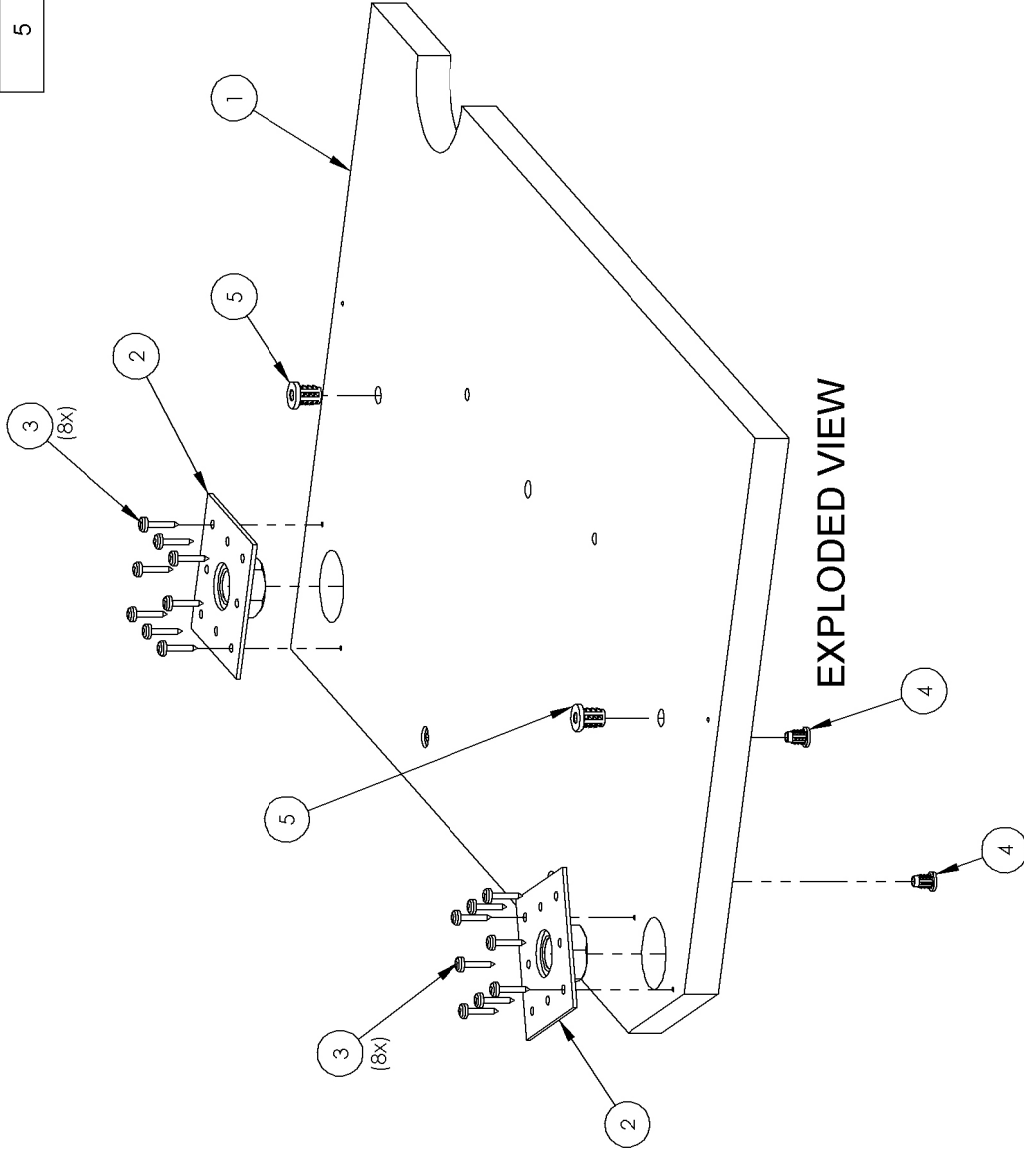

ITEM NO.	PART NUMBER	DESCRIPTION	QTY.
1	BU3054	PC MOUNTING PANEL	1
2	FP1004	LEG'S MOUNTING PLATE	2
3	6061	8-32 CAB INSERT (J-50111)	4
4	655	#8 x 3/4 SQ. DRIVE (BLACK)	16
5	DN4001	COMPUTER FOAM PAD	1
6	DN1015	COMPUTER STRAP	2
7	PC60618	8-32x7/8 PHMS	4
8	PC60631	025-20 CABINET INSERT (J50115)	2

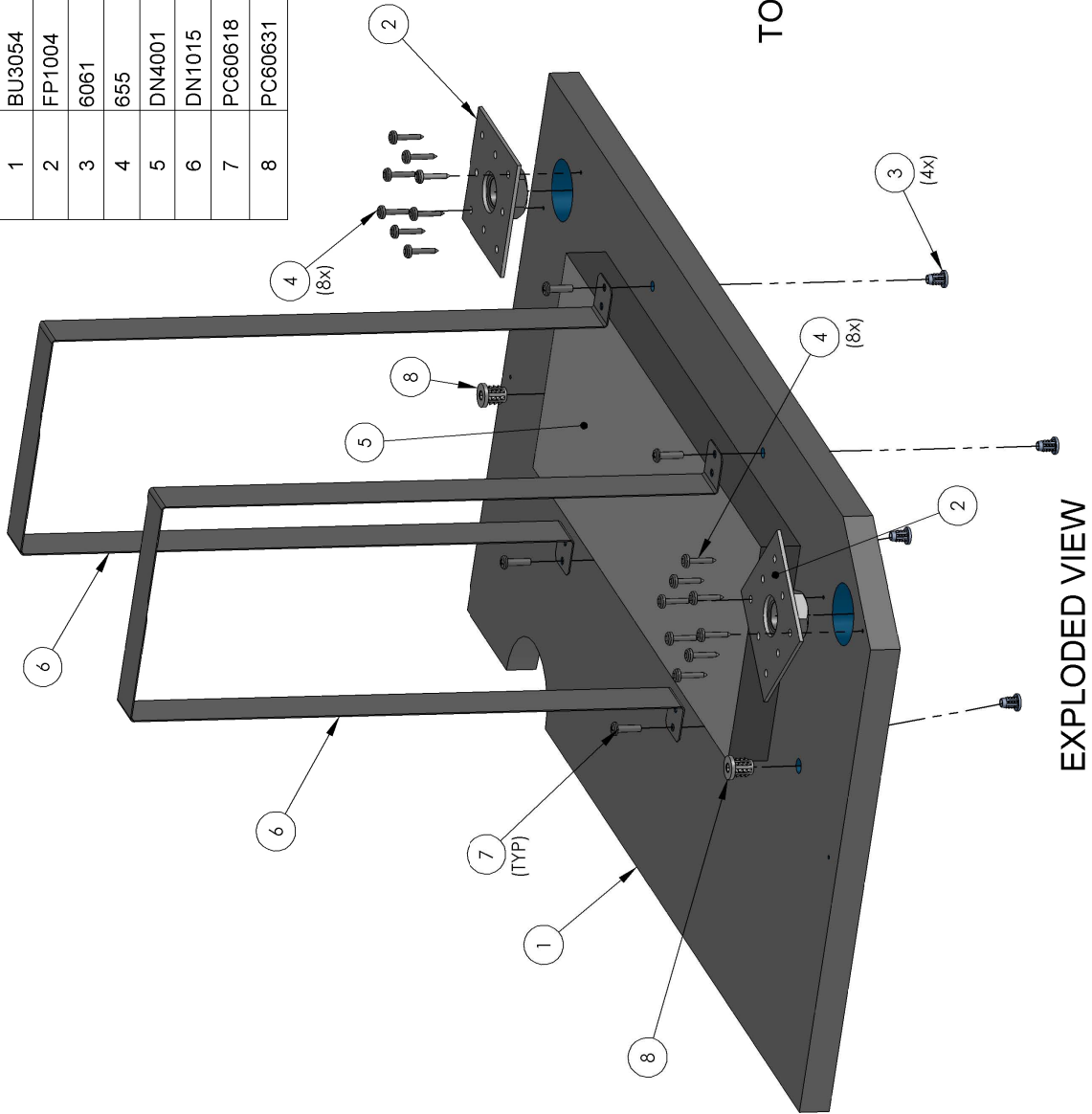

TOP VIEW

EXPLODED VIEW

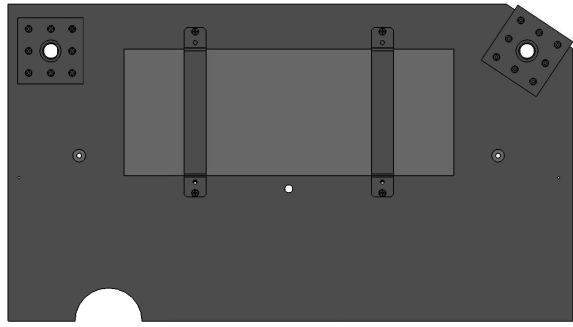

ITEM NO.	PART NUMBER	DESCRIPTION	QTY.
1	PC60641	6-32 x 5/8 HH SPACER 14HTSP020	4
2	BU3060	PCB MOUNTING BOARD	1
3	PC60628	6-32X1 3/4 PRHMS	4
4	BU3061	PCB FOOT	1
5	6019	#6 DRYWALL SCREW 1"	3
6	PC60643	6-32 x 1/4 HH SPACER 14HTSP007	4
7	DN2034X	PCBA JAMMA I/O BOARD	1

TITLE: ASSY- PCB MOUNTING BOARD	
PART NO.:	BU3060X
DESIGN:	1 of 1
DRAWN:	
SCALE: 2:1	
DWG. NO.:	REV. A

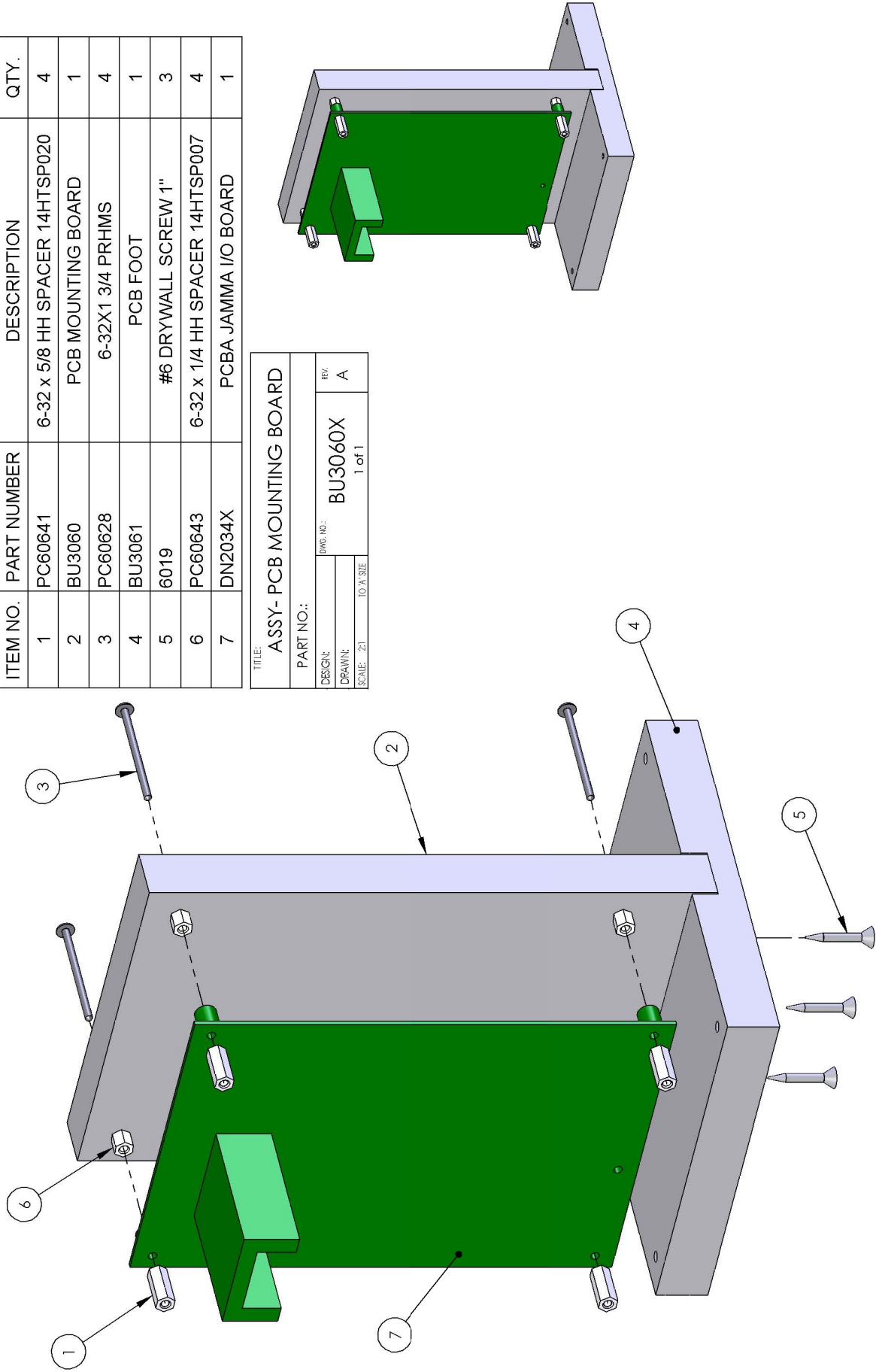

EXPLODED VIEW

COMPONENT SIDE		SOLDER SIDE	
GROUND	1	BLACK	GROUND
GROUND	2	BLACK	GROUND
+ 5 VOLTS	3	RED	+ 5 VOLTS
+ 5 VOLTS	4	DUMMY PIN	+ 5 VOLTS
	5	DUMMY PIN	
+ 12 VOLTS	6	ORANGE	+ 12 VOLTS
KEY	7	KEY	KEY
COIN METER	8	white/yellow	TICKET ENABLE
RESET	9	VIOLET	TICKET METER
L SPEAKER +	10	red/grey	L SPEAKER -
R SPEAKER +	11	red/white	R SPEAKER -
VIDEO RED	12	DUMMY PIN	VIDEO GREEN
VIDEO BLUE	13	DUMMY PIN	VIDEO SYNC
VIDEO GROUND	14	DUMMY PIN	SERVICE SWITCH
TEST SWITCH	15	white	
COIN 1	16	white/brown	COIN 2
TICKET NOTCH	17	violet/blue	
	18	DUMMY PIN	
	19	DUMMY PIN	
	20	DUMMY PIN	
	21	DUMMY PIN	
	22	DUMMY PIN	
	23	DUMMY PIN	
VOLUME UP	24	white/blue	VOLUME DOWN
PROGRAM	25	DUMMY PIN	
	26	DUMMY PIN	
GROUND	27	black	GROUND
GROUND	28	black	GROUND
			A
			B
			C
			D
			E
			F
			H
			J
			K
			L
			M
			N
			P
			R
			S
			T
			U
			V
			W
			X
			Y
			Z
			a
			b
			c
			d
			e
			f

# Parts List

## Electronics:

1029WSX	Asy Reset Button
BU2007X	Asy (Power Mod 4 Amp)
E00038	Fuse 4 Amp 250v Slow Blow
E02062	Fuse 5A
E02258	Fuse 2A
E00211	Switch (Low Ticket)
E02027FL	Fan Filter
BU2000X	Computer
DN2034x	PCBA Jamma I/O Board
FP2007	Speaker 4" Round
HH5005	Ticket Dispenser
MON19T	Monitor (19" Touch screen)
MS2764X	Asy (Small Fan)

## Decals:

7989	ICE Website Logo
BU7009	Decal – Tickets
BU7010	Monitor Bezel
BU7011	Decal – Eyes
BU9001	BU Service Manual

## Mechanical:

BU3001	Squirrel Fiberglass
BU3052	Rear Access Door
DN4001	Computer Foam
WA5001	Coin Door (Triple) Dual Mech
WS1022	Ticket Bin (Single)

# Warranty

I.C.E warrants all components in the **Buster Bubble** game to be free of defects in materials and workmanship for a period of ninety days from the date of purchase.

This warranty does not cover items damaged due to normal wear and tear, subjected to abuse, improperly assembled by the end user, modified, repaired, or operated in a fashion other than that described in the service manual.

If your **Buster Bubble** game fails to conform to the above mentioned warranty, I.C.E.'s sole responsibility shall be at its option to repair or replace any defective component with a new or remanufactured component of equal to or greater O.E.M. specification.

I.C.E. will assume no liability whatsoever, for costs associated with labor to replace defective parts, or travel time associated therein.

I.C.E.'s obligation will be to ship free of charge, replacement parts by domestic U.P.S. Ground, U.S. mail, or other comparable shipping means. Any express mail or overnight shipping expense is at the cost of the purchaser.

Products will be covered under warranty only when:

- The serial number of the game with the defective parts is given.
- The serial number of the defective part, if applicable, is given.
- A Detailed Description of the Equipment Fault Symptoms
- Defective parts are returned to I.C.E., shipping pre-paid, in a timely fashion, if requested by I.C.E.
- A copy of the sales receipt is available as proof of purchase upon request of I.C.E.

I.C.E. distributors are independent, privately owned and operated. In their judgment, they may sell parts or accessories other than those manufactured by I.C.E. We cannot be responsible for the quality, suitability, or safety of any non-I.C.E. part, or any modification, including labor, which is performed by such a distributor.





# WARRANTY

ICE product, including Cromptons, Sam's Billiards, Uniana and Bell Fruit is warranted as follows:

- 180 days on the Main PCB and Computers
- 180 days on Motors
- 90 days on all other components (i.e. DBV's, Ticket Dispensers, etc)
- 30 days on repaired items
- 3 years on all Crane Harnessing
- 9 Months on Printers

ICE Inc shall not be obligated to furnish a warranty request under the following conditions:

- Equipment has been subjected to unwarranted stress through abuse or neglect
- Equipment has been damaged as a result of arbitrary repair/modification attempts
- Equipment that has failed through normal wear and tear

19" LCD panel, touch screen, and controller carry a limited 6 month warranty. This warranty covers only failures due to defects in materials or workmanship that occur in normal use. It does not cover damage that occurs in shipment, failures that are caused by products not supplied by ICE, Inc., failures that result from accident, misuse, abuse, neglect, water damage, mishandling, faulty installation, set-up adjustments, improper maintenance, alteration, line power surge, external product damage including field damage, modification or service not approved by ICE or damage that is attributable to acts of God. I.C.E. strongly recommends that the product be adequately packed to avoid shipping damage.

ICE Inc will assume no liability whatsoever for costs associated with labor to replace defective parts or travel time associated therein.

All defective warranty covered components will be replaced with new or factory refurbished components equal to OEM specifications. ICE Inc will cover all domestic UPS ground, or comparable shipping means, freight costs during the warranty period. Expedited shipments are available for an additional charge.

Defective parts are returned to ICE Inc, at the customer's expense, in a timely fashion.

ICE distributors are independent, privately owned and operated. In their judgment, they may sell parts and/or accessories other than those manufactured by ICE Inc. We cannot be responsible for the quality, suitability or safety of any non-ICE part, modification (including labor) that is performed by such a distributor.

I.C.E. Parts/Service Dept.  
Innovative Concepts in Entertainment  
10123 Main St.  
Clarence, NY 14031  
Phone #: (716) - 759 - 0360  
Fax #: (716) - 759 - 0884