

Teenage Mutant Ninja Turtles™

Operator's Manual



©2017 Viacom International Inc. All Rights Reserved. Nickelodeon, Teenage Mutant Ninja Turtles and all related titles, logos and characters are trademarks of Viacom International Inc. ©2017 Viacom Overseas Holdings C.V. All Rights Reserved. Teenage Mutant Ninja Turtles and all related titles, logos and characters are trademarks of Viacom Overseas Holdings C.V. Nickelodeon and all related titles, logos and characters are trademarks of Viacom International Inc. Software™ & © 2017 Raw Thrills, Inc. All Rights Reserved.

Teenage Mutant Ninja Turtles™

Table of Contents

Safety	5
Operation	5
Transporting	5
Handling Components	5
Disconnect Power	5
Grounding	5
Electrical Shocks	5
Monitor	5
Power Selector	5
Power Cord	5
Surge Suppressor	6
Water and Other Liquid Sources	6
Connectors	6
Computer	6
Tempered Glass Warning	6
Hazard to Epileptics	6
Manual	6
Specifications	6
Product Specifications	7
Electrical Power	7
Temperature	7
Humidity	7
Dimensions	7
Fuse Replacement Guide	7
Setup	8
Unpack Materials	8
55" Cabinet Assembly	9
Card Reader Installation and Setup	10
Check Electrical Settings	11
Startup Game	11
Diagnostics and Adjustments	12

Teenage Mutant Ninja Turtles™

Basic Functional Test on Initial Power Up.....	12
Test Menus.....	13
Choosing the Right Pricing Adjustments for Your Location	19
PC Hardware	20
PC Hard Drive Recovery	22
Troubleshooting.....	23
Technical Support	27
Electrical and Mechanical Illustrations	28

Teenage Mutant Ninja Turtles™

Safety

Operation

Before operating game, read this manual. Failure to properly install and operate this game could result in malfunction or accident. Operate the game in accordance with the manual.

Transporting

The cabinet is very heavy. Because the monitor is high, the cabinet is also very top-heavy. Use appropriate care when moving or transporting cabinet. It contains fragile glass and electronic components. Avoid rough handling.

Handling Components

Many components are extremely sensitive to handling, environmental and Electrostatic Discharge (ESD) events—especially the computer. Do not handle it roughly. Before servicing, call your distributor and inquire about the PC warranty. Use proper ESD procedures when servicing. Protect components from harmful environmental conditions, such as extreme temperatures, excessive moisture or other damaging effects.

Disconnect Power

Always turn the power off and unplug the unit before servicing or making adjustments unless otherwise instructed. Installing or repairing components while power is on can damage the components and void the warranty.

Grounding

Avoid electrical shock. Do not plug in AC power until you have inspected and properly grounded the unit. Only plug into a grounded, three-wire outlet. Do not use a “cheater” plug or cut off the ground pin on the line cord.

Electrical Shocks

There is no isolation transformer in the cabinet. Disconnect AC power before servicing. However, be aware that lethal voltages can remain in the electronic components even when AC power is disconnected. Use extreme caution when servicing. Verify that there is a working ground connection. If the unit sustains water damage, cease using it immediately and unplug AC power.

Monitor

The monitor contains no user serviceable parts. Do not attempt to service the monitor.

Power Selector

Before installing game, ensure the voltage on the PC and power supply is set properly. There is a 115/230 VAC selector switch that must be set for the correct voltage for your site. The setting must match the line voltage at the installation site.

Power Cord

If the power cord is damaged or lost, replace it with an identical cord as supplied by the manufacturer or an authorized service agent.

Teenage Mutant Ninja Turtles™

Surge Suppressor

It is recommended that you plug your game's power cord into a surge suppressor to help protect from power surges that may damage sensitive electronic components.

Water and Other Liquid Sources

Do not install game near sprinkler or other water jet sources. Do not use water jet to clean game. Keep minimum clearance behind game and wall for proper ventilation but also prevent access of liquid from spills and sprays from entering ventilation holes.

Connectors

When servicing machine, ensure all connectors mate properly. If connectors do not slip in easily, do not force them. Connectors are often keyed and only connect one way. Check for correct orientation.

Computer

The computer contains sensitive components, including a hard drive. Do not handle it roughly. Call your distributor before servicing its internal components. Ask about warranty information as it relates to the PC.

Cycle AC power on or off with the cabinet power switch.

A dongle has been inserted into one of the USB ports. This is required for game play.

Do not remove the dongle except for troubleshooting purposes.

Tempered Glass Warning

When handling the LCD display glass cover take special care and set the glass down softly on a flat surface free of debris. The edge of the glass is sensitive to hard impact. Shattered glass from the monitor can travel long distances and cause bodily injury. Use proper procedures when handling broken materials.

Hazard to Epileptics

A small portion of the population has an epileptic condition that may cause seizures. Affected persons experience seizure while watching some television pictures or playing certain video games. People who have not had seizures may still have an undetected epileptic condition. If anyone in your family has experienced epilepsy symptoms (seizures or loss of awareness), consult your physical before using video games. While children play video games, a parent should observe. Be alert to the following symptoms: dizziness, altered vision, eye or muscle twitching, involuntary movements, loss of awareness, disorientation or convulsions. If you or your child experiences these symptoms, discontinue use immediately and consult your physician.

Manual

Keep this manual available and ready for use. If the game fails to function properly, turn off the machine and unplug the AC line cord. Contact your local distributor. Your warranty, when applicable, lasts 60 days from your purchase date. You may not reproduce this document or any of its contents without written authorization from Raw Thrills, Inc. or Play Mechanix™ Inc.

Specifications

For reasons such as performance, this product's specifications may change without notice. Federal patent, copyright and other intellectual property laws protect the content, devices and design of the game and its equipment.

Teenage Mutant Ninja Turtles™

Product Specifications

Electrical Power

United States, International and Japan

Operating AC Current: 5/2.5 Amps

Voltage: 115/230 ~ VAC 50/60Hz

Inrush AC Current: 5 Amps

Temperature

50° F to 104° F

(10° C to 40° C)

Humidity

Must not exceed 95% relative humidity

Dimensions

Assembled

Height: 104.25" (2.65 meters)

Width: 54.75" (1.39 meters)

Depth: 32.50" (0.83 meters)

Fuse Replacement Guide

NOTE: FOR CONTINUED PROTECTION AGAINST
FIRE AND ELECTRICAL DAMAGE, USE ONLY
SPECIFIED FUSE TYPE AND VALUE.

12V Power Distribution:

5A 250V SLO-BLO (x7)

Teenage Mutant Ninja Turtles™

Setup

Unpack Materials

1. Place the shipping crates on a flat, stable surface.
2. Cut the banding straps and remove the cardboard lids.
3. Lift off the large cardboard containers surrounding the cabinet assembly and remove any shipping cleats.
4. Remove the coin door key from the coin return slot.
5. Open the top coin door.
6. Locate the keys for the back door and the cash box door.
7. Open the cash box door and remove the cash box.
8. Check for shipping damage to the following:
 - Marquee and monitor
 - Cabinet decals
9. Check the AC line cord for visible signs of damage.

Pay particular attention to the plug and line cord insulation.

Marquee Assembly can tip forward and cause damage. Take care when removing assembly from box and when installing atop cabinet to ensure that the assembly doesn't fall forward. Tighten all screws securely.

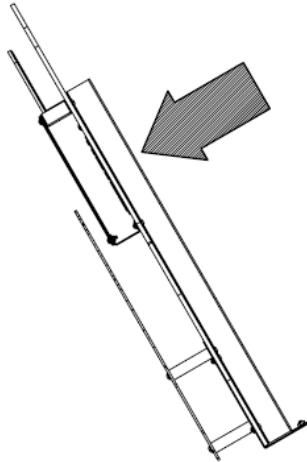

Teenage Mutant Ninja Turtles™

55" Cabinet Assembly

Note: 2 people are required, and ladders are recommended. Marquee assembly is **top heavy and can tip over!**

1. Place cabinet in desired floor location. Remove upper back door and carefully place such that it will not fall over or be damaged. Set up ladders next to the cabinet for marquee installation.
2. Locate the marquee assembly as well as the following hardware:
 - a. (6) black tamper proof Torx machine screws, ¼ - 20 thread, 1-1/2" long
 - b. (6) ¼" black split lock washers
 - c. (6) ¼" black flat washers
3. Using a T-27 bit, securely mount the marquee assembly atop the cabinet as shown in the assembly setup diagram, avoiding any pinching/crushing of the wire harness which should pass through the access hole. Connect marquee harness to cabinet harness, accessible through upper door.

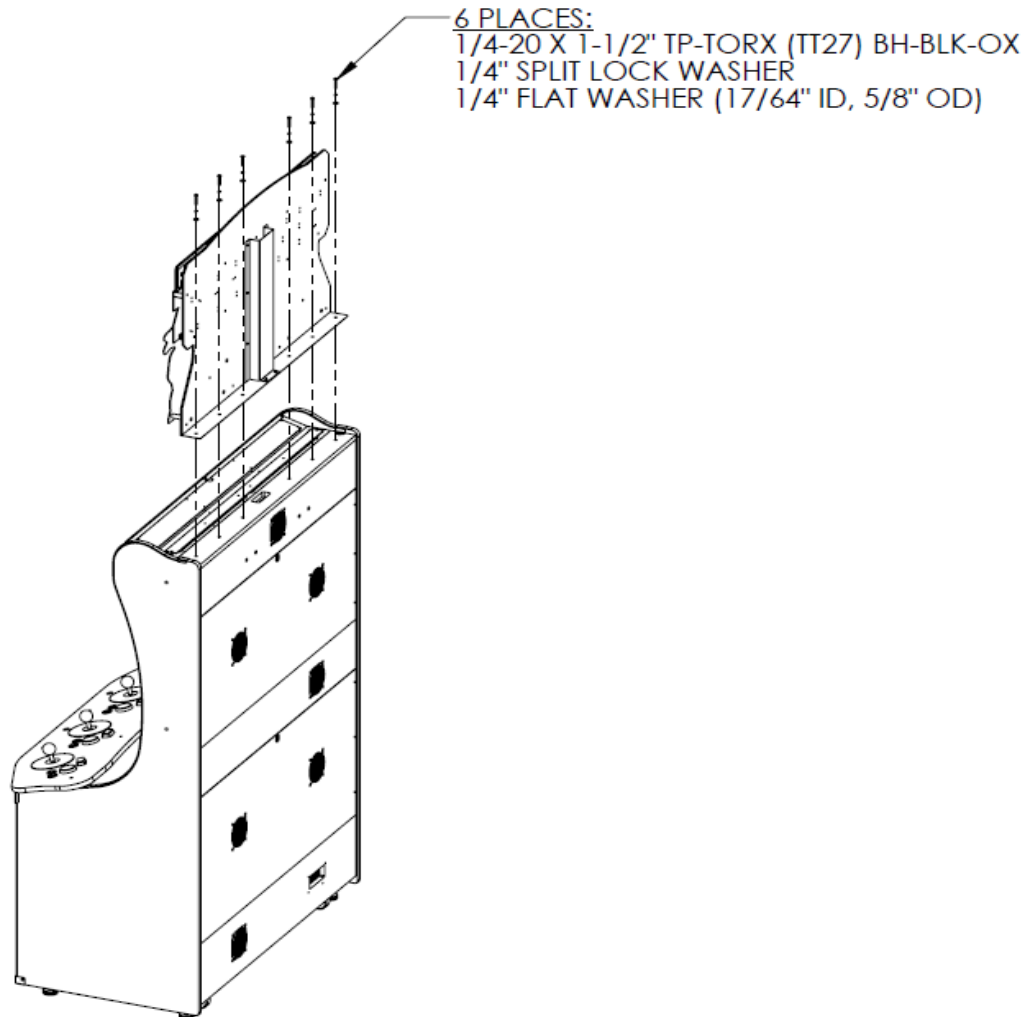

Teenage Mutant Ninja Turtles™

Card Reader Installation and Setup

Due to the rising popularity of aftermarket debit card systems for cashless or coinless operation of amusement machines (i.e. Embed, Intercard, Semnox), this Teenage Mutant Ninja Turtles cabinet is equipped with UCL compatible harnessing to ensure that the installation process is easier and less prone to miswiring.

You can choose to use 1 or 4 card readers in the pricing adjustments section of the test menu. It is recommended to use 4 card readers for best results and player access.

There are (4) supplied connections, each located under the control panel near the player positions. There is enough slack to accommodate mounting (4) card readers on the control panel, as shown below, or on the front panels, as each operator desires.

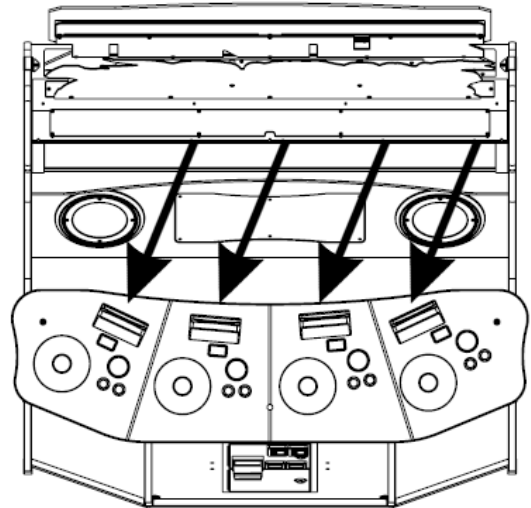
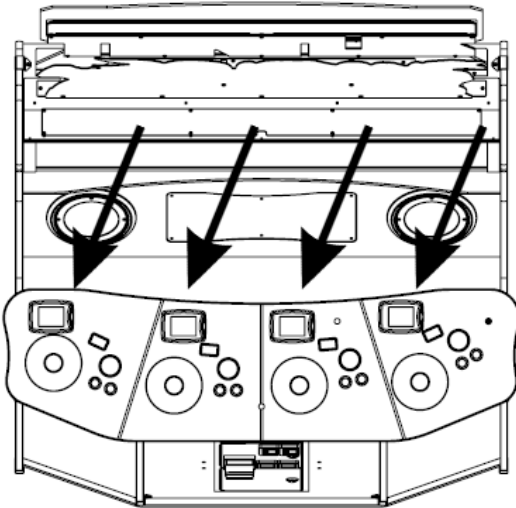

Teenage Mutant Ninja Turtles™

If only (1) card reader will be used, it is recommended that the card reader be mounted to the coin door as shown below, using either the Player 2 or Player 3 UCL connector due to their proximity to coin door, although any UCL connection can be used for games equipped with only (1) card reader.

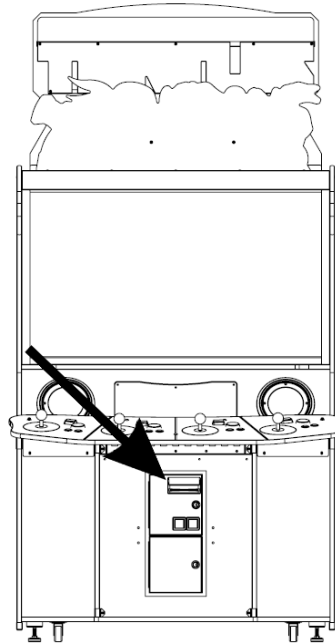

Check Electrical Settings

1. Verify the voltage in the nearest AC outlet.
2. Verify the AC outlet ground connection is present and working.

Startup Game

1. Plug the line cord into an AC outlet.
2. Turn the main cabinet power switch on.
3. Verify the game and all components are operating normally. See *Basic Functional Test on Initial Power Up* in the *Diagnostics and Adjustments* section for the recommended procedure.

Teenage Mutant Ninja Turtles™

Diagnosics and Adjustments

The Service Button Panel has four buttons, three of which can navigate the menu system.

The control panel buttons and joysticks can also advance through test menu screens.

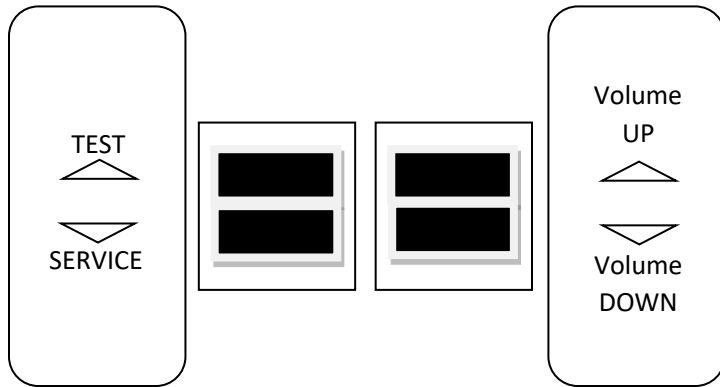

Navigating the Test Menu	
Button	Action
TEST/BACK (Not in Test Menu)	Enters Test Menu
TEST/BACK (In Test Menu)	Selects Highlighted Option
SERVICE (On Main Menu)	Exits Test Menu
SERVICE (Not on Main Menu)	Cancels Selection
VOLUME UP	Move Up
VOLUME DOWN	Move Down
Start Buttons	Selects Highlighted Option

An on-screen message acknowledges changes or when you exit a selection without making a change.

Basic Functional Test on Initial Power Up

See the Diagnostic Section for further information.

1. Enter the Switch Test menu and verify all switches function.
2. Enter the Sound Test menu and verify the audio works and is not distorted.
3. Enter the Coin Meter Test menu and verify the operation of the coin meter.
4. Enter the Cabinet Lamps Test menu and verify that all cabinet lights work correctly.
5. Enter the Watchdog Test menu, which reboots the game.
6. Upon a successful reboot, you are ready to adjust pricing, volume and other functions found in the Adjustments, Audits, and Diagnostics section.

Teenage Mutant Ninja Turtles™

Test Menus

Main Menu

Choose from all available operator settings and menus here. You can use the test menu bracket and volume buttons to navigate. The joysticks, jump and attack buttons, and start buttons also are available to use for easier navigation through these menus.

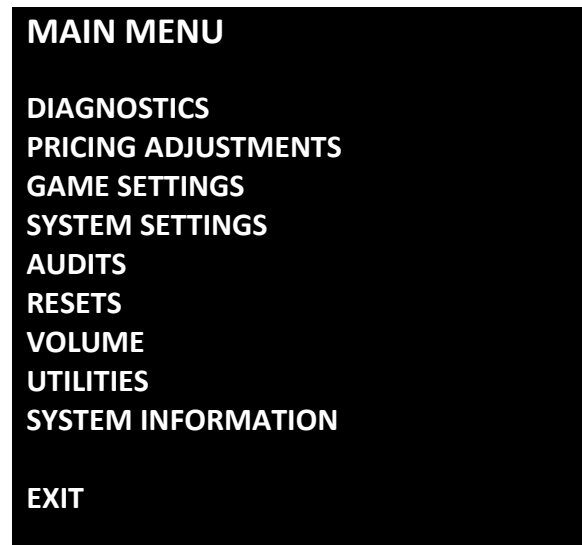

Diagnostics

This menu allows all game functions to be verified or diagnosed. You can improve collections by periodically verifying proper game function and operation. This includes periodic Hard Drive checks to verify that software has not been corrupted or reporting an error.

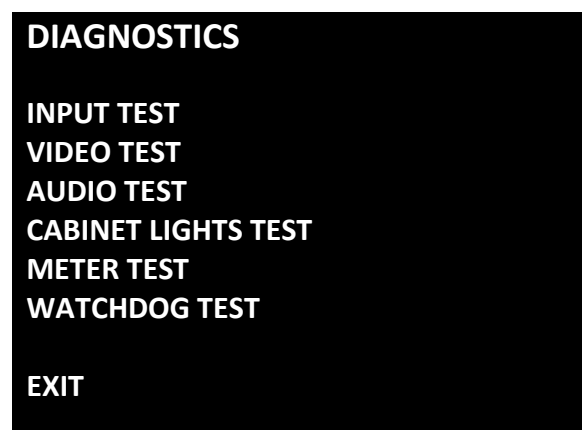

- **Input Test:** Test all the switches on the game
- **Video Test:** Checks color pattern of monitor
- **Audio Test:** Tests audio from speakers
- **Cabinet Lights Test:** Test all cabinet lighting
- **Meter Test:** Tests functionality of “hard meter”
- **Watchdog Test:** Tests functionality of watchdog (if working properly, game will reboot)

Teenage Mutant Ninja Turtles™

Pricing Adjustments

This allows customization of coin values, currency denominations, bill pulse, and swipe value.

Pricing Adjustments: Coins Active (Default)

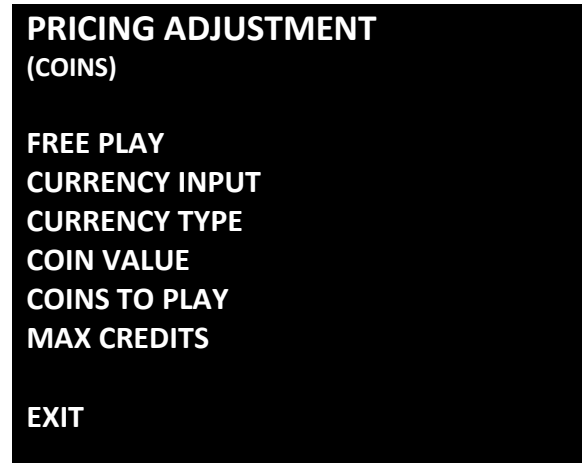

- **Free Play:** No coins or swipes needed to play
- **Currency Input:** Choose between: Cash, Tokens, or Card Swipes
- **Currency Type:** Choose between: US Dollars, Euros, etc
- **Coin Value:** Money value of a coin
- **Coins To Play:** Number of coins per credit
- **Max Credits:** Adjust the maximum number of credits

Pricing Adjustments: Swipes Active



- **Free Play:** No coins or swipes needed to play
- **Currency Input:** Choose between: Cash, Tokens, or Card Swipes
- **Currency Type:** Choose between: US Dollars, Euros, etc
- **Swipe Value:** Money value of a swipe
- **Swipes To Play:** Number of swipes per credit (Locked setting at 1 swipe per play)
- **Max Credits:** Adjust the maximum number of credits
- **Number Of Card Readers:** Sets 1 or 4 card readers

Teenage Mutant Ninja Turtles™

Pricing Adjustments: Tokens Active

PRICING ADJUSTMENT

(TOKENS)

FREE PLAY

CURRENCY INPUT

CURRENCY TYPE

COIN VALUE

COINS TO PLAY

MAX CREDITS

EXIT

- **Free Play:** No coins or swipes needed to play
- **Currency Input:** Choose between: Cash, Tokens, or Card Swipes
- **Currency Type:** Choose between: US Dollars, Euros, etc
- **Coin Value:** Money value of a token.
- **Coins To Play:** Number of tokens per credit
- **Max Credits:** Adjust the maximum number of credits

Teenage Mutant Ninja Turtles™

Game Settings

This menu allows for customization of game settings.



- **Target Cycle Time**: Set your targeted cycle time. Game defaults to 120 seconds which is the recommended setting. (Cycle time is the time it takes from the beginning of a player's credit to the end of the player's credit.)

System Settings

This menu allows for customizations of various system settings.

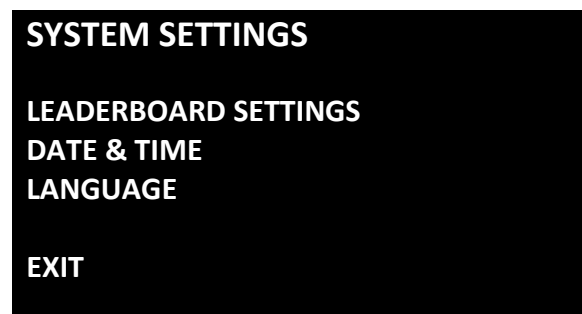

- **Leaderboard Settings**: Allows you to turn high score leaderboards on and off. ON is the default and recommended setting.
- **Date & Time**: Set date & time.
- **Language**: Set game language (default: English).

Teenage Mutant Ninja Turtles™

Audits

Audit screens help assess game performance, find intermittent problems, decide whether to adjust game difficulty and free game award and help maximize game earnings.

AUDITS

SYSTEM AUDITS

COIN AUDITS

GAME AUDITS

EXIT

- **System Audits:** Logged information including boots, resets, game times, and more
- **Coin Audits:** Tracks income related information, coin slot usage, dollar bill usage, and more
- **Game Audits:** Tracks the gameplay habits of your customers. Average scores, bonuses, and more.

Resets Menu

Resets menu allows for resetting of various settings and adjustments.

RESETS MENU

RESET CREDITS

RESET PRICING ADJUSTMENTS

RESET GAME ADJUSTMENTS

RESET LEADERBOARDS

RESET GAME AUDITS

RESET SYSTEM AUDITS

RESET COIN AUDITS

RESET ALL AUDITS

FACTORY RESTORE

EXIT

- **Reset Credits:** Reset credits to zero (0)
- **Reset Pricing Adjustments:** Resets pricing to default settings
- **Reset Game Adjustments:** Resets game adjustments to default settings
- **Reset Leaderboards:** Resets leaderboards to default settings
- **Reset Game Audits:** Clears the game audits log file
- **Reset System Audits:** Clears the system audits log file
- **Reset Coin Audits:** Clears the coin audits log file
- **Reset All Audits:** Clears the all audits log files
- **Factory Restore:** Resets system to original factory settings and defaults

Teenage Mutant Ninja Turtles™

Volume

VOLUME	
GAME VOLUME	17/30
ATTRACT VOLUME	7/30
CREDIT VOLUME	17/30
MINIMUM VOLUME	17/30
EXIT	

- **Game Volume:** Adjusts the volume level during gameplay
- **Attract Volume:** Adjusts the volume during the attract mode sequences
- **Credit Volume:** Adjusts the volume level of the credit chime only (Independent setting of game and attract volume)
- **Minimum Volume:** Adjusts the minimum floor the volume can be lowered

Utilities Menu

Allows for copying and viewing of audits and system/error logs.

UTILITIES MENU	
COPY AUDITS, LOGS, & SCORES TO USB	
VIEW MESSAGE LOG	
VIEW ERROR LOG	
EXIT	

- **Copy Audits, Logs, & Scores to USB:** Allows you to download your audits to an easy to read text file (.TXT) on a USB flash drive
- **View Message Log:** Allows you to view the audits without having to save them to USB
- **View Error Log:** Allows you to view the error log without having to save it to USB

System Information

This screen allows you to see various information about the software and hardware.

- Serial Number
- Software Revision
- Build Date
- Cabinet Type
- Game Template

Teenage Mutant Ninja Turtles™

Choosing the Right Pricing Adjustments for Your Location

Card Swipe Locations

- Make Sure Your Game is Set to **Swipes Mode**:
 1. Hold the Test Button for 2 seconds to enter the Test Menu.
 2. Select “Pricing Adjustments” from the menu.
 3. Select “Currency Input” from the menu.
 4. Select “Swipes to Play” from the menu.
 5. Set “Swipe Value” to the currency equivalent of your swipe, or the payout will be incorrect. **THIS SETTING IS EXTREMELY IMPORTANT!** (Example: If the card swipe is worth \$1.50 in your card system, set the swipe value to \$1.50 as well).

Coin Locations

- Make Sure Your **Pricing & Coin Value** are Correct:
 1. Hold the Test Button for 2 seconds to enter the Test Menu.
 2. Select “Pricing Adjustments” from the menu.
 3. Select “Coins to Play” and set the desired amount of coins per game of Teenage Mutant Ninja Turtles.
 4. After setting the coins per play, set “Coin Value” to the currency equivalent of your coin, or the payout will be incorrect. **THIS SETTING IS EXTREMELY IMPORTANT!** (Example: If your coin is worth \$0.25, set “Coin Value” to \$0.25 as well).

Teenage Mutant Ninja Turtles™

PC Hardware

Your Teenage Mutant Ninja Turtles™ uses a HP Elitedesk 705 G3 MT computer with a GeForce GTX 1050 graphics card.

Listed below are the recommended BIOS settings for the computer.

NOTE 1

The computer shipped with the correct BIOS settings. Making changes to the BIOS different from the settings listed below may adversely affect the game's functionality.

NOTE 2

In the event your video card needs to be replaced, any brand of GeForce GTX 1050 will work.



(HP Elitedesk 705 G3 MT)

Teenage Mutant Ninja Turtles™

HP Elitedesk 705 G3 MT BIOS

To Access BIOS Settings:

With the computer powered off, plug a USB keyboard into an open USB slot. Hold the 'F10' key and turn the computer on. Continue holding the F10 key until the BIOS Setup screen appears.

Note: All settings not listed should remain their default values.

Advanced

- Boot Options
 - After Power Loss [POWER ON]
 - UEFI Boot Order: [DISABLE]
 - Legacy Boot Order (defaults):
 - USB
 - SATA CD
 - STATO
 - NETWORK BOOT
- Built-in Device Options
 - Integrated Video: [DISABLE]

Note: After exiting BIOS settings screen, power cycle the cabinet by using the cabinet's main power switch.

Teenage Mutant Ninja Turtles™

PC Hard Drive Recovery

Symptoms requiring PC hard drive recovery include

- File Test reports bad or missing files.
- Game fails to finish loading during startup.
- After resetting the AC power, an error is reported.
- Erratic Game or Attract Mode.
- The following screen:

WARNING!

CRC File Missing! Reinstall Software!

File Damaged! Reinstall Software!

File Missing! Reinstall Software!

The only way to repair corrupt files is to reinstall the software as described below:

COMPUTER

The computer contains sensitive components. Do not handle roughly. Call your distributor before servicing its internal components. Ask about warranty information as it relates to the PC.

Do **not** use the PC on/off switch. Turn AC power on or off with the cabinet power switch.

Steps to Re-install the software:

(NO DVD Restoration. USB Thumb Drive is used on the *HP Elitedesk 705 G3 MT*)

1. With game and PC on, verify that the RIO board has power. If not, see Troubleshooting.
2. Open the coin door.
3. Insert the recovery USB thumb drive (included in your game) into the USB port on the Test button bracket inside the coin door.
4. Turn cabinet power switch to OFF. Wait 30 seconds.
5. Turn cabinet power switch to ON.
6. Select the *Teenage Mutant Ninja Turtles* restore version from the menu and follow on screen instructions.
7. If recovery does not begin, check to ensure USB Drive is inserted correctly and is not damaged.
8. Initial software loading may take several minutes. Check progress periodically.
Do not interrupt power or reset the game during recovery.
9. When software has been loaded, a message indicates that restore is complete. When instructed to remove USB Drive, wait 15 seconds to remove the drive from the PC.
10. Turn cabinet power switch off and then turn the cabinet on again. Your game will now be restored.

Teenage Mutant Ninja Turtles™

Troubleshooting

Warning: Review safety chapter before making any adjustments to game.

Problem	Possible Cause	Solution
Game will not power up.	Game not plugged in.	Plug game into AC outlet.
	Game not turned on.	Turn on main power switch.
	Game fuse is blown.	Check and replace fuse. See Specification section for fuse values.
	No power to receptacle.	Test AC outlet and plug game into powered outlet.
	PC BIOS set incorrectly.	See BIOS Settings section.
	Flash Drive Installer is left connected to PC.	Disconnect Flash Drive Installer and power cycle the game.
	Advertising USB flash drive left connected to PC.	Remove USB flash drive and power cycle the game.
Buttons or joysticks do not work.	Faulty micro switch.	Replace the micro switch on the button and re-test. Verify that the wires are connected to the correct spades on the micro switch.
	Faulty wiring.	Disconnect the cabinet from AC power. Verify that all wires are firmly connected to each button and the PCB. Verify that no wires are frayed or improperly shorting to ground. Verify that wires are connected to the correct spades on the micro switches.
	Faulty PCB.	Ensure all connections to PCB are secure. Replace PCB if faulty.

Teenage Mutant Ninja Turtles™

Problem	Possible Cause	Solution
Neither buttons nor audio work.	PCB connected to faulty USB port (boot message may indicate not detected).	To test a USB port, turn off the game, disconnect the device from the port, and then connect the game dongle to the port. Reboot the game. A No Dongle message indicates the port is bad. If the game starts, the port is working. After the test, reconnect all devices to the correct USB ports and reboot.
No sound or bad sound.	Bad connection.	Check connection to speakers.
	Volume set too low.	Use VOL UP button on Test panel to raise volume.
	Faulty wiring.	Verify all wires are firmly connected to the speakers, PCB, and green computer audio port. Verify that each wire is connected to the correct port and no wires are frayed or improperly shorting to ground.
	Blown speakers.	Remove the grill and inspect each speaker for visible damage. Run the Sound Test from System Tests in the Operator Menu to verify each speaker is working.
	Faulty PCB.	To verify audio is working at the computer, connect stereo headphones to the green computer audio port.
Constant low audio hum.	Faulty power supply.	Check external DC supply and the PC supply.
	Open ground.	Check all ground wires in cabinet. Ensure AC wall outlet is properly grounded

Teenage Mutant Ninja Turtles™

Problem	Possible Cause	Solution
Game does not load. PC Drive test reports “bad” or “missing” files. Game fails to finish loading. After resetting, game still reports an error. Erratic game mode or attract mode. WARNING! Data files Corrupted. (Game Operation May Become Unstable.) Use “Test” Switch to Enter Test Mode and Run “File Test.”	PC hard drive failure.	Recover hard drive. See Flash Installer Document or contact your distributor for the latest software revision.
Game Resets.	Bad file.	Run Flash Installer.
Coin meter does not click during test.	Faulty meter.	Replace coin meter.
	Blown fuse(s) on PCB.	Replace 12vdc 5A fuse(s) on PCB.
	No pulse to meter.	Check wiring from meter to PCB board.
Dongle Not Present.	Dongle missing or disconnected.	Find dongle cable and reseal in USB port.
	Faulty USB port.	Insert dongle cable in different USB port.
Improper number of credits given when coins or bills are inserted.	Incorrect setting in Pricing Adjustments.	Adjust pricing settings.
	Faulty wiring.	Disconnect cabinet from AC power. Verify wires are firmly connected to coin mech and bill validator and ground wires are properly connected. Verify no wires are frayed or shorting to ground.
	Faulty coin mech.	Verify coin mech is not jammed. Ensure coin mech is properly aligned and latched to coin door.

Teenage Mutant Ninja Turtles™

Problem	Possible Cause	Solution
No Video	PC not turned on.	Turn PC power switch on. Ensure IEC cable tightly plugged in. Trace cable back to source to ensure continuity.
	Video cable not secure.	Check and secure DVI connector to LED controller card. Check and secure DVI or HDMI connector to PC.
Connect RIO Board or RIO Board Missing.	USB cable disconnected.	Check USB connection from PC to RIO board.

Teenage Mutant Ninja Turtles™

Technical Support

For an authorized distributor near you, check the Raw Thrills website at www.rawthrills.com

Raw Thrills Technical Support Hotline

Phone: 1-800-753-2513

FAX: 1-201-438-5019

Email: rtsupport@betson.com

Teenage Mutant Ninja Turtles™

Electrical and Mechanical Illustrations

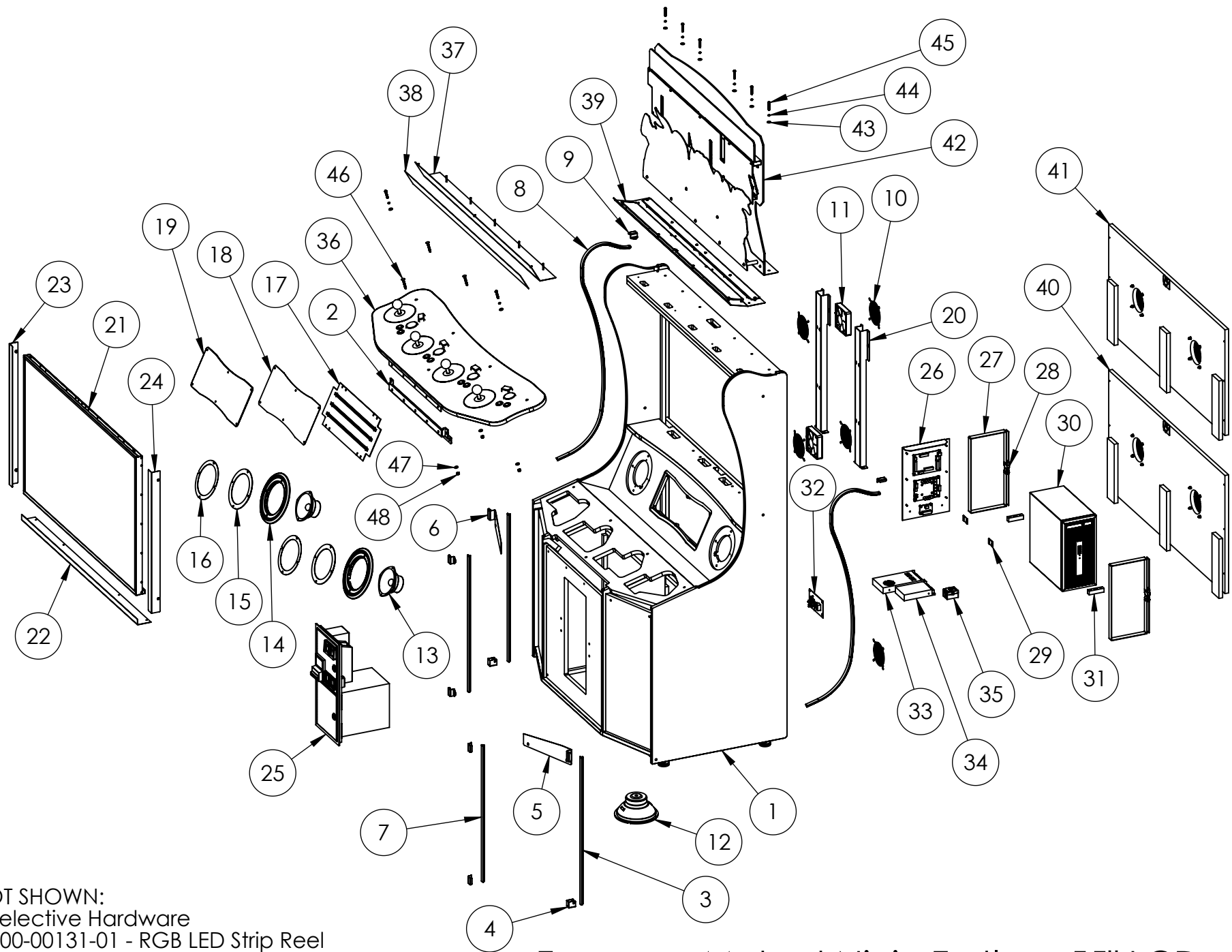

NOT SHOWN:

- > Selective Hardware
- > 500-00131-01 - RGB LED Strip Reel
 - 2X 70CM / 42 LEDs (installed in #7)
 - 2X 75CM / 45 LEDs (installed in #3)
 - 2X 140CM / 84 LEDs (installed in #8)

Teenage Mutant Ninja Turtles - 55" LCD
(BOM on next page)





ITEM NO.	PART NUMBER	DESCRIPTION	QTY.
1	601-00805-01	TMNT 55" Cabinet	1
2	600-02143-01	Hinge Mount Bracket	1
3	603-00718-01 (29.75in)	LED T-Molding Extrusion - 29.75"	2
4	600-02039-01	LED T-Molding Corner Clip	2
5	600-02037-01	LED T-Molding Angled Plate Right	1
6	600-02038-01	LED T-Molding Angled Plate Left	1
7	603-00718-01 (27.5in)	LED T-Molding Extrusion - 27.5"	2
8	603-00718-01 (55.625in)	LED T-Molding Extrusion - 55.625"	2
9	600-01942-01	LED T-Molding Clip	6
10	800-00001-00	120mm Wire Fan Guard	5
11	820-00001-00	Cooling Fan (standard size): 12VDC, 3W, 80CFM	2
12	2-1-18-00-00-000	8" Woofer, 4 Ohm, Poly-Mica Cone (Goldwood)	1
13	2-1-10-00-00-000	5.25", 8 Ohm Full Range Speaker (Goldwood)	2
14	TMNT_Speaker_Bezel_Assy	Speaker Bezel Sub-Assembly	2
15	600-02041-01	Sewer Speaker Grill	2
16	606-01346-01	Speaker Decal	2
17	TMNT_Mini_Marquee_Backlight_Assy	Mini Marquee LED Sub-Assembly	1
18	606-01330-01	Mini Marquee Translite	1
19	600-02043-01	Mini Marquee Lens PETG	1
20	600-01482-01	LCD Mounting Strut	2
21	809-00012-01	55" Open Frame LCD (with glass)	1
22	600-02091-01	Bottom Monitor Bracket	1
23	600-02092-01	Left Monitor Frame Bracket	1
24	600-02093-01	Right Monitor Frame Bracket	1
25	800-00005-01	Mid-Width Coin Door Assembly (Suzo-Happ)	1
26	TMNT_RIO2_Assembly	RIO2 Assembly w/ Mounting Plate	1
27	McMaster-Carr - 87425K76	Nylon Fabric Strip, Black, 1" Wide, .08" Thick (56" Length)	2
28	McMaster-Carr - 29705T86	Plastic Buckle, Black, Squeeze-Release, NO-Sew, for 1" Webbing	2
29	600-00891-01	Securing Nylon Strap Plate	2
30	850-00025-01	HP 705 G3 MT (310-0001-01: GTX 1050 Video Card)	1
31	601-00580-01	PC Wood Cleat	2
32	AC_Plate_Assy	AC Power Plate Assembly	1
33	500-00193-01	RSP-320-12: 320W, 12V PFC Dual Voltage Power Supply	1
34	330-00004-01	LRS-150F-12: 1500W, 12V Dual Voltage Power Supply	1
35	800-00040-01	Solid State Relay - 6210AXXSZS-DC3 / 6210DSX-1 (Magnecraft)	1
36	TMNT_CP_Assy	Control Panel Sub-Assembly	1
37	600-02055-01	Marquee Front Bracket	1
38	606-01341-01	Marquee Front Decal	1
39	TMNT_Marquee_LED_Light_Assy	Marquee Uplighting LED Sub-Assembly	1
40	TMNT_Lower_Back_Door_Assy	Lower Back Door Sub-Assembly	1
41	TMNT_Upper_Back_Door_Assy	Upper Back Door Sub-Assembly	1
42	TMNT_Marquee_Assy	Marquee Sub-Assembly	1
43	McMaster-Carr - 97416A119	Black-Oxide Steel SAE Flat Washer for 1/4" Screw Size, 0.281" ID, 0.625" OD	8
44	McMaster-Carr - 93711A500	Black-Oxide 18-8 Stainless Steel Split Lock Washer for 1/4" Socket Head Screws, 0.26" ID, 0.363" OD	8
45	McMaster-Carr - 96075A231	Black-Oxide Alloy Steel Tamper-Resistant Torx Rounded Head Screws, 1/4"-20 Thread Size, 1-1/2" Long	8
46	McMaster-Carr - 90185A550	Grade 5 Steel Square-Neck Carriage Bolt, Medium-Strength, 1/4"-20 Thread Size, 2" Long, PAINT BLACK	3
47	McMaster-Carr - 90126A029	Zinc-Plated Steel SAE Washer for 1/4" Screw Size, 0.281" ID, 0.625" OD	3
48	McMaster-Carr - 90675A029	Steel Locknut with External-Tooth Lock Washer, Zinc-Plated, 1/4"-20 Thread Size	3

ITEM NO.	PART NUMBER	DESCRIPTION	QTY.
49	603-00847-01	Speaker Bezel	1
50	500-00232-01 (45 CM)	Green Flexible LED Tape w/ FOAM	1

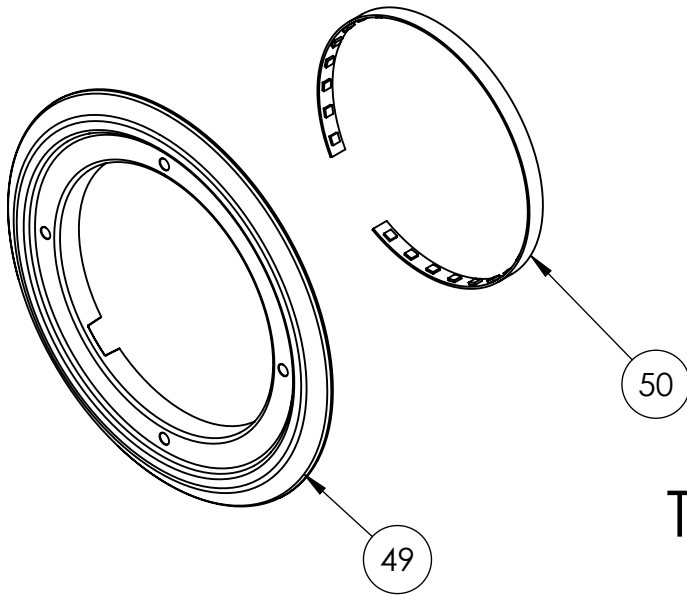

Teenage Mutant Ninja Turtles (55") Speaker Bezel Sub-Assembly



ITEM NO.	PART NUMBER	DESCRIPTION	QTY.
51	600-02042-01	Mini Marquee LED Panel	1
52	500-00162-01 (45 CM)	White Flexible LED Tape, w/ FOAM	3

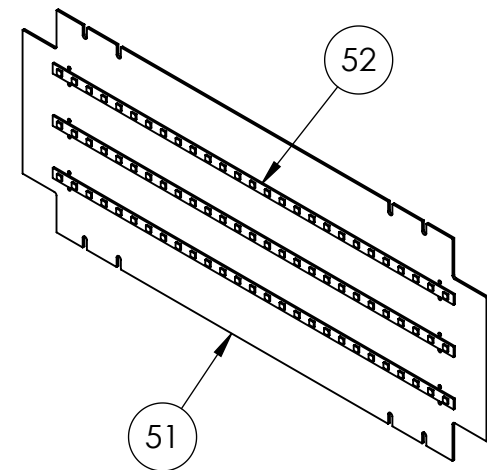

Teenage Mutant Ninja Turtles (55") Mini Marquee LED Sub-Assembly

ITEM NO.	PART NUMBER	DESCRIPTION	QTY.
53	600-01681-01	AC Electronics Plate	1
54	1832.3312	Rocker Switch (DPST): 250VAC, 16A (Marquardt)	1
55	T9-611P-6	Thermal Circuit Breaker: 240VAC, 6A, Snap-in, Fuseholder, 1-Pole (Schurter)	1
56	703W-00/08	AC Receptacle: 250V, 15A (Qualtek)	1
57	McMaster-Carr - 90272A146	Steel Phillips Rounded Head Screws, 6-32 Thread Size, 3/8" Long	2

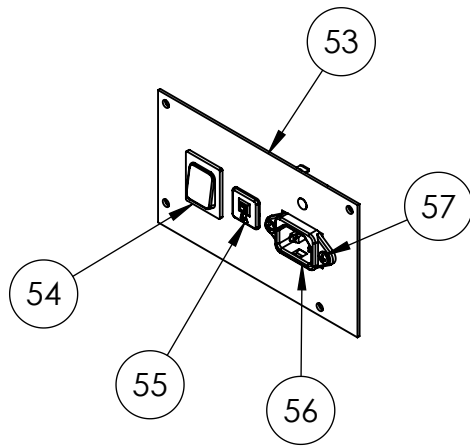

Teenage Mutant Ninja Turtles (55") AC Power Plate Assembly



ITEM NO.	PART NUMBER	DESCRIPTION	QTY.
58	600-02049-01	RIO2 Mounting Plate	1
59	500-00199-05	RIO2 PCB	1
60	500-00212-03	RIO2 Audio Amplifier PCB	1
61	500-00218-02	8x5 Diode Matrix PCB	1
62	McMaster-Carr - 90316A192	Stainless Steel Flanged Hex Head Screws with Slotted Drive, 8-32 Thread Size, 3/8" Long	12

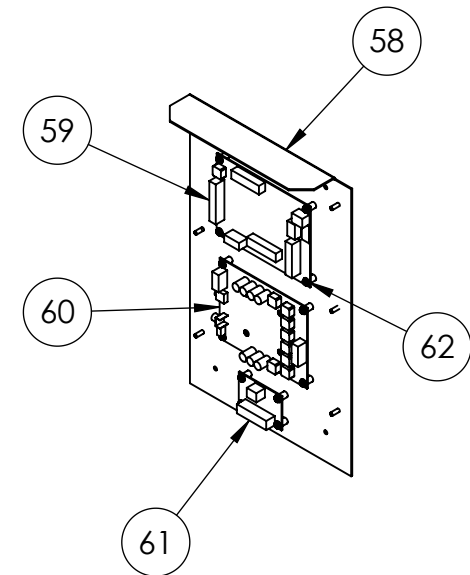

Teenage Mutant Ninja Turtles (55") RIO2 Assembly w/ Mounting Plate

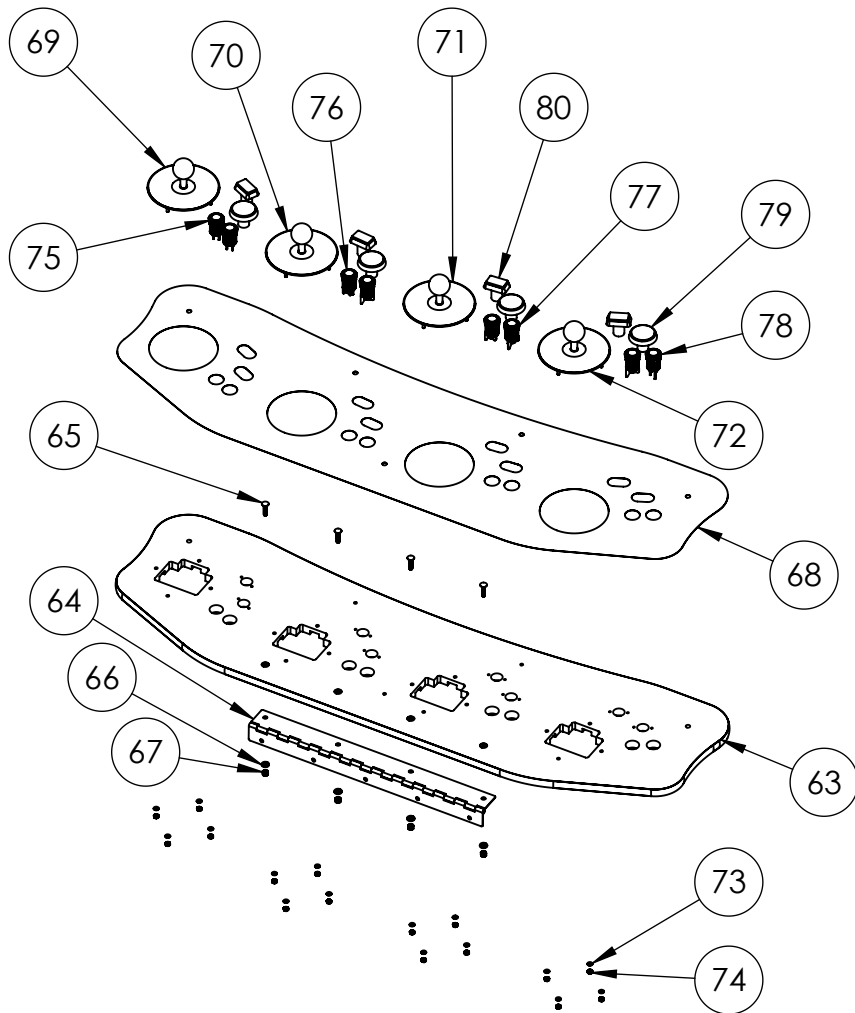

ITEM NO.	PART NUMBER	DESCRIPTION	QTY.
63	601-00806-01	Control Panel	1
64	600-02145-01	Control Panel Access Hinge	1
65	Special Order Hardware (not available at McMaster-Carr)	Flat Head Carriage Bolt, 1/4"-20 Thread Size, 1-1/4" Length	4
66	McMaster-Carr - 90126A029	Zinc-Plated Steel SAE Washer for 1/4" Screw Size, 0.281" ID, 0.625" OD	4
67	McMaster-Carr - 90640A129	Low-Strength Steel Nylon-Insert Locknut, Zinc-Plated, 1/4"-20 Thread Size	4
68	606-01339-01	Control Panel Decal	1
69	TMNT_Joystick_Assy - P1	P1 Joystick Sub-Assembly	1
70	TMNT_Joystick_Assy - P2	P2 Joystick Sub-Assembly	1
71	TMNT_Joystick_Assy - P3	P3 Joystick Sub-Assembly	1
72	TMNT_Joystick_Assy - P4	P4 Joystick Sub-Assembly	1
73	McMaster-Carr - 96765A125	Black-Oxide 18-8 Stainless Steel Washer for Number 10 Screw Size, 0.203" ID, 0.438" OD	16
74	McMaster-Carr - 90675A195	Steel Locknut with External-Tooth Lock Washer, Zinc-Plated, 10-32 Thread Size	16
75	702-00080-01	Blue LED Pushbutton (.187 Gold MS, 6V White LED)	2
76	702-00081-01	Orange LED Pushbutton (.187 Gold MS, 6V White LED)	2
77	702-00082-01	Purple LED Pushbutton (.187 Gold MS, 6V White LED)	2
78	702-00083-01	Red LED Pushbutton (.187 Gold MS, 6V White LED)	2
79	702-00078-01	Large Round GREEN IPB (.187 Gold MS, 6V White LED) w/ "TURTLE POWER" legend	4
80	702-00079-01	Large Rectangular WHITE IPB (.187 Gold MS, 6V White LED) w/ "START" legend	4

Teenage Mutant Ninja Turtles (55") Control Panel Sub-Assembly



ITEM NO.	PART NUMBER	DESCRIPTION	QTY.
81	800-00062-01	RGB LED Joystick w/ Clear Plastic Shaft Sleeve & Bubble Ball: JS-EPCM-BU-35-CW-CT (Jyuee Ang)	1
82	600-02047-01	Joystick Plate	1
83	McMaster-Carr - 90126A512	Zinc-Plated Steel SAE Washer for Number 8 Screw Size, 0.188" ID, 0.438" OD	4
84	McMaster-Carr - 90675A009	Steel Locknut with External-Tooth Lock Washer, Zinc-Plated, 8-32 Thread Size, 11/32" Wide	4
85	606-01342-01	TMNT - P1 Joystick Decal	1

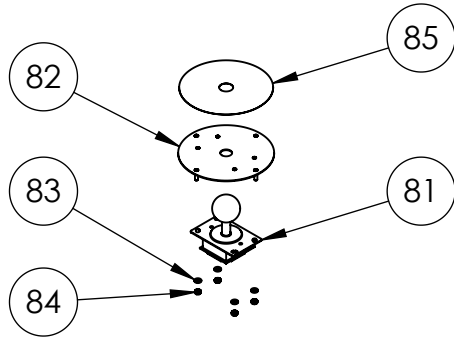

Teenage Mutant Ninja Turtles (55")
P1 Joystick Sub-Assembly

ITEM NO.	PART NUMBER	DESCRIPTION	QTY.
81	800-00062-01	RGB LED Joystick w/ Clear Plastic Shaft Sleeve & Bubble Ball: JS-EPCM-BU-35-CW-CT (Jyuee Ang)	1
82	600-02047-01	Joystick Plate	1
83	McMaster-Carr - 90126A512	Zinc-Plated Steel SAE Washer for Number 8 Screw Size, 0.188" ID, 0.438" OD	4
84	McMaster-Carr - 90675A009	Steel Locknut with External-Tooth Lock Washer, Zinc-Plated, 8-32 Thread Size, 11/32" Wide	4
86	606-01343-01	TMNT - P2 Joystick Decal	1

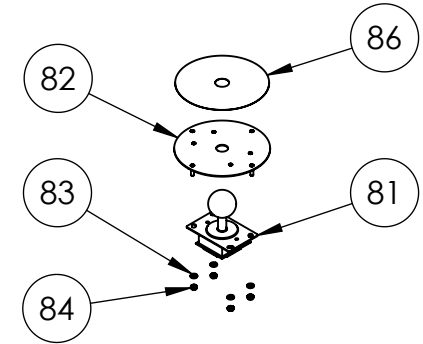

Teenage Mutant Ninja Turtles (55")
P2 Joystick Sub-Assembly

ITEM NO.	PART NUMBER	DESCRIPTION	QTY.
81	800-00062-01	RGB LED Joystick w/ Clear Plastic Shaft Sleeve & Bubble Ball: JS-EPCM-BU-35-CW-CT (Jyuee Ang)	1
82	600-02047-01	Joystick Plate	1
83	McMaster-Carr - 90126A512	Zinc-Plated Steel SAE Washer for Number 8 Screw Size, 0.188" ID, 0.438" OD	4
84	McMaster-Carr - 90675A009	Steel Locknut with External-Tooth Lock Washer, Zinc-Plated, 8-32 Thread Size, 11/32" Wide	4
87	606-01344-01	TMNT - P3 Joystick Decal	1

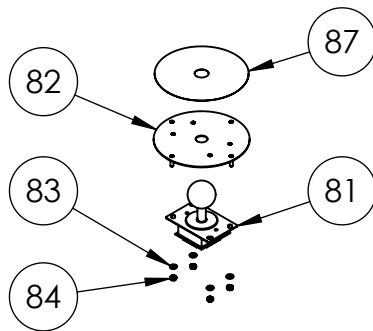

Teenage Mutant Ninja Turtles (55")
P3 Joystick Sub-Assembly

ITEM NO.	PART NUMBER	DESCRIPTION	QTY.
81	800-00062-01	RGB LED Joystick w/ Clear Plastic Shaft Sleeve & Bubble Ball: JS-EPCM-BU-35-CW-CT (Jyuee Ang)	1
82	600-02047-01	Joystick Plate	1
83	McMaster-Carr - 90126A512	Zinc-Plated Steel SAE Washer for Number 8 Screw Size, 0.188" ID, 0.438" OD	4
84	McMaster-Carr - 90675A009	Steel Locknut with External-Tooth Lock Washer, Zinc-Plated, 8-32 Thread Size, 11/32" Wide	4
88	606-01345-01	TMNT - P4 Joystick Decal	1

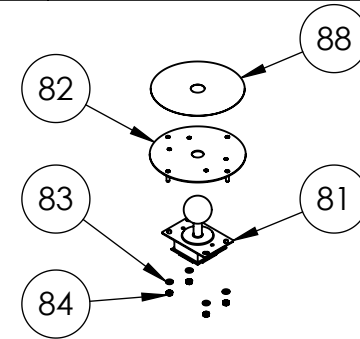

Teenage Mutant Ninja Turtles (55")
P4 Joystick Sub-Assembly

ITEM NO.	PART NUMBER	DESCRIPTION	QTY.
89	600-02144-01	Marquee LED Bracket	1
90	500-00162-01 (55 CM)	White Flexible LED Tape, w/ FOAM	12
91	600-02057-01	Marquee Front Light Lens PETG	1
92	600-02053-01	Marquee Light Lens PETG	1
93	McMaster-Carr - 91249A194	Black-Oxide 18-8 Stainless Steel Pan Head Phillips Screws, 8-32 Thread, 1/2" Long	14

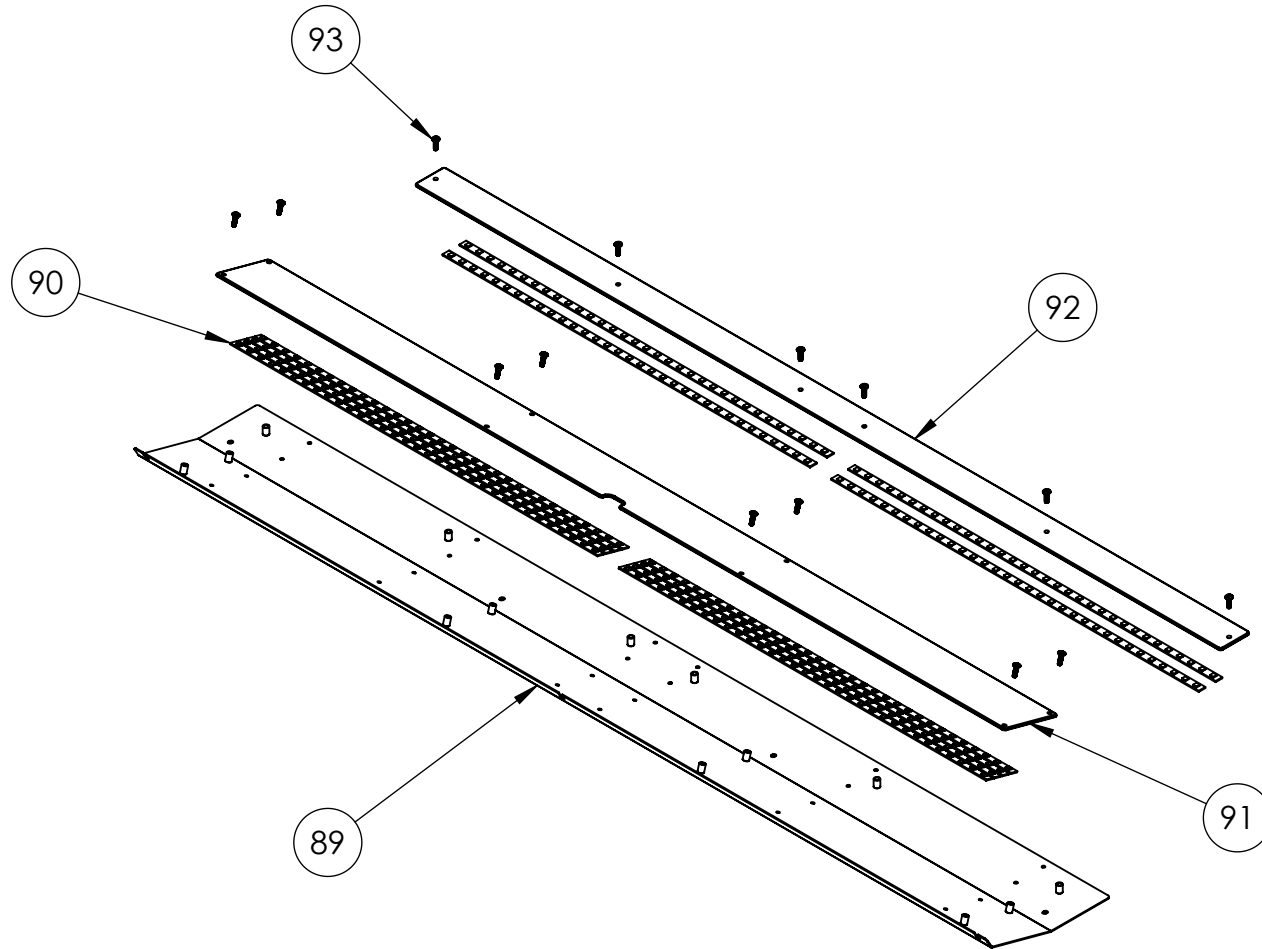

Teenage Mutant Ninja Turtles (55")
Marquee Uplighting LED Sub-Assembly



ITEM NO.	PART NUMBER	DESCRIPTION	QTY.
94	601-00808-01	Lower Back Door	1
95	800-00001-00	120mm Wire Fan Guard	2
96	McMaster-Carr - 90272A201	Steel Phillips Rounded Head Screws, 8-32 Thread Size, 1-1/4" Long	8
97	McMaster-Carr - 90126A009	Zinc-Plated Steel SAE Washer for Number 8 Screw Size, 0.188" ID, 0.438" OD	8
98	McMaster-Carr - 90631A009	Low-Strength Steel Nylon-Insert Locknut, Zinc-Plated, 8-32 Thread Size	8
99	600-00043-01	Lock Retainer Plate	1
100	McMaster-Carr - 90054A196	Flanged Hex Head Screws for Sheef Metal, Zinc-Plated Steel, Number 8 Size, 5/8" Long	3
101	150-00001-00	Standard Door Lock Assembly (for 3/4" Panels)	1

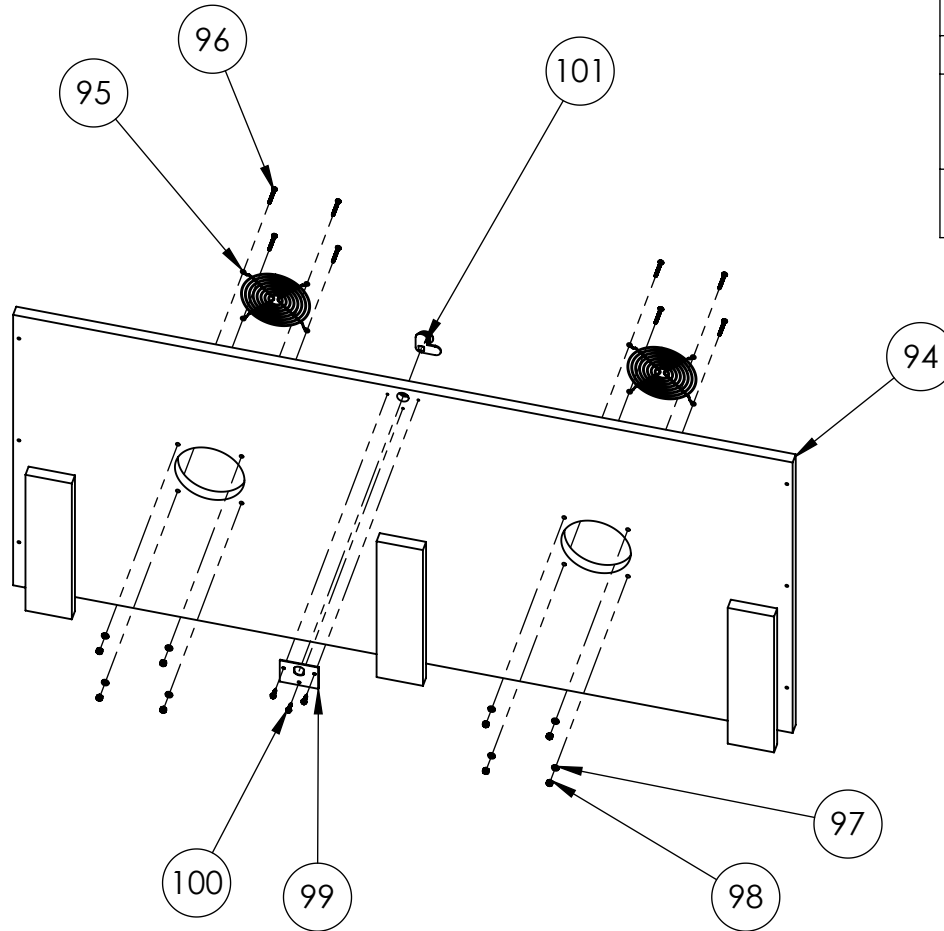

Teenage Mutant Ninja Turtles (55")
Lower Back Door Sub-Assembly



ITEM NO.	PART NUMBER	DESCRIPTION	QTY.
102	601-00809-01	Upper Back Door	1
103	800-00001-00	120mm Wire Fan Guard	2
104	McMaster-Carr - 90272A201	Steel Phillips Rounded Head Screws, 8-32 Thread Size, 1-1/4" Long	8
105	McMaster-Carr - 90126A009	Zinc-Plated Steel SAE Washer for Number 8 Screw Size, 0.188" ID, 0.438" OD	8
106	McMaster-Carr - 90631A009	Low-Strength Steel Nylon-Insert Locknut, Zinc-Plated, 8-32 Thread Size	8
107	600-00043-01	Lock Retainer Plate	1
108	McMaster-Carr - 90054A196	Flanged Hex Head Screws for Sheet Metal, Zinc-Plated Steel, Number 8 Size, 5/8" Long	3
109	150-00001-00	Standard Door Lock Assembly (for 3/4" Panels)	1

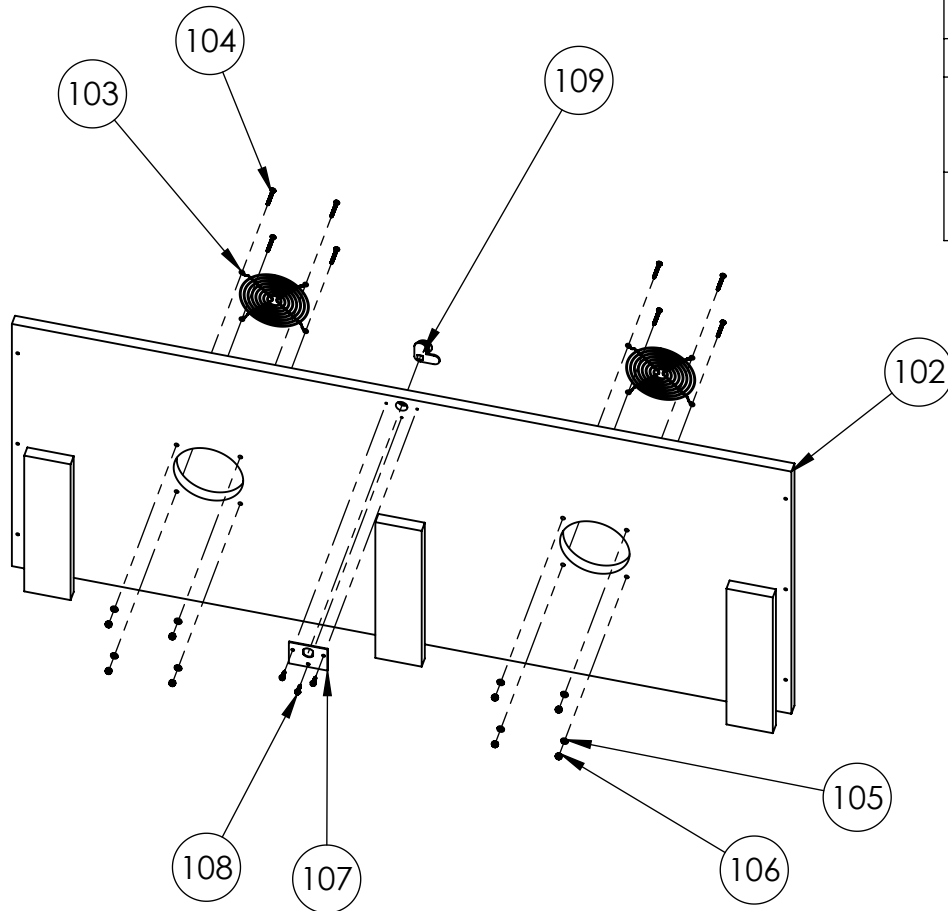

Teenage Mutant Ninja Turtles (55")
Upper Back Door Sub-Assembly



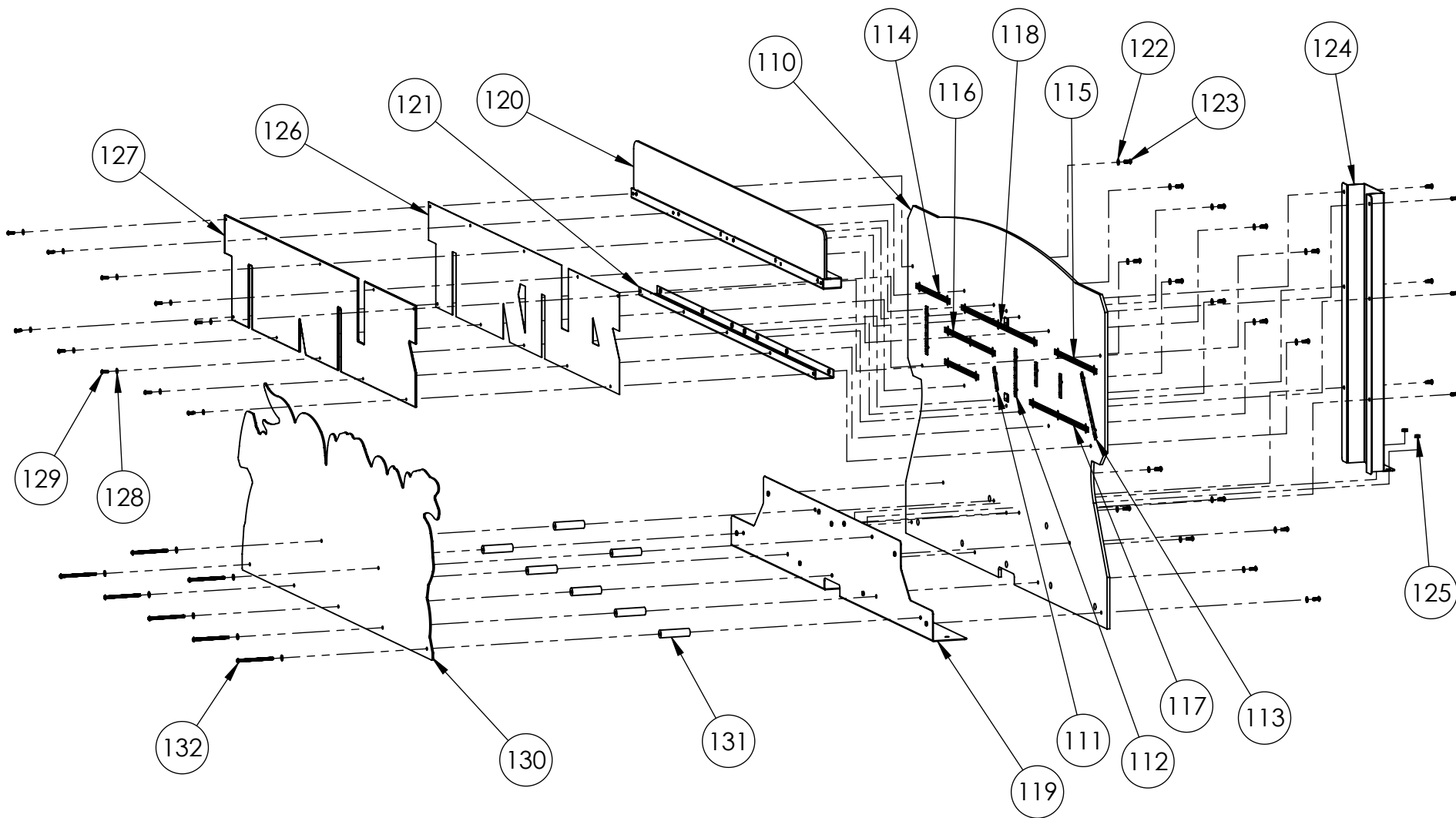

Teenage Mutant Ninja Turtles (55")
 Marquee Sub-Assembly
 (BOM on next page)





Teenage Mutant Ninja Turtles (55") - Marquee Sub-Assembly: BOM

ITEM NO.	PART NUMBER	DESCRIPTION	QTY.
110	606-01470-01	Printed Marquee Backboard	1
111	500-00162-01 (5 CM)	White Flexible LED Tape, w/ FOAM	3
112	500-00162-01 (10 CM)	White Flexible LED Tape, w/ FOAM	2
113	500-00162-01 (15 CM)	White Flexible LED Tape, w/ FOAM	1
114	500-00162-01 (20 CM)	White Flexible LED Tape, w/ FOAM	2
115	500-00162-01 (25 CM)	White Flexible LED Tape, w/ FOAM	1
116	500-00162-01 (30 CM)	White Flexible LED Tape, w/ FOAM	1
117	500-00162-01 (35 CM)	White Flexible LED Tape, w/ FOAM	1
118	500-00162-01 (45 CM)	White Flexible LED Tape, w/ FOAM	1
119	600-02051-01	Marquee Mounting Bracket	1
120	TMNT_Logo_Assy	Acrylic Logo Sub-Assembly	1
121	600-02147-01	Lower Logo Bracket	1
122	McMaster-Carr - 96765A125	Black-Oxide 18-8 Stainless Steel Washer for Number 10 Screw Size, 0.203" ID, 0.438" OD	24
123	McMaster-Carr - 96075A187	Alloy Steel Tamper-Resistant Button Head Torx Screws, 10-32 Thread, 1/2" Long	23
124	600-02149-01	Marquee Rear Support Bracket	1
125	McMaster-Carr - 90675A195	Steel Locknut with External-Tooth Lock Washer, Zinc-Plated, 10-32 Thread Size	2
126	606-01331-01	Logo Translite	1
127	600-02148-01	Logo Lens PETG	1
128	McMaster-Carr -96765A120	Black-Oxide 18-8 Stainless Steel Washer for Number 8 Screw Size, 0.172" ID, 0.375" OD	10
129	McMaster-Carr - 96075A139	Black-Oxide Alloy Steel Tamper-Resistant Torx Rounded Head Screws, 8-32 Thread Size, 1/2" Long	10
130	606-01471-01	Printed Turtles Panel	1
131	McMaster-Carr - 94639A611	Nylon Unthreaded Spacer, 5/8" OD, 2-1/2" Length, for Number 10 Screw Size	7
132	McMaster-Carr - 91255A030	Button Head Hex Drive Screw, Black-Oxide Alloy Steel, 10-32 Thread, 3" Long	7

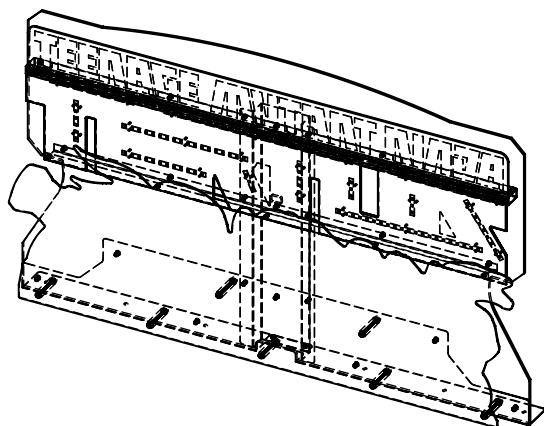

ITEM NO.	PART NUMBER	DESCRIPTION	QTY.
133	600-02052-01	Logo Support Bracket	1
134	500-00162-01 (55 CM)	White Flexible LED Tape, w/ FOAM	2
135	600-02063-01	Logo Front Blocker Panel	2
136	603-00848-01	Logo Acrylic	1
137	600-02146-01	Logo Blocker Bracket	1
138	McMaster-Carr - 90675A195	Steel Locknut with External-Tooth Lock Washer, Zinc-Plated, 10-32 Thread Size	6

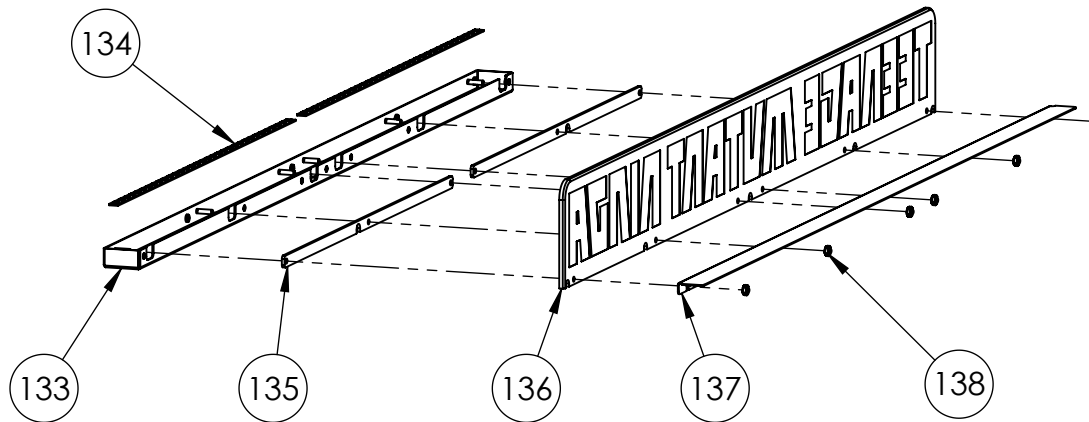

Teenage Mutant Ninja Turtles (55") Acrylic Logo Sub-Assembly



ITEM NO.	PART NUMBER	DESCRIPTION	QTY.
139	606-01333-01	Right Side Panel Decal	1
140	606-01334-01	Left Side Panel Decal	1
141	606-01335-01	Front Panel Decal	1
142	606-01336-01	Front Right Decal	1
143	606-01337-01	Front Left Decal	1
144	606-01348-01	Speaker Panel Decal	1

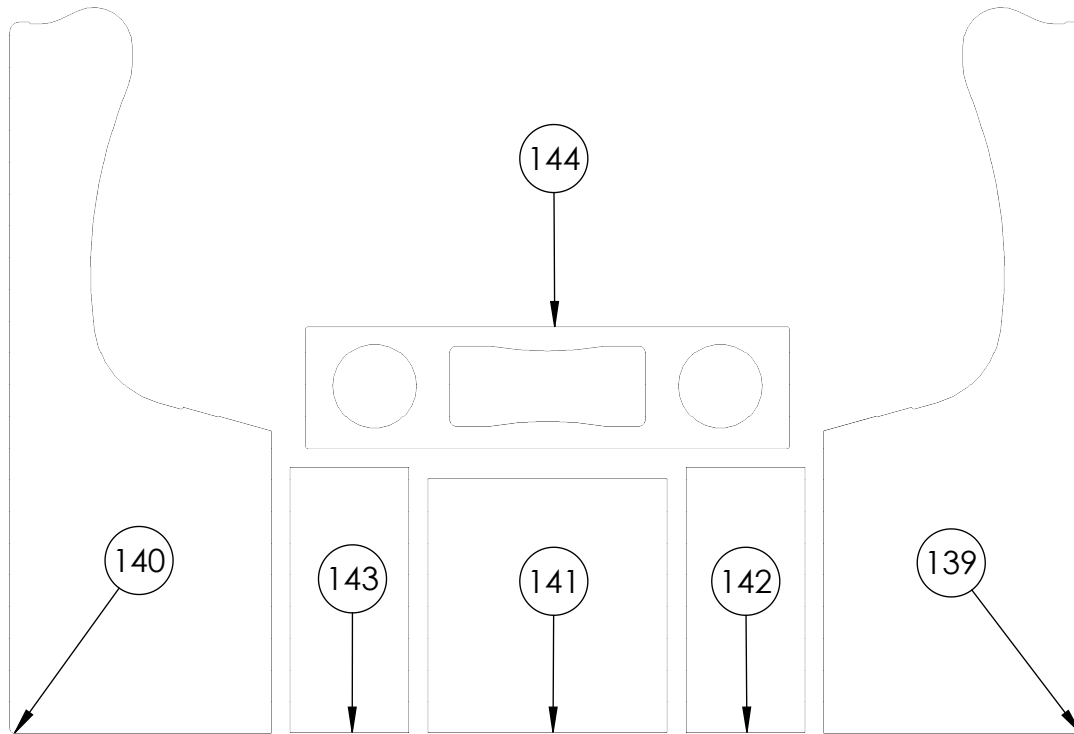

Teenage Mutant Ninja Turtles (55") Cabinet Decals



Teenage Mutant Ninja Turtles™

**NOTE: PLEASE CHECK FOR THE LATEST VERSION OF GAME SOFTWARE AND MANUAL AT
WWW.RAWTHRILLS.COM**